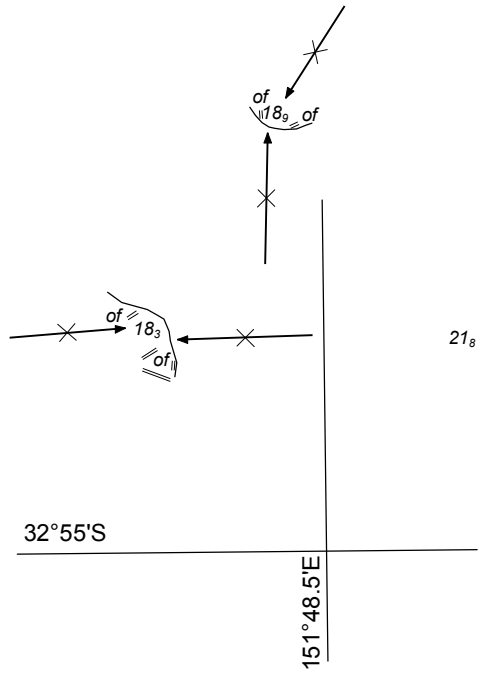
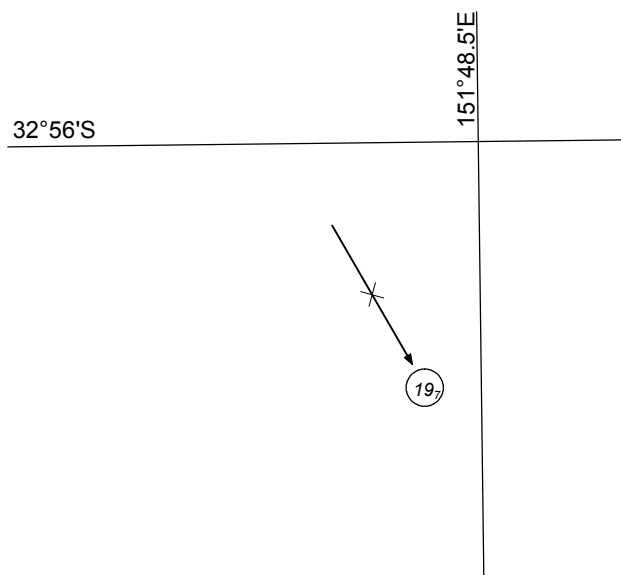

7₆

21

25₂

28

Previous Notice 271/2018

NTM 551/2018



Australian Government
Department of Defence

AUS 208

© Commonwealth of Australia 2018

148°08'E

19°44'S

INSERT
NOTE

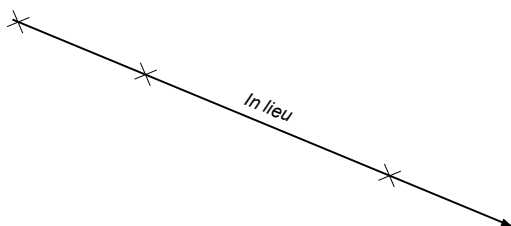

35

of

31

33

NE 1/6/2018

NTM 552/2018



Australian Government
Department of Defence

AUS 255

© Commonwealth of Australia 2018

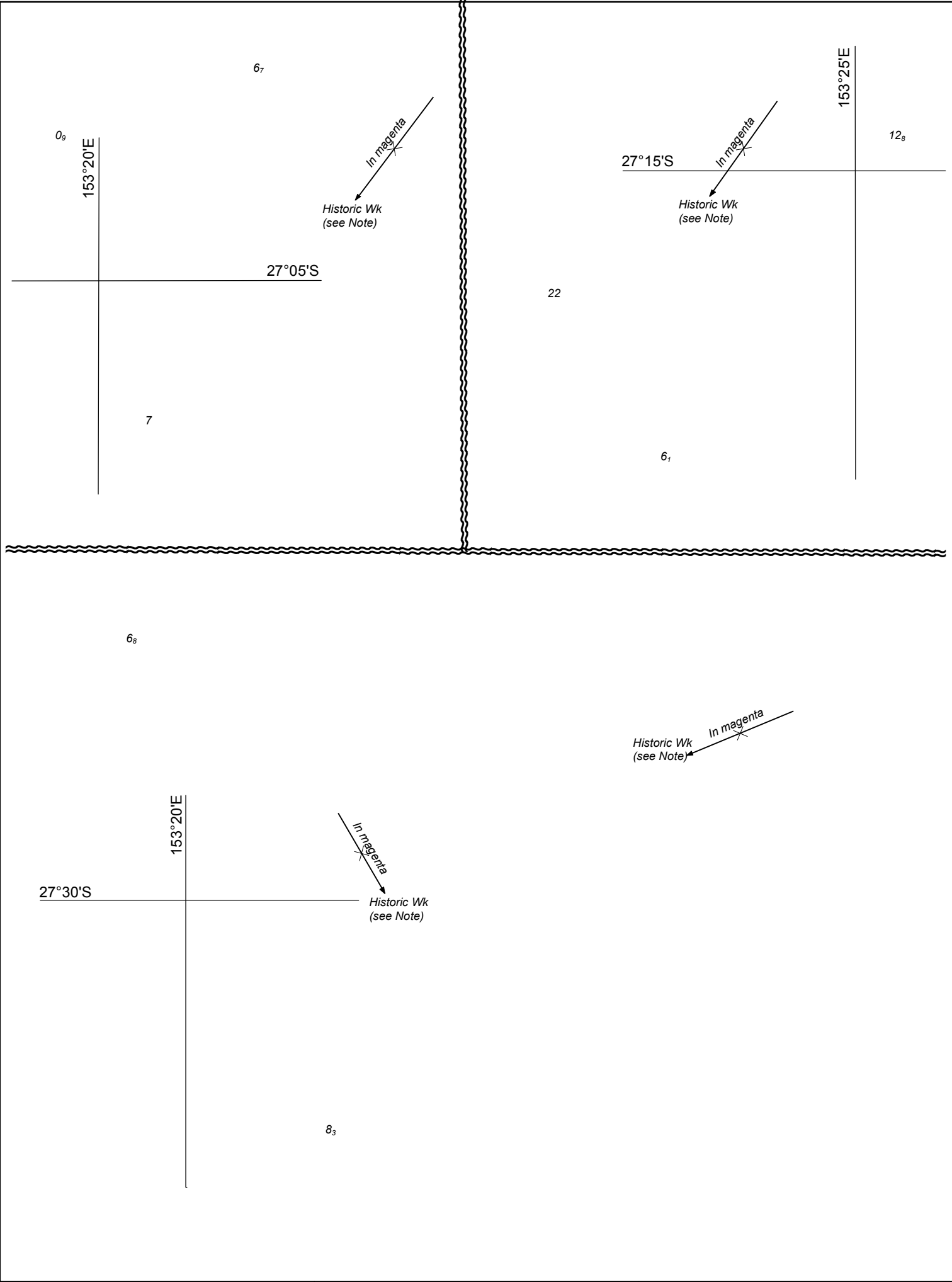

146°40'E

19°10'S

146°50'E

In magenta

Historic Wk
(see Note)

4₂

7

Depths are in metres

19°15'S

INSERT
NOTE

Previous Notice NE 04/07/2014

NTM 553/2018



Australian Government
Department of Defence

AUS 256

© Commonwealth of Australia 2018

20₁

153°30'E

27°15'S

In magenta
Historic Wk
(see Note)

6₄

In magenta
Historic Wk
(see Note)

In magenta
Historic Wk
(see Note)

Previous Notice 191/2018

NTM 553/2018



AUS 814

© Commonwealth of Australia 2018

of
//

7

21°00'S

149°15'E

14

Previous Notice NE 18/7/2014

NTM 554/2018



AUS 249

© Commonwealth of Australia 2018

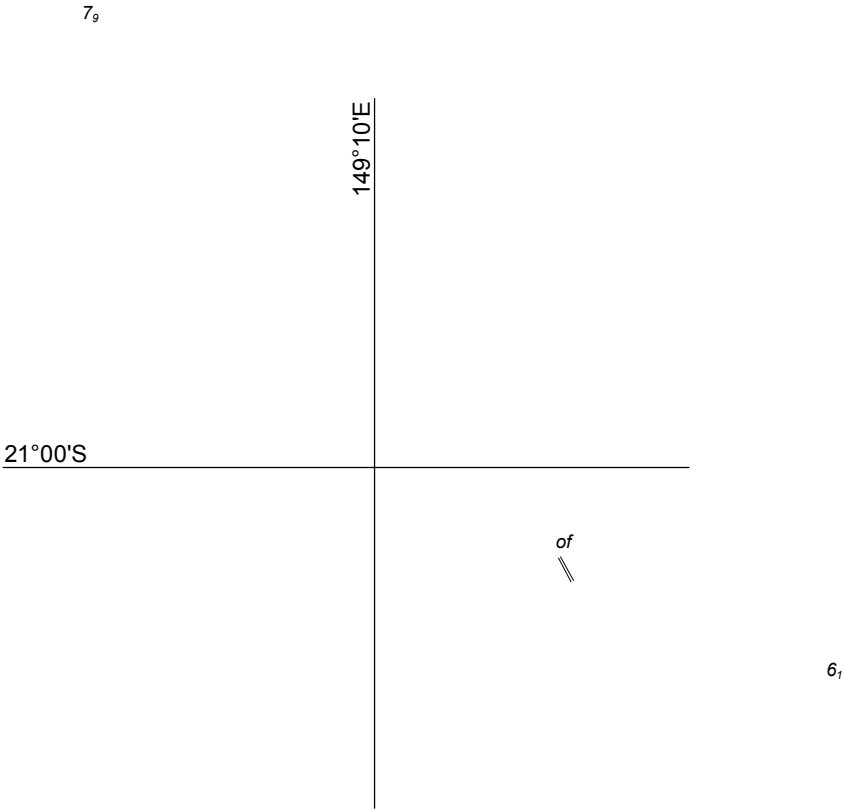

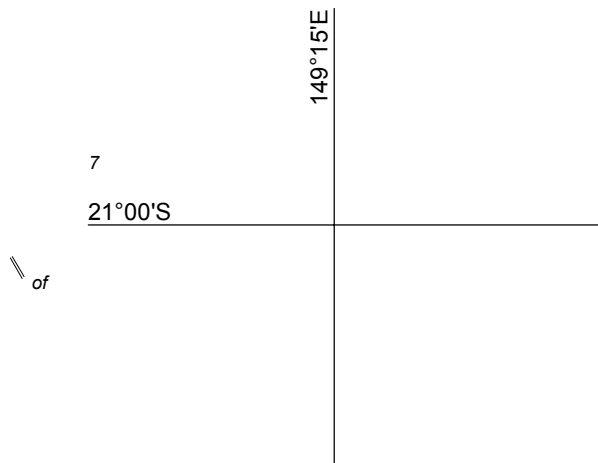

14



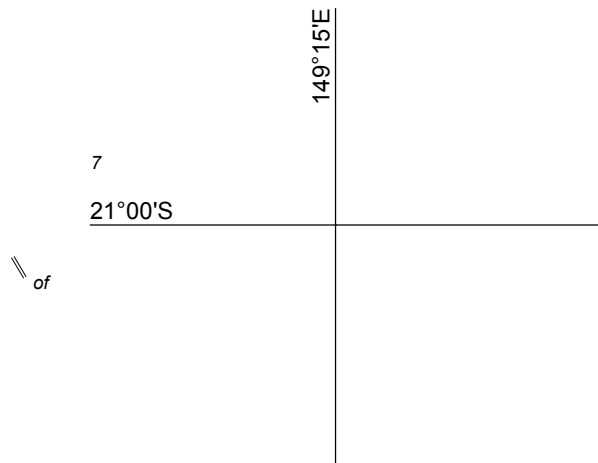

14



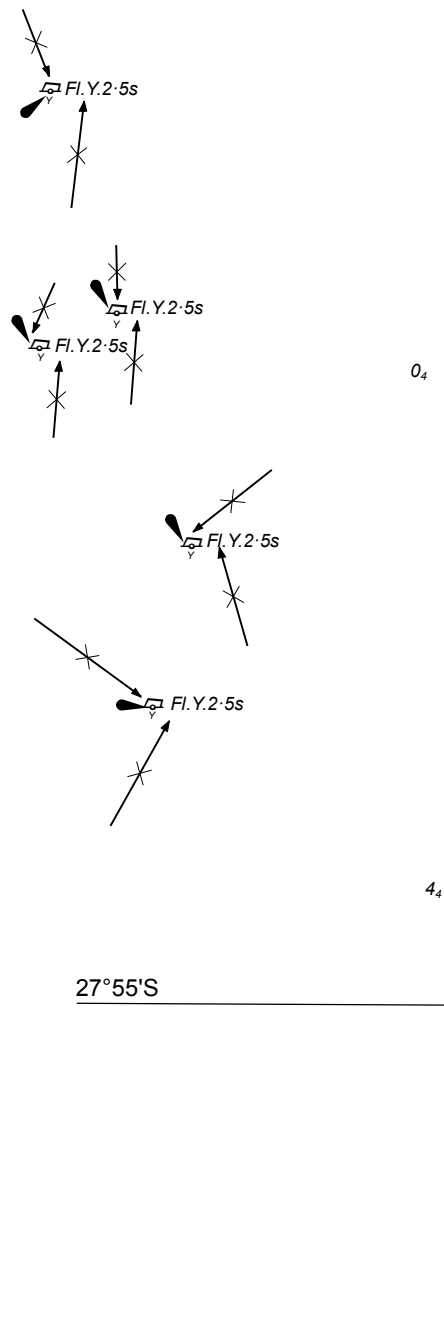

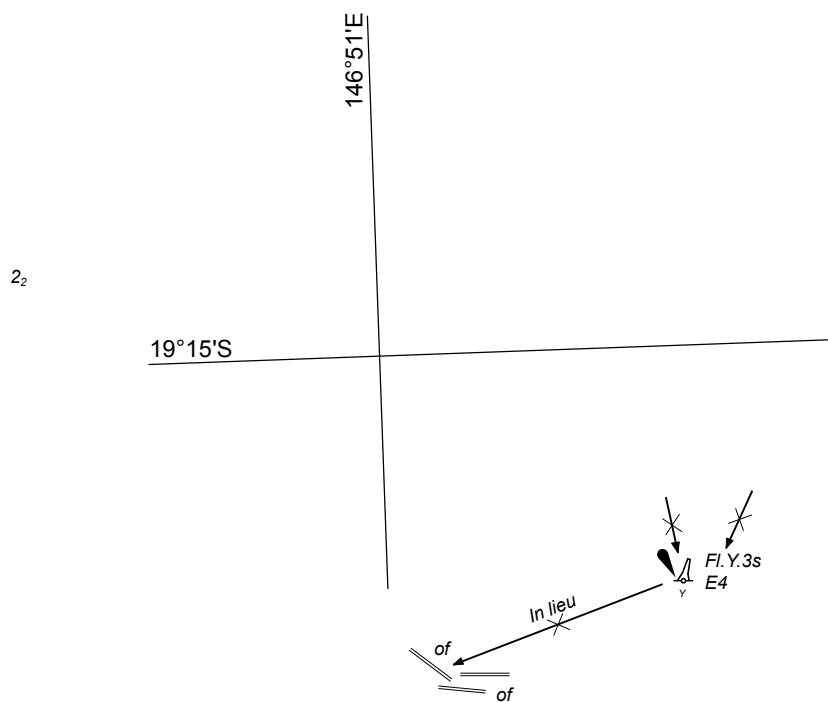
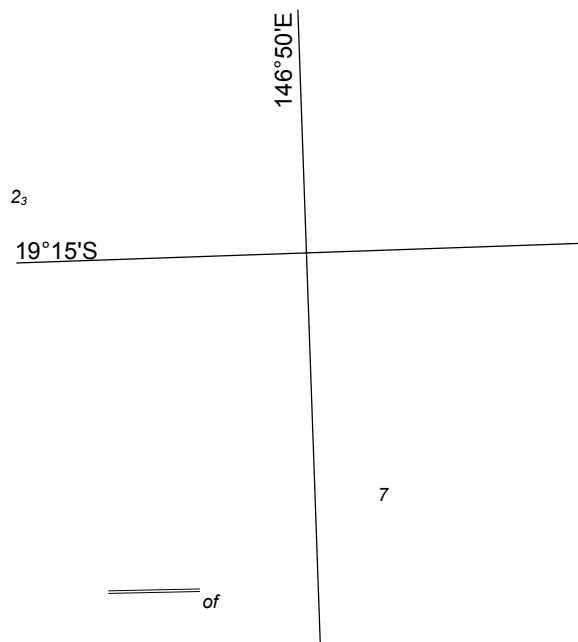

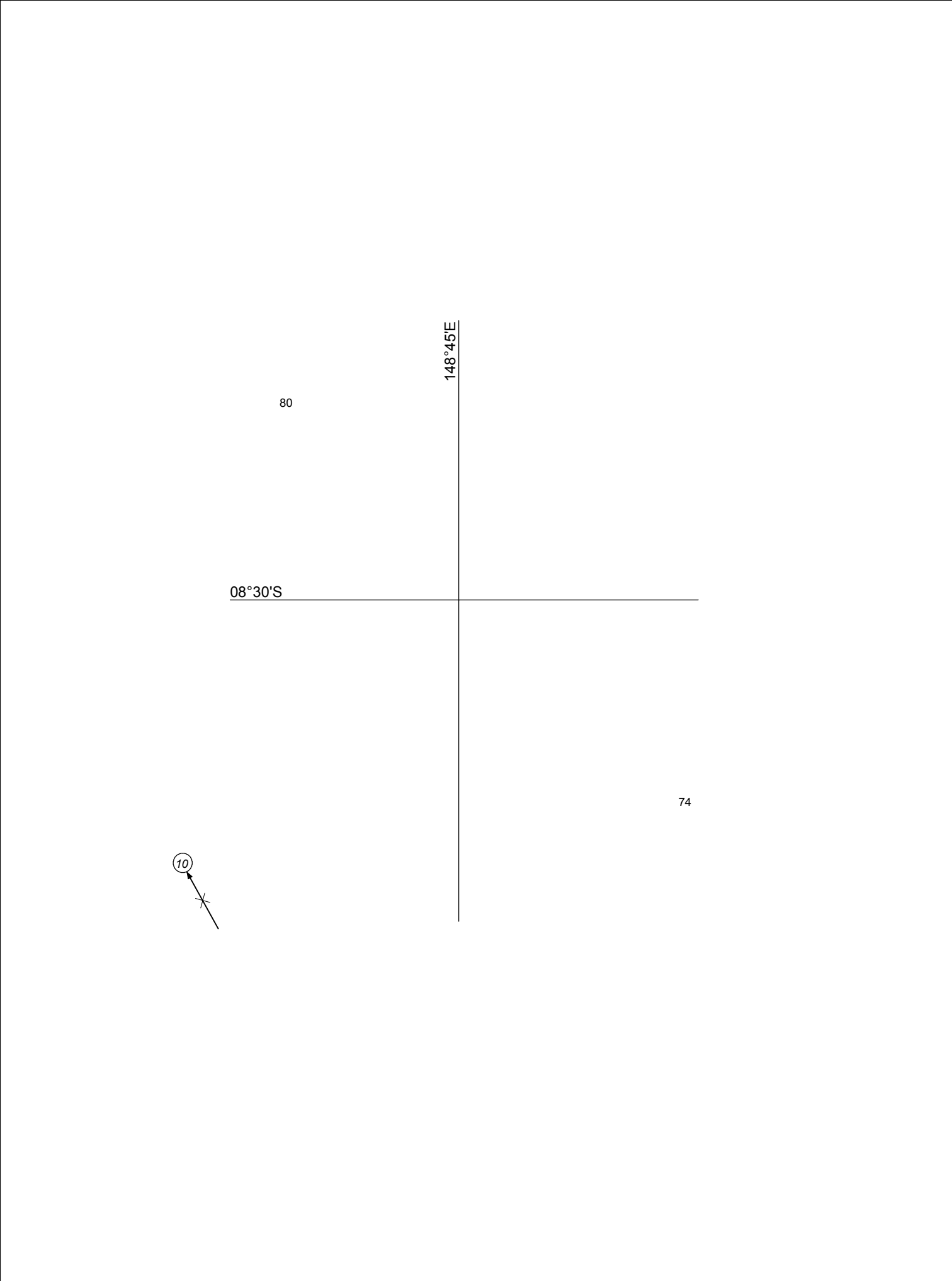

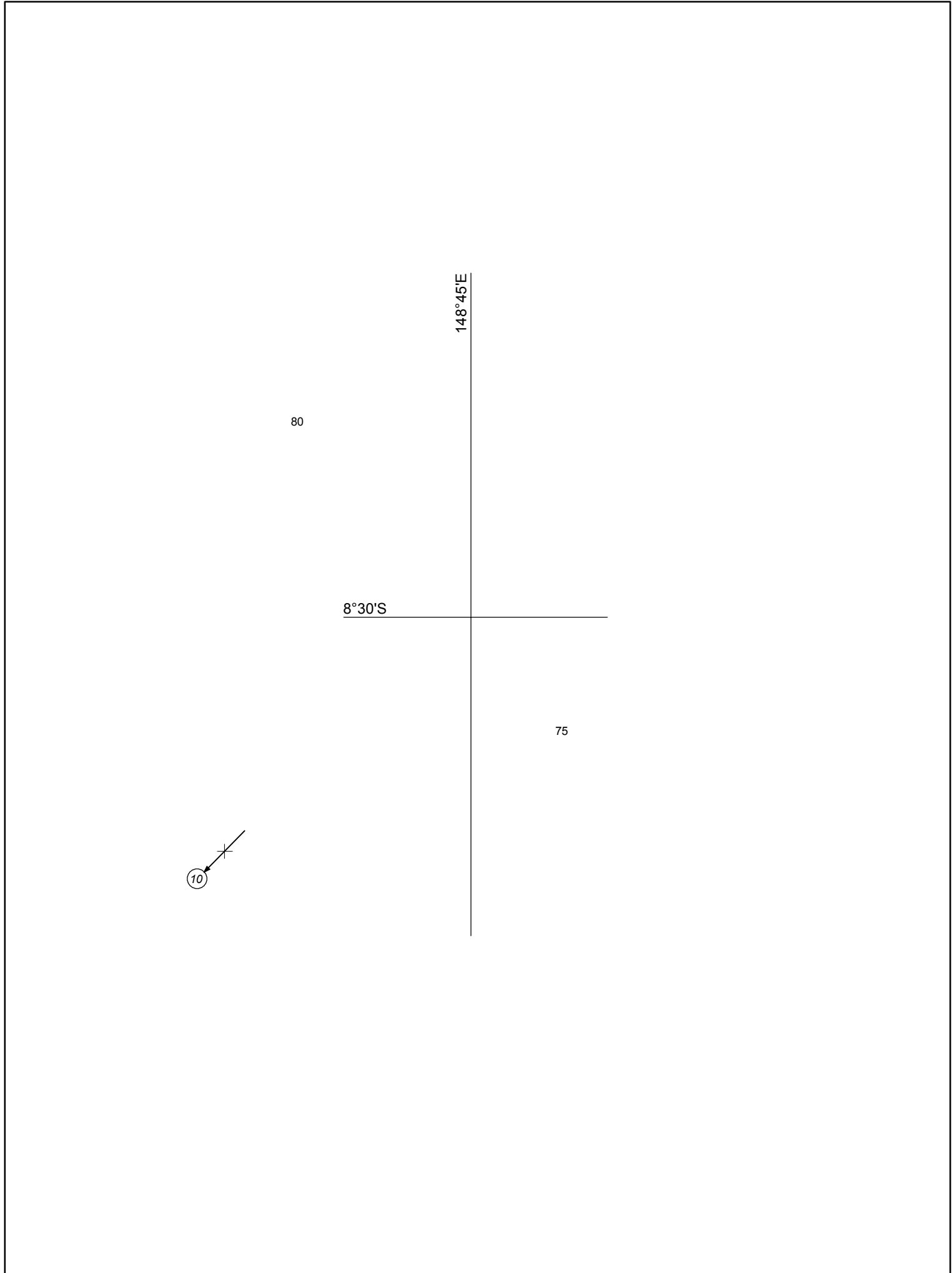

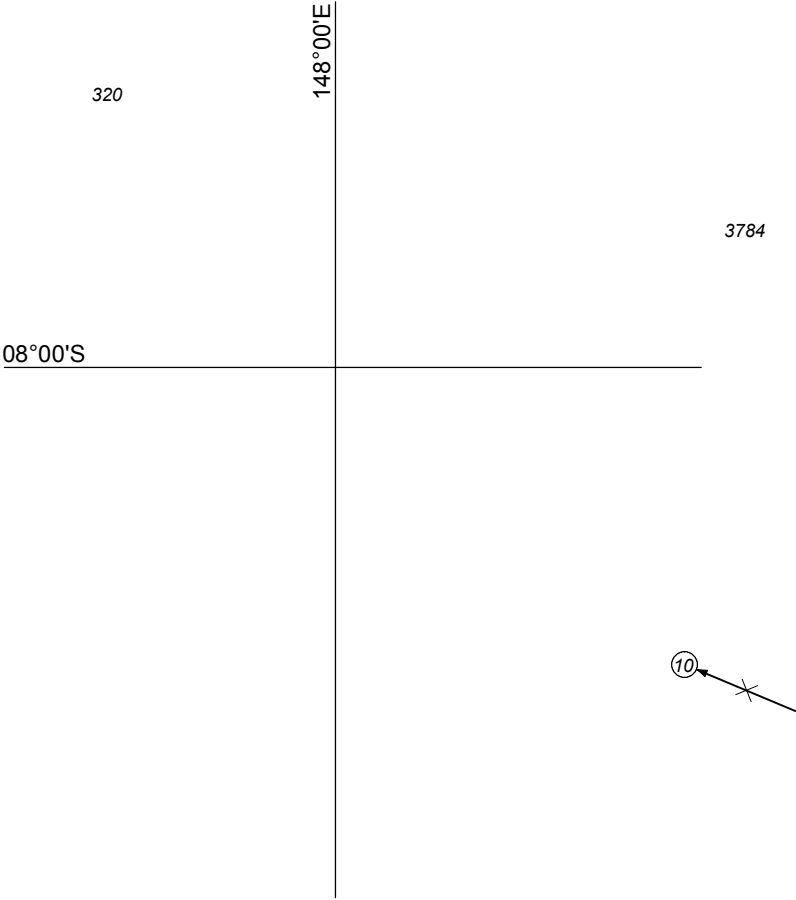

4185

08°00'S

150°00'E

402



Previous Notice NE 22/9/2017

NTM 558/2018



AUS 4621
(INT 621)

© Commonwealth of Australia 2018

563

12°30'S

123°00'E

592

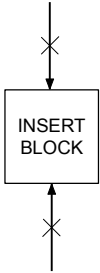

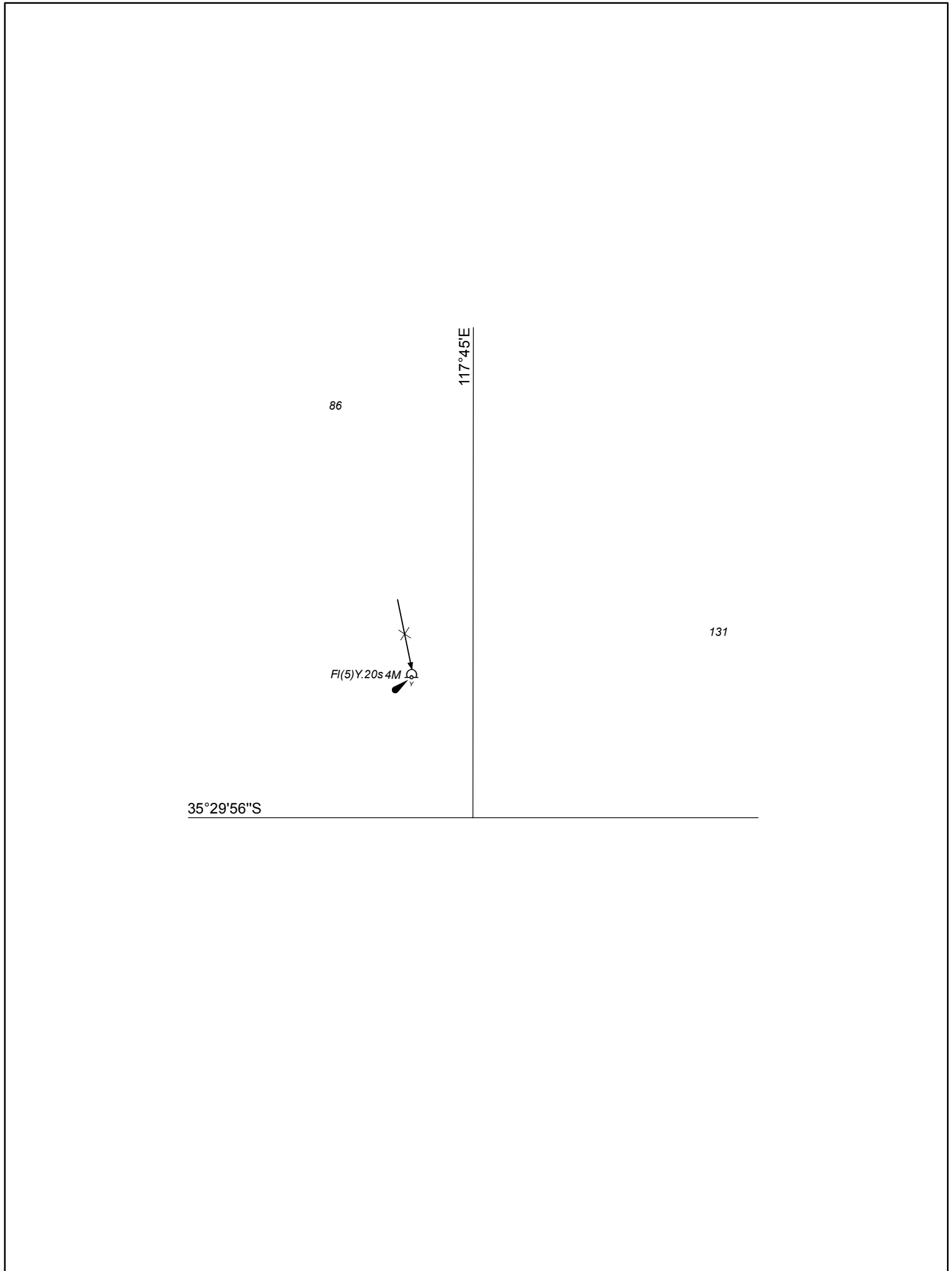

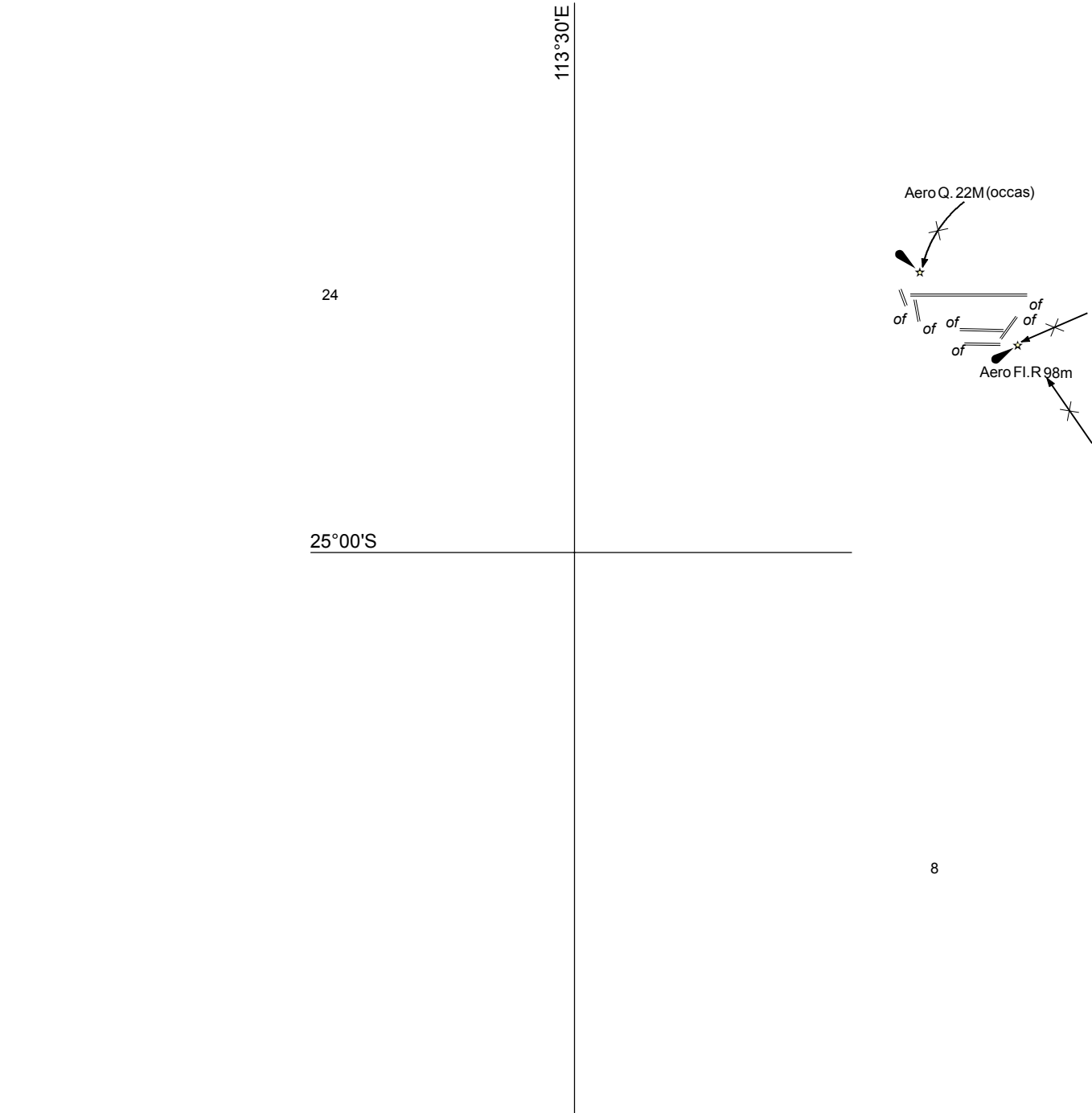

Aero Q. 22M *In lieu*

114°00'E

26°00'S

84

94

Previous Notice NE 13/7/2018

NTM 561/2018



AUS 4725
(INT 725)

© Commonwealth of Australia 2018

3₇

28°11'S

114°15'E

In magenta

Historic Wk
(see Note)

1₆

12

PLAN: PORT GREGORY

Previous Notice 650/2017

NTM 562/2018



Australian Government
Department of Defence

AUS 84

© Commonwealth of Australia 2018

484

519

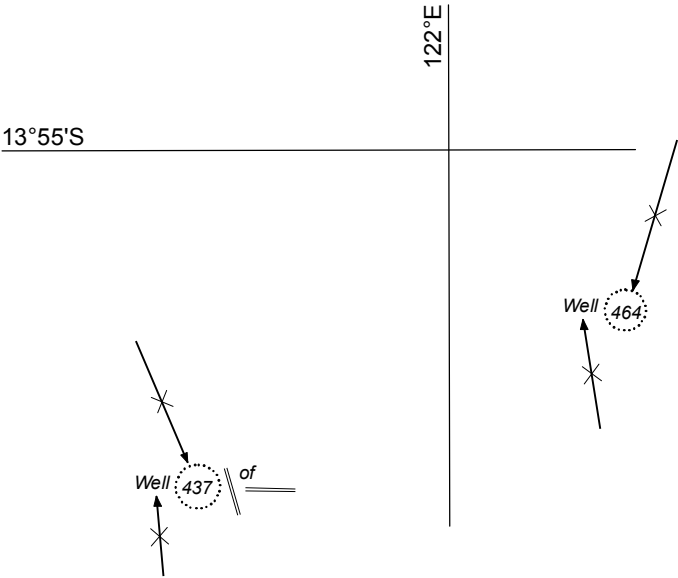

460



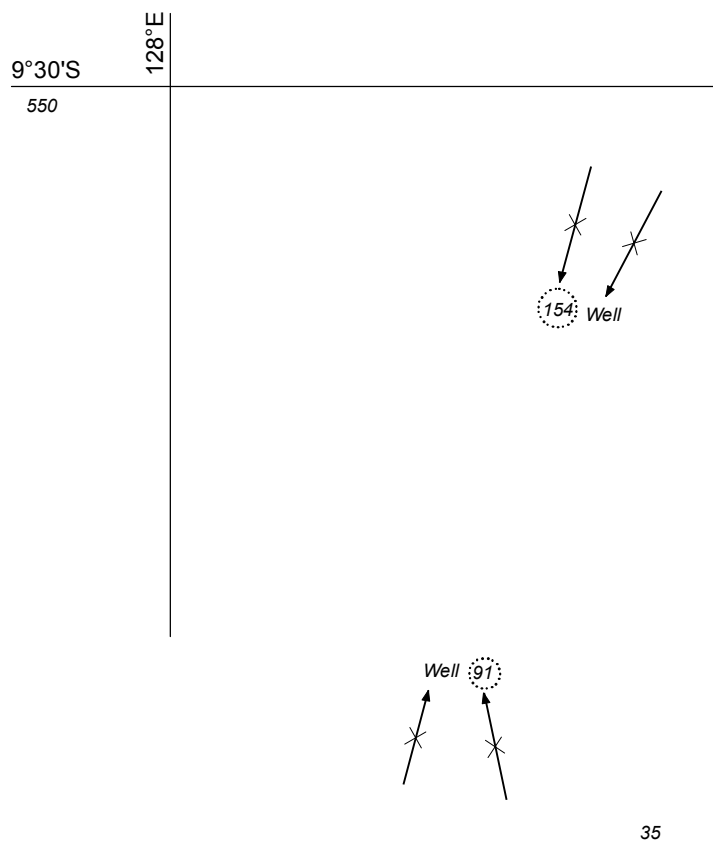

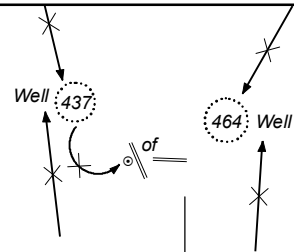

14°S

31

122°E

708



370

Previous Notice 1201/2016

NTM 563/2018



AUS 322

© Commonwealth of Australia 2018

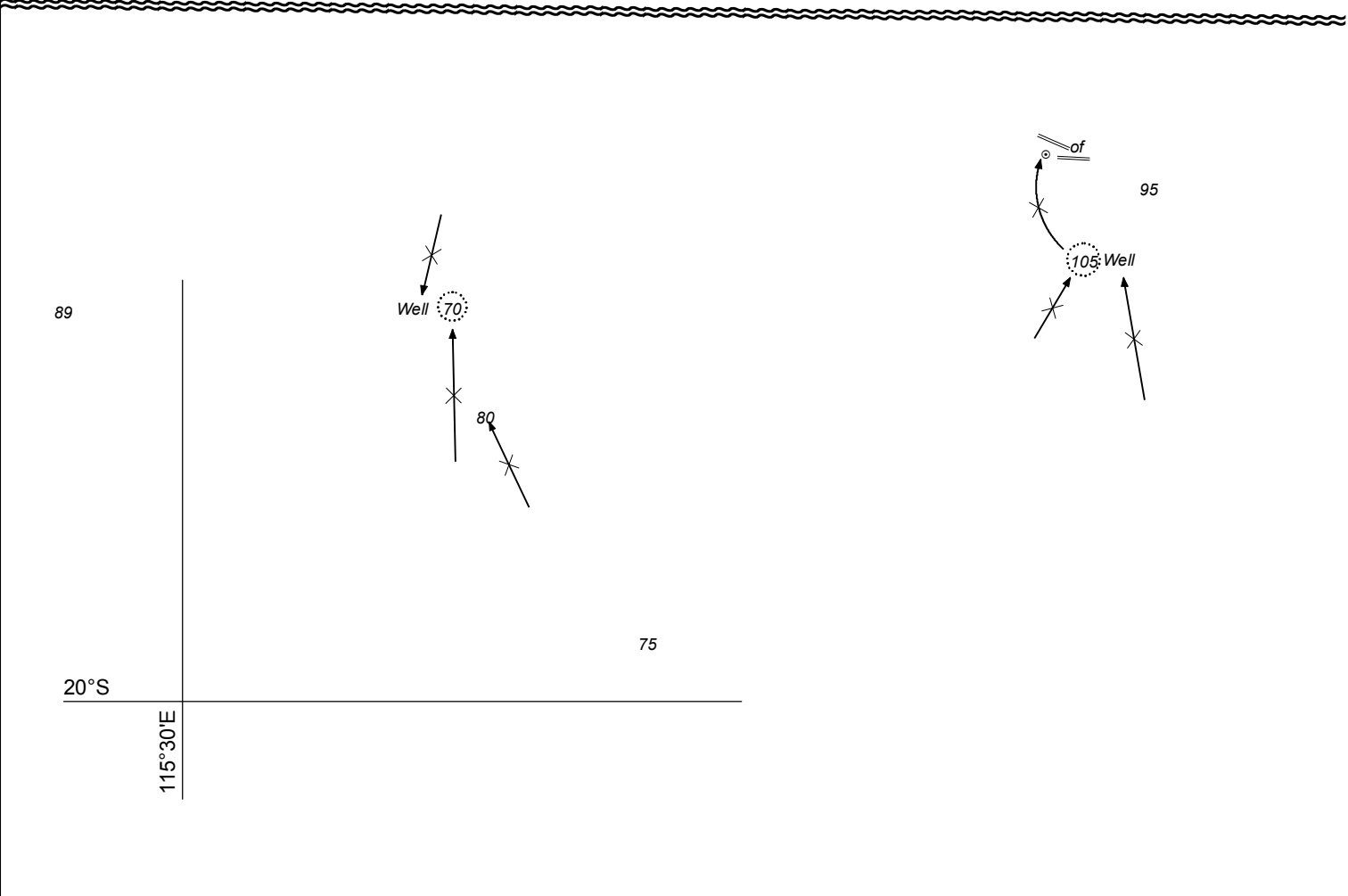
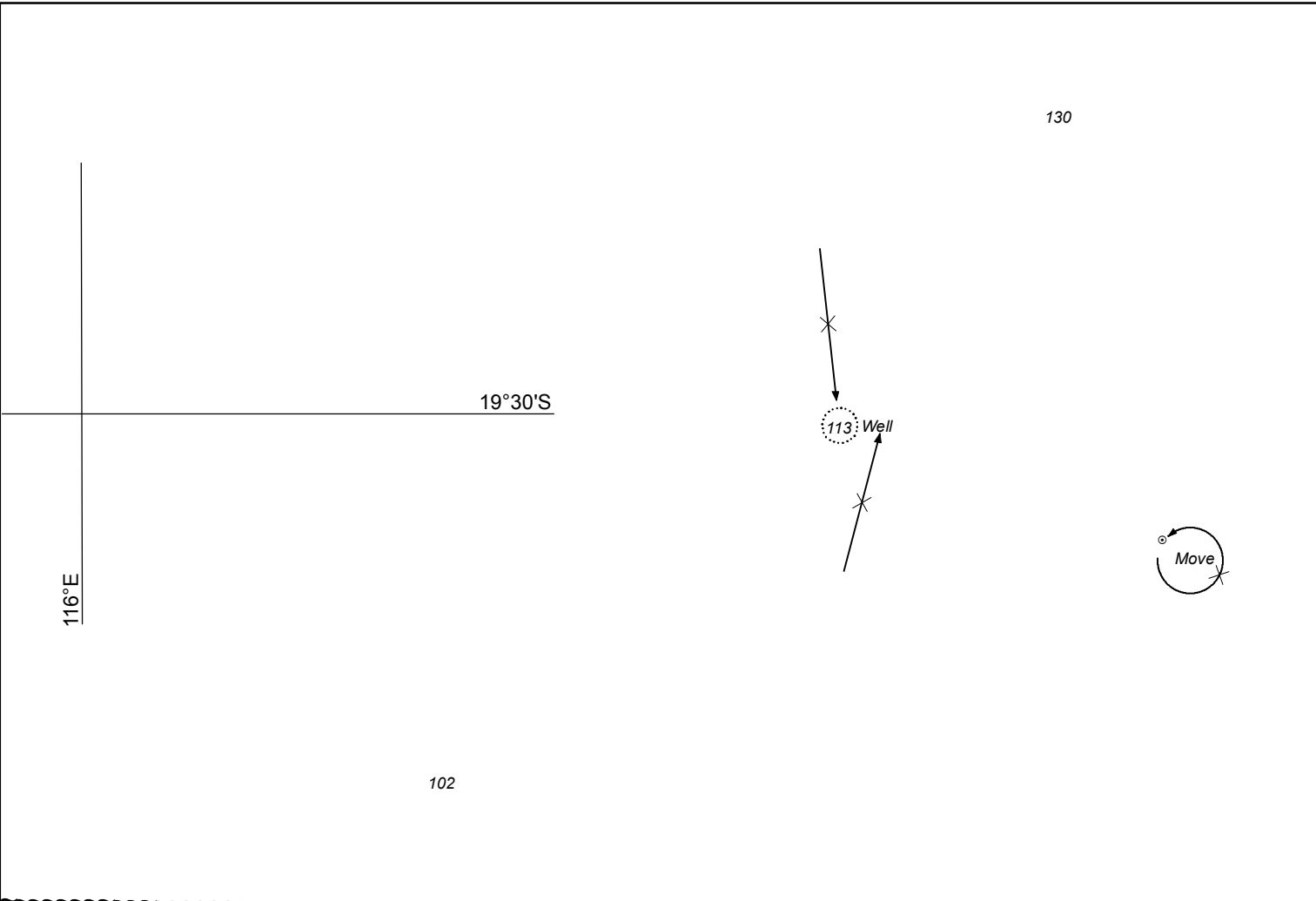

131

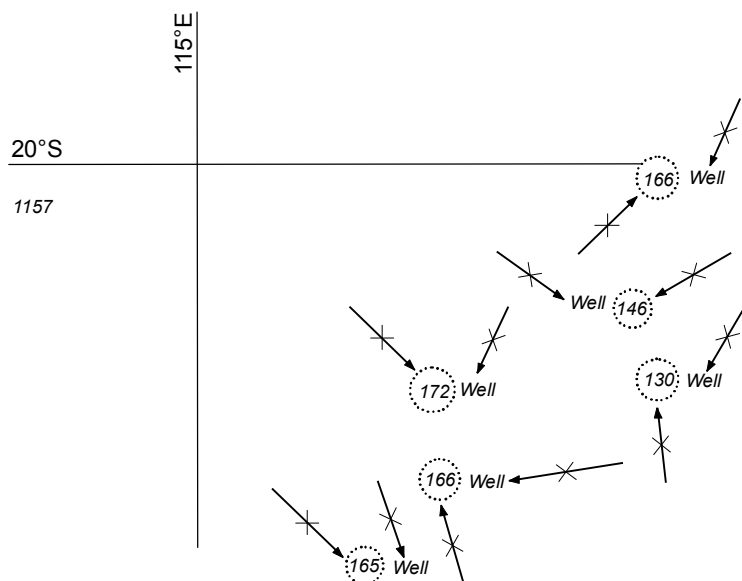

51

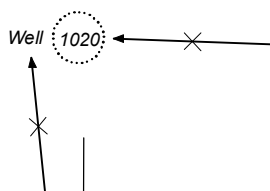

906

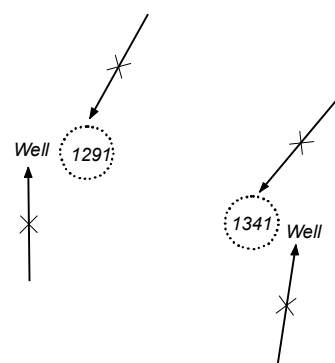

113°33'50"E

21°30'S

1104

896

Well 819

19°30'S

1234

114°30'E

Previous Notice 101/2018

NTM 563/2018



Australian Government
Department of Defence

AUS 328

© Commonwealth of Australia 2018

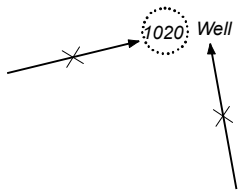

665

21°S

114°E

732

258

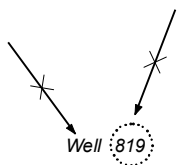

Previous Notice 968/2017

NTM 563/2018



Australian Government
Department of Defence

AUS 329

© Commonwealth of Australia 2018

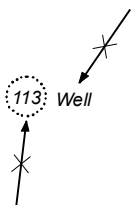

19°30'S

116°30'E

84

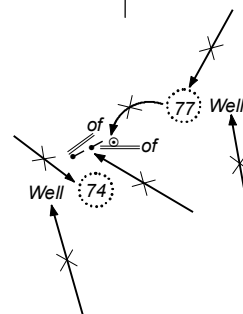

81

62

Previous Notice 781/2017

NTM 563/2018



Australian Government
Department of Defence

AUS 741

© Commonwealth of Australia 2018

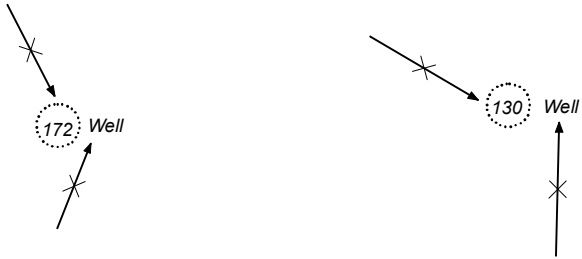

59
115°15'E

20°15'S

46

Previous Notice 318/2018

NTM 563/2018



Australian Government
Department of Defence

AUS 742

© Commonwealth of Australia 2018

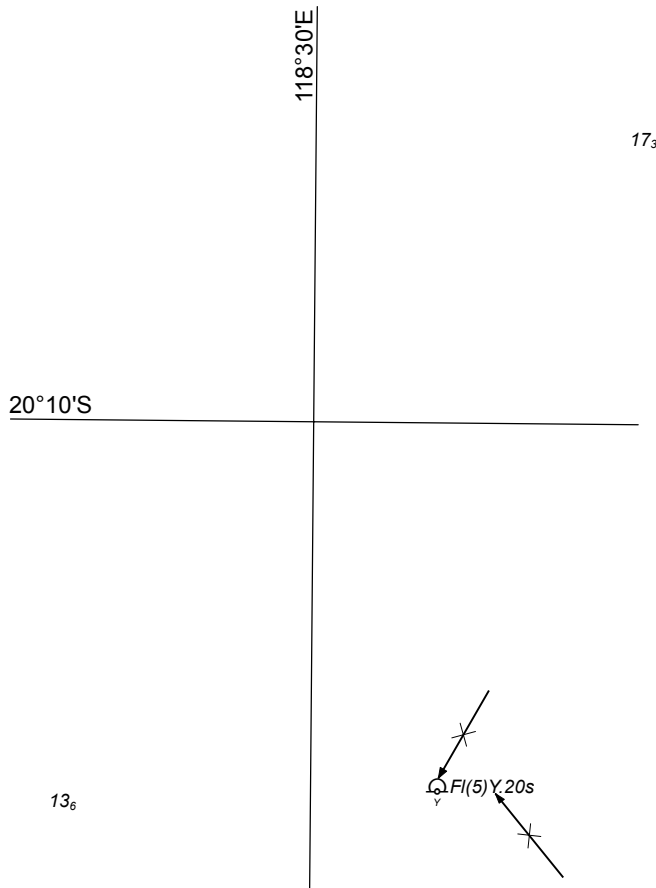

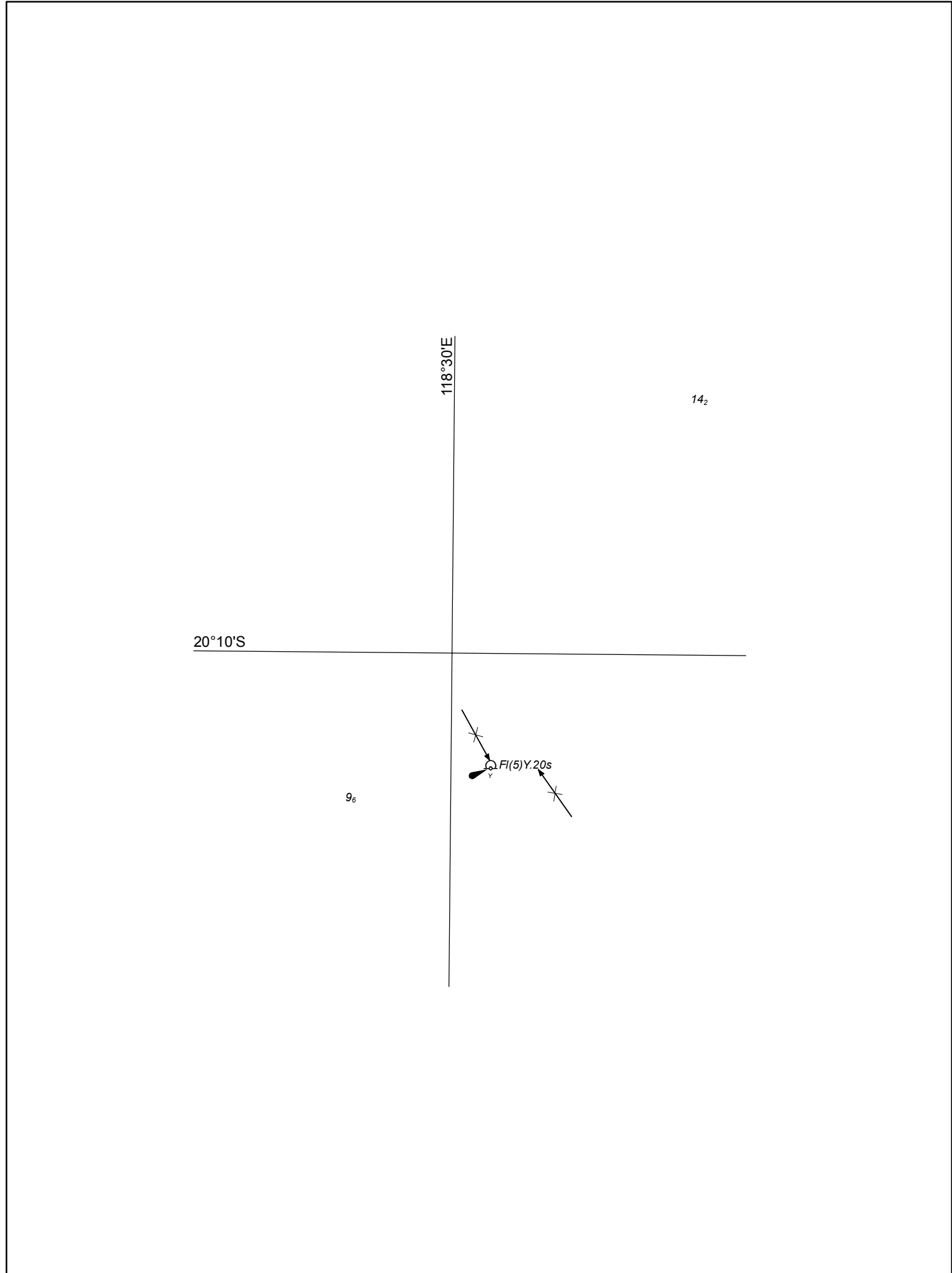

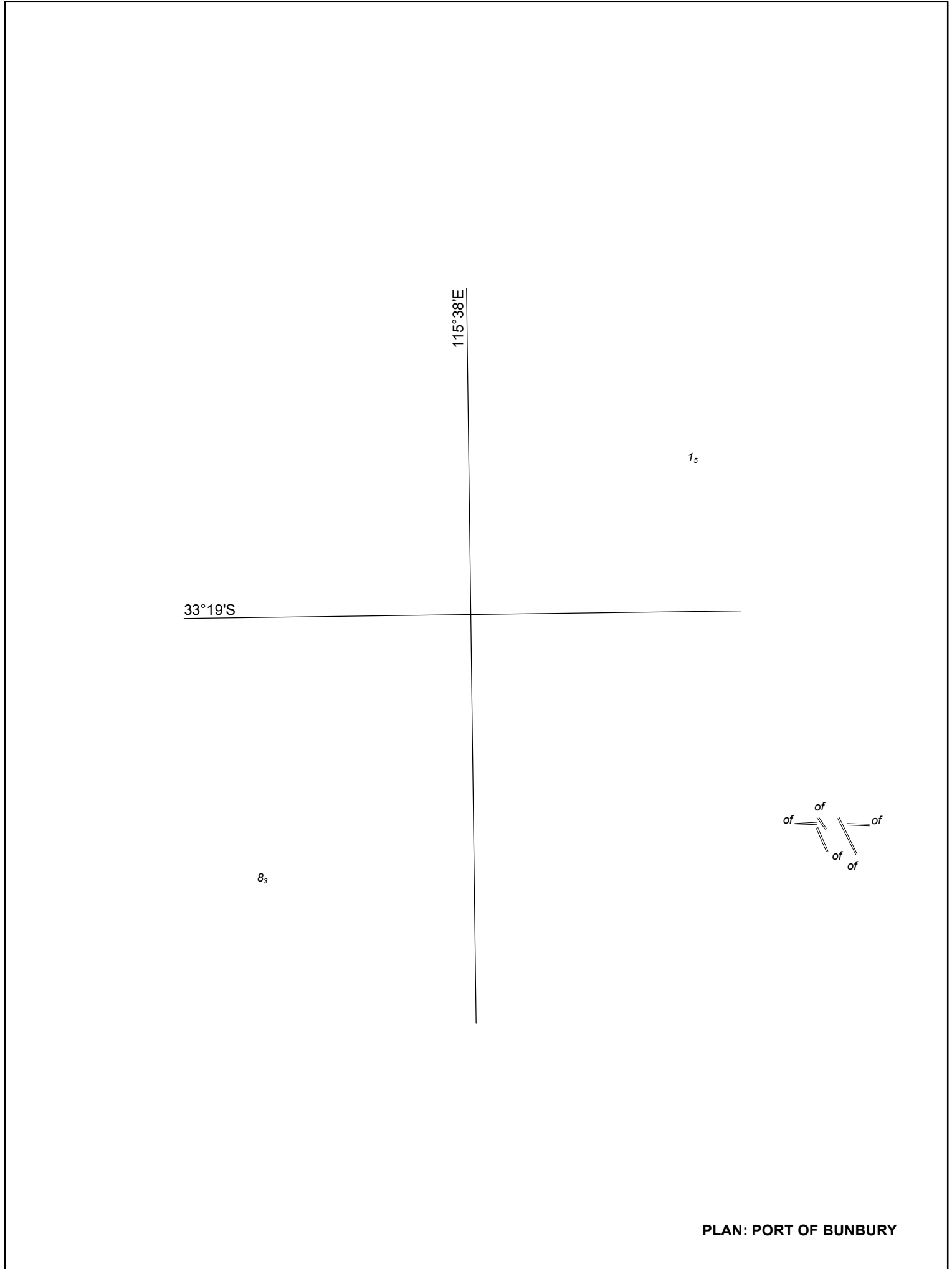

Previous Notice 200/2018

NTM 565/2018



AUS 115

© Commonwealth of Australia 2018

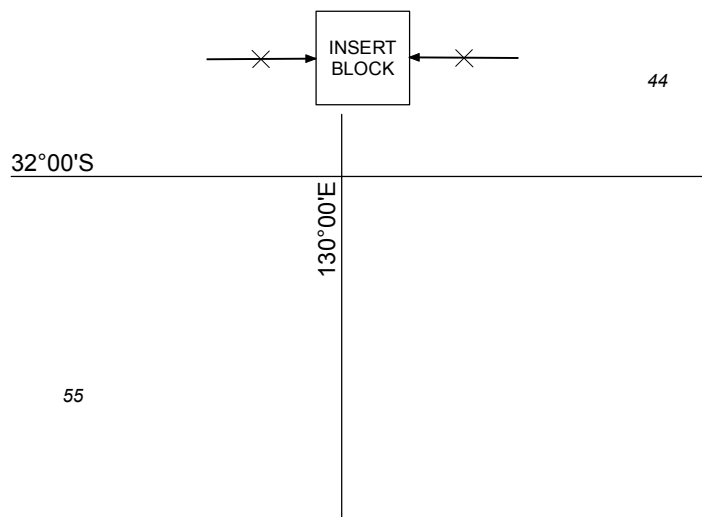

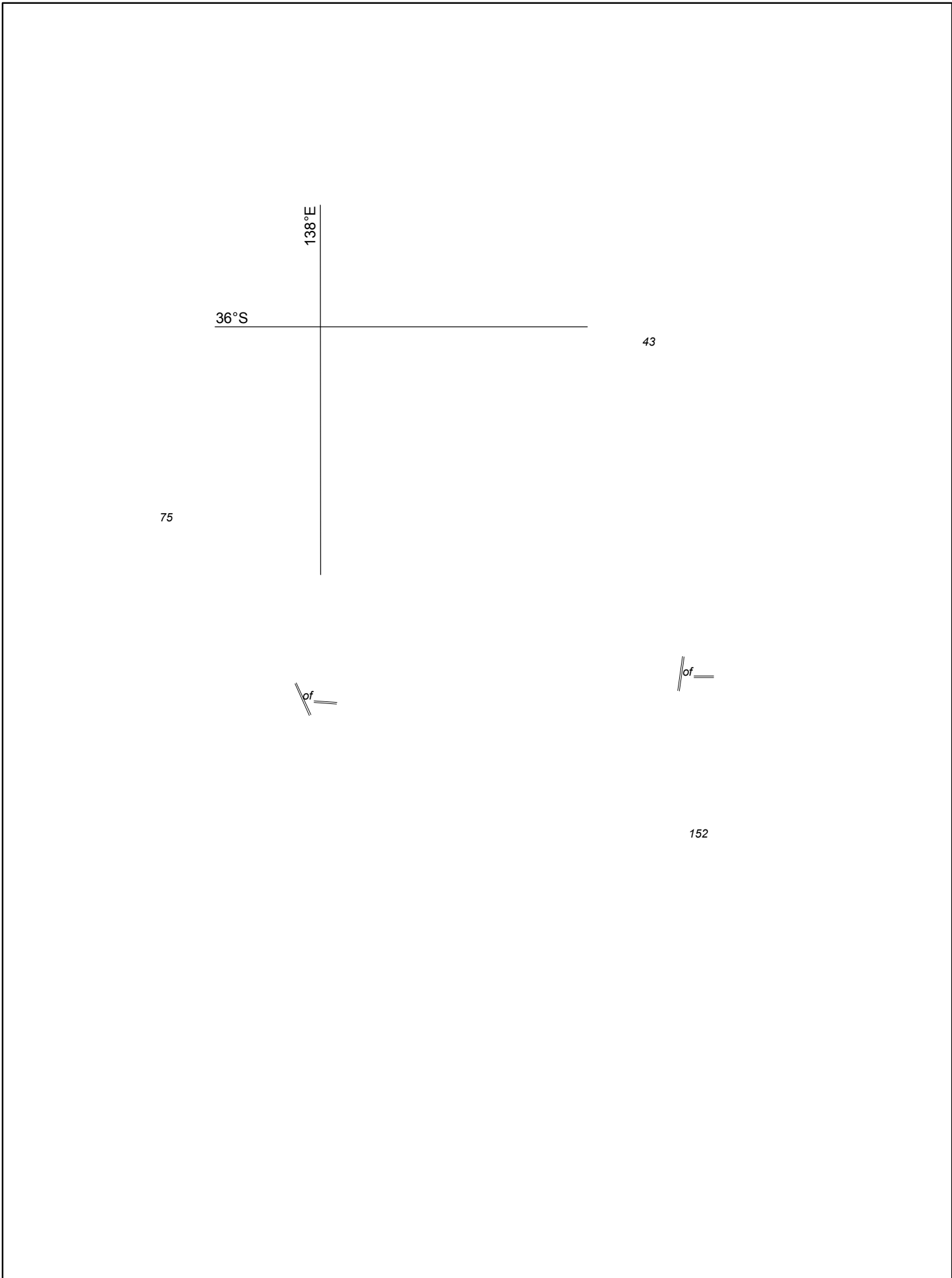

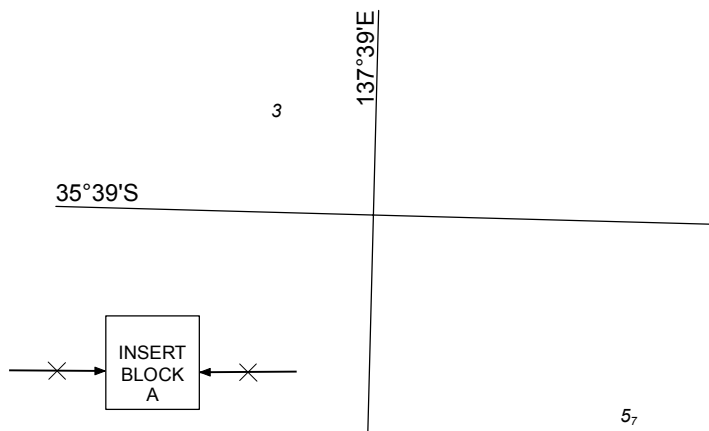
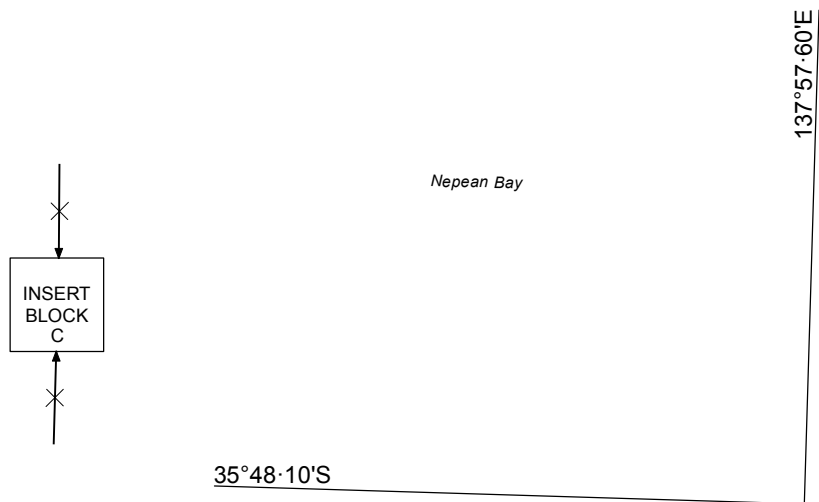
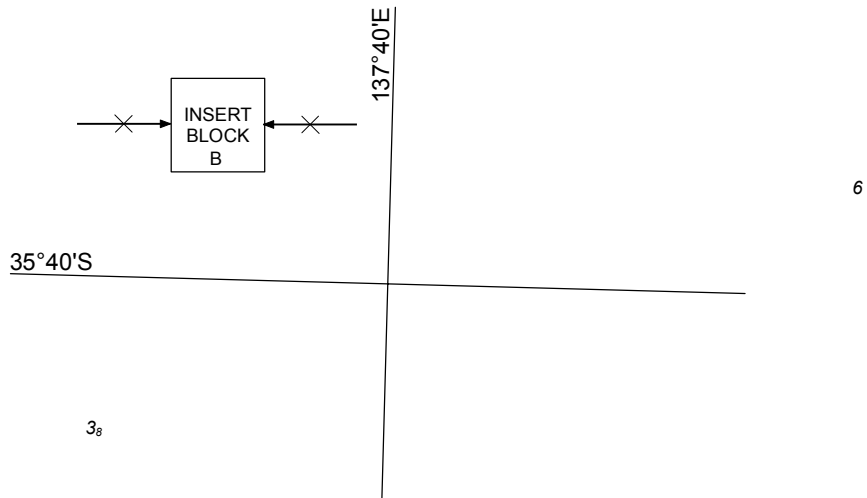

PLAN: KINGSCOTE

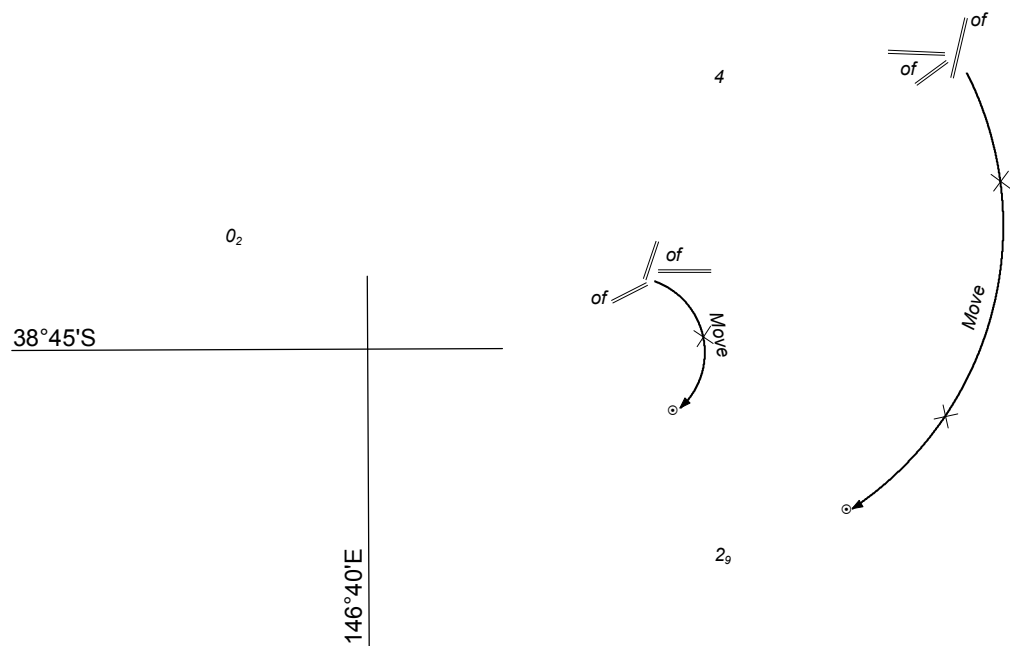

4₉

of of

12₆

146°41'E

38°45'S

PLAN: APPROACHES TO PORT ALBERT

Previous Notice 449/2018

NTM 569/2018



AUS 182

© Commonwealth of Australia 2018

Move
of
of

38°30'S

147°00'E

12₉

4₅

Previous Notice 398/2018

NTM 569/2018



Australian Government
Department of Defence

AUS 357

© Commonwealth of Australia 2018

8₂

144°22'E

38°08'S

8₆
In lieu

7₉

Previous Notice 105/2018

NTM 570/2018



Australian Government
Department of Defence

AUS 153

© Commonwealth of Australia 2018

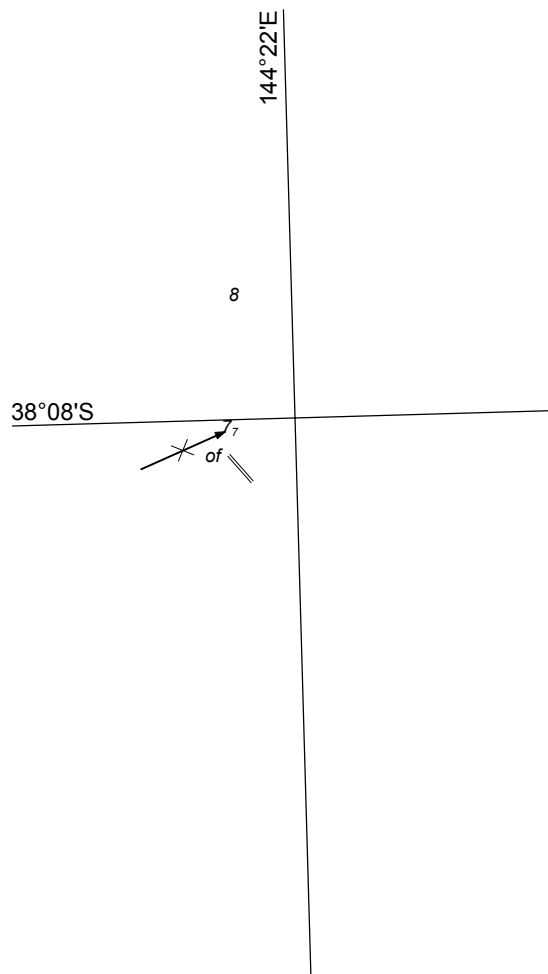

2₆

Previous Notice 105/2018

NTM 570/2018



AUS 157

© Commonwealth of Australia 2018

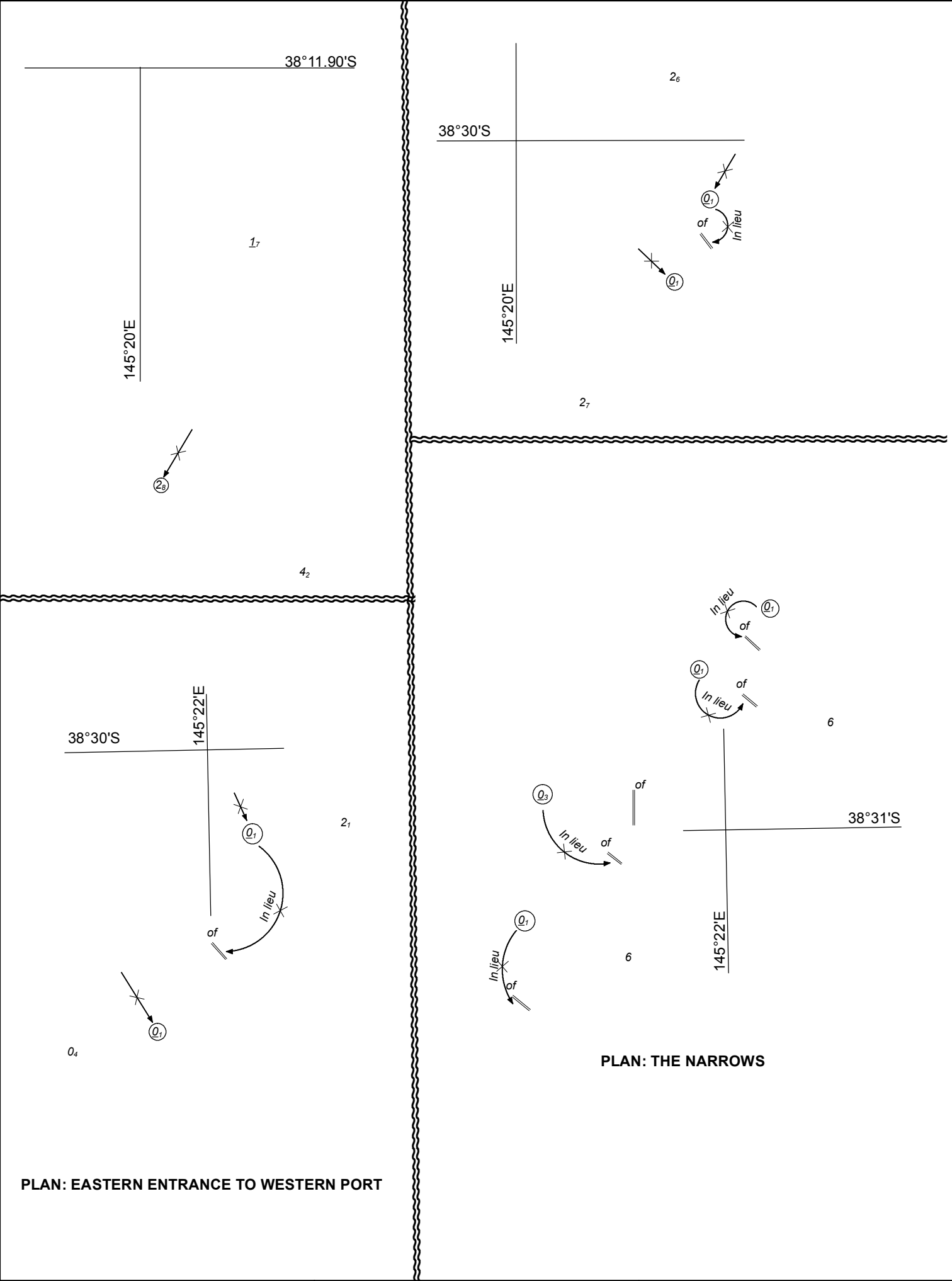

PLAN: EASTERN ENTRANCE TO WESTERN PORT

PLAN: THE NARROWS



6

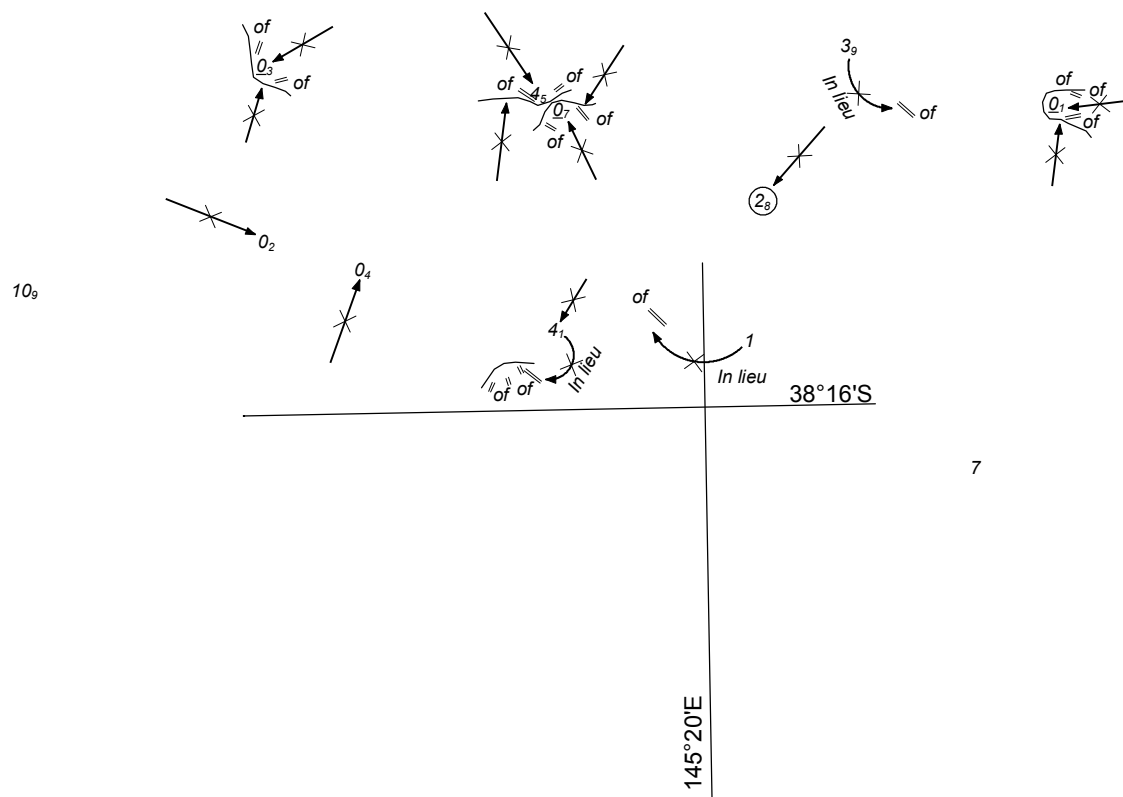

PLAN: CONTINUATION OF WESTERN PORT

Previous Notice 105/2018

NTM 572/2018



Australian Government
Department of Defence

AUS 151

© Commonwealth of Australia 2018

1_2

145°18'E

38°15'S

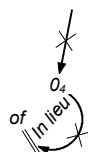
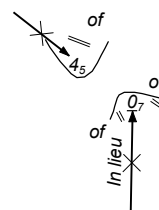
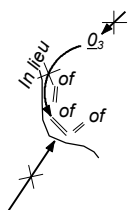

Q_9

15₁

PLAN: RUTHERFORD INLET

Previous Notice 247/2018

NTM 572/2018



AUS 152

© Commonwealth of Australia 2018