

Mayfield

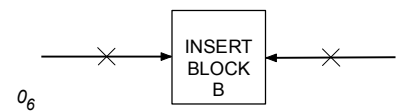
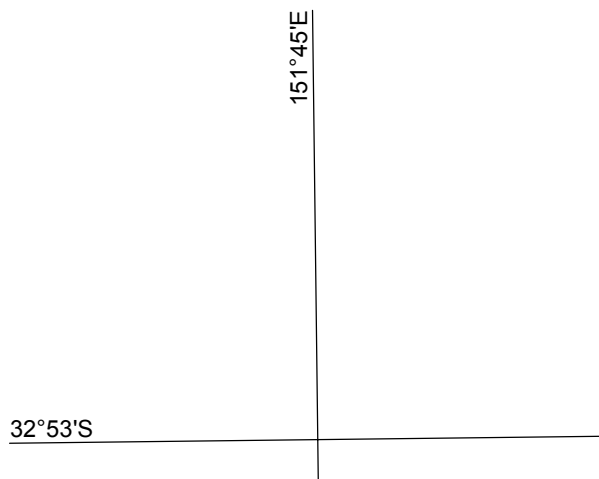

PLAN: HUNTER RIVER (SOUTH ARM)

Previous Notice 806/2018

NTM 946/2018



Australian Government  
Department of Defence

AUS 208

© Commonwealth of Australia 2018

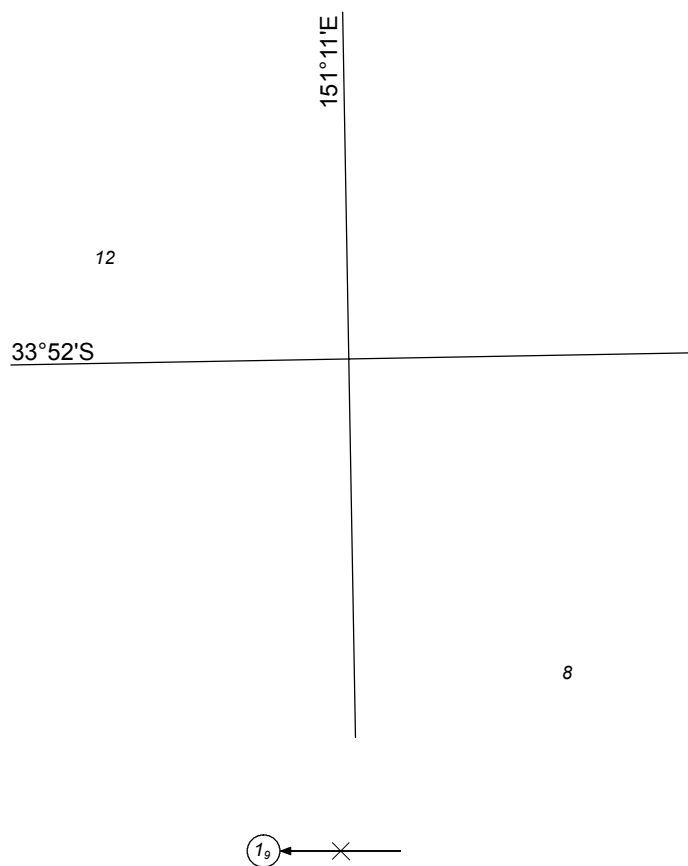

4<sub>1</sub>

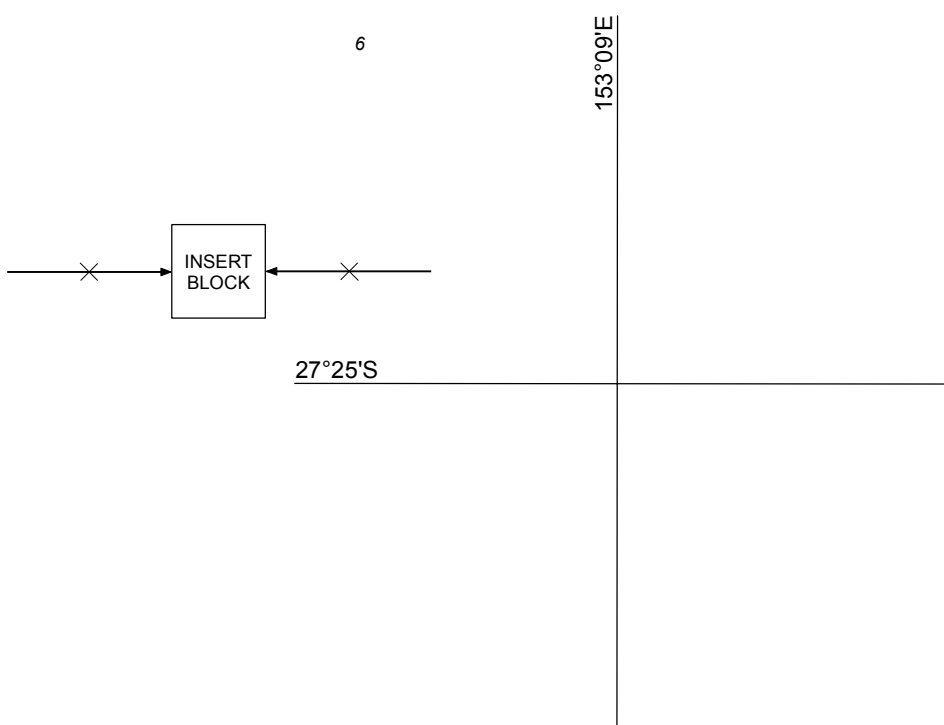

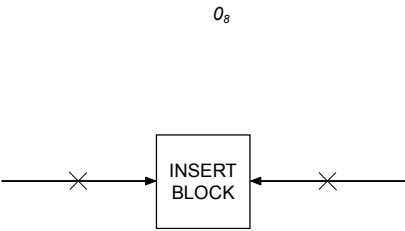
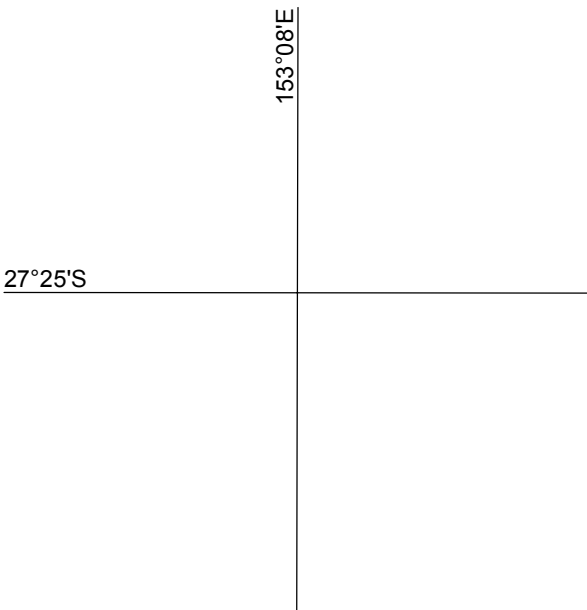

$8_1$





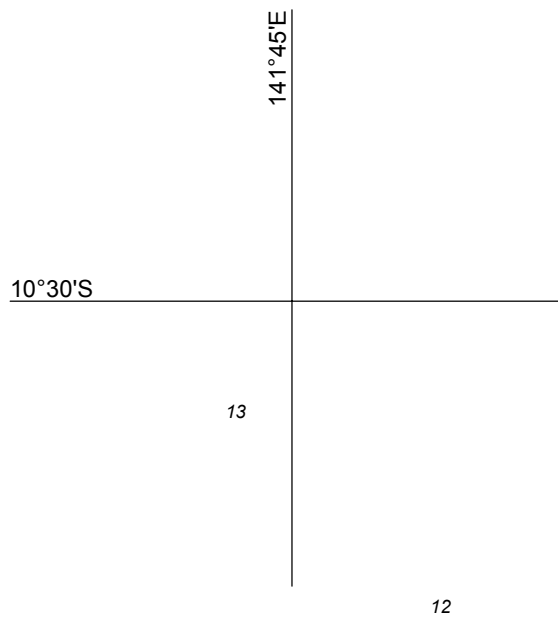

*of*  
*In magenta* *of* *Booby* *In magenta*  
*In magenta* (see SRS Note) VHF 14

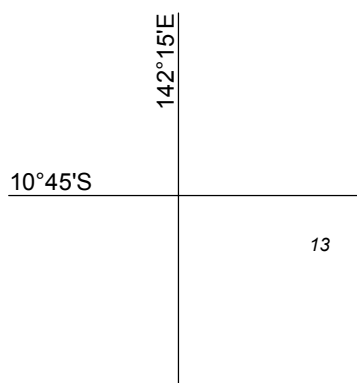

*of*  
*Endeavour* *In magenta*  
VHF 14



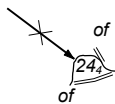

9

153° 15'E

24° 30'S

48

153° 30'E

888

24° 30'S



Sandy Cape  
VHF 14

1387

Previous Notice 337/2016

NTM 948, 951/2018



AUS 816

© Commonwealth of Australia 2018

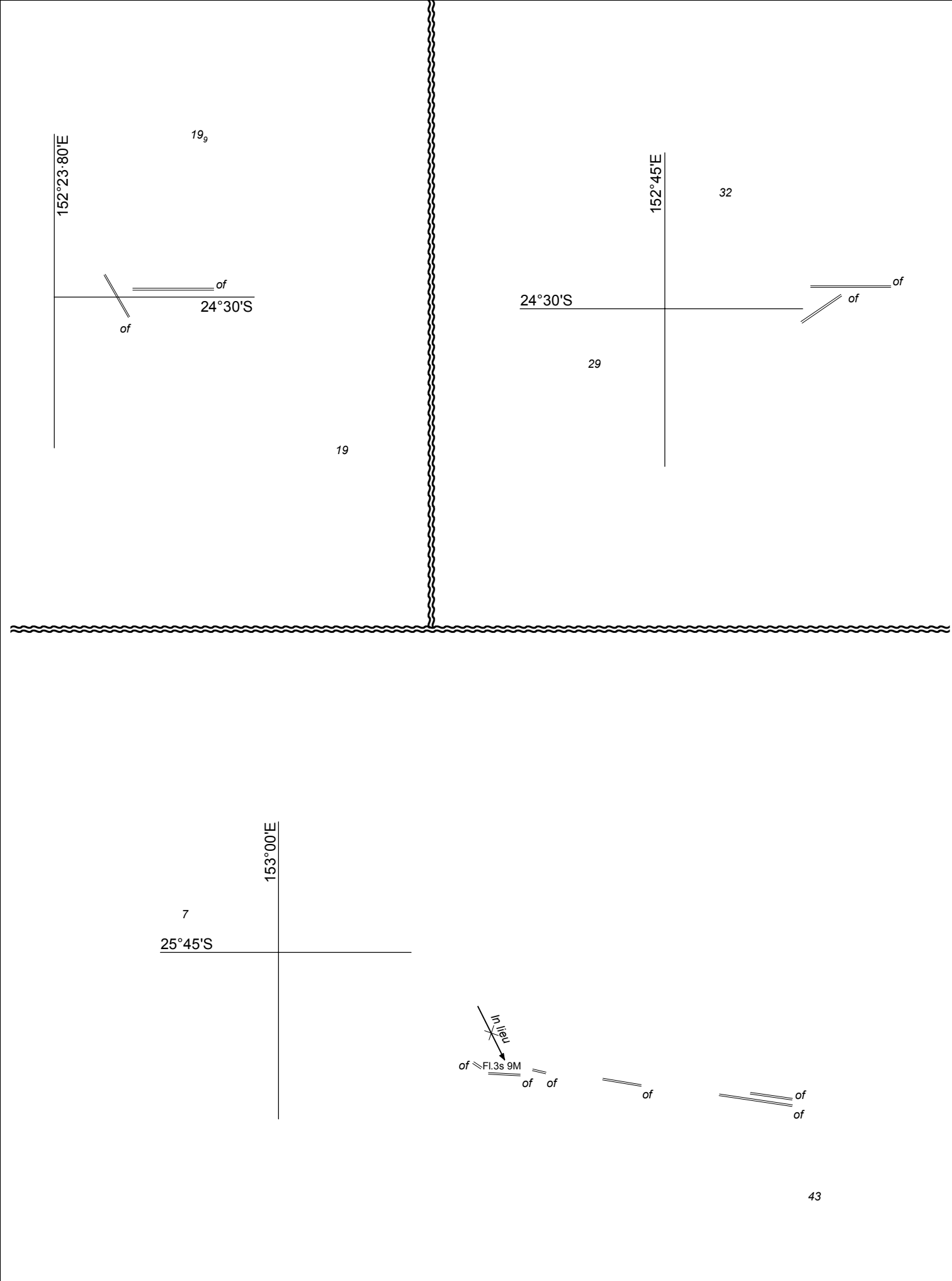

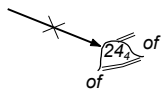

9

153°15'E

40

23°51'90"S

33

of

of

151°45'E

33

24°30'S

152°30'E

19<sub>g</sub>

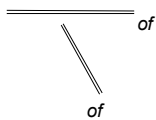

24°30'S

19

152°45'E

31

24°30'S

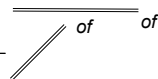

33

Previous Notice 908/2018

NTM 948, 951/2018



AUS 818

© Commonwealth of Australia 2018



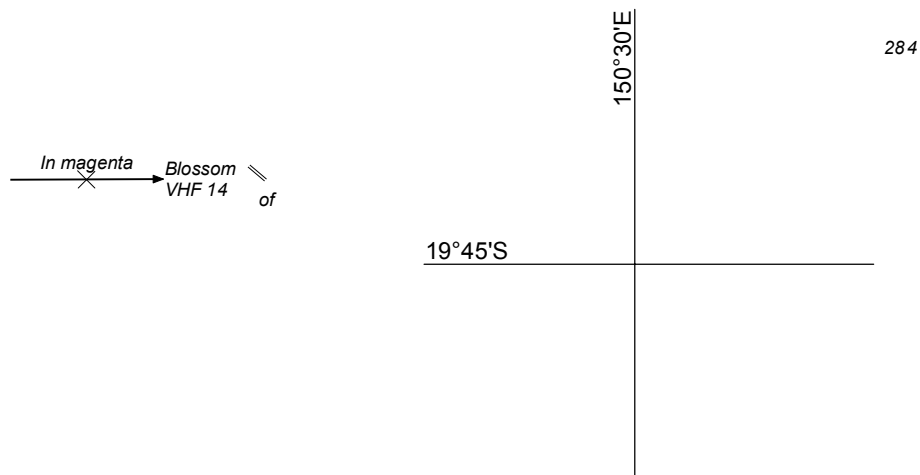

52

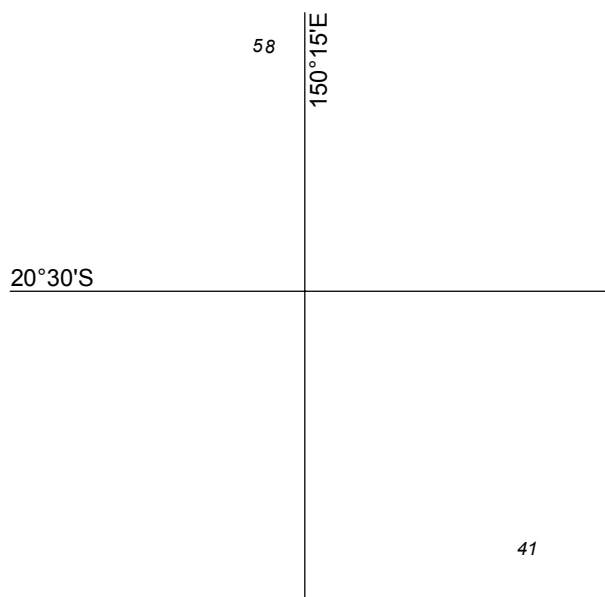

of  
of  
of

Previous Notice 498/2017

NTM 951/2018



AUS 821

© Commonwealth of Australia 2018

of  
of  
of

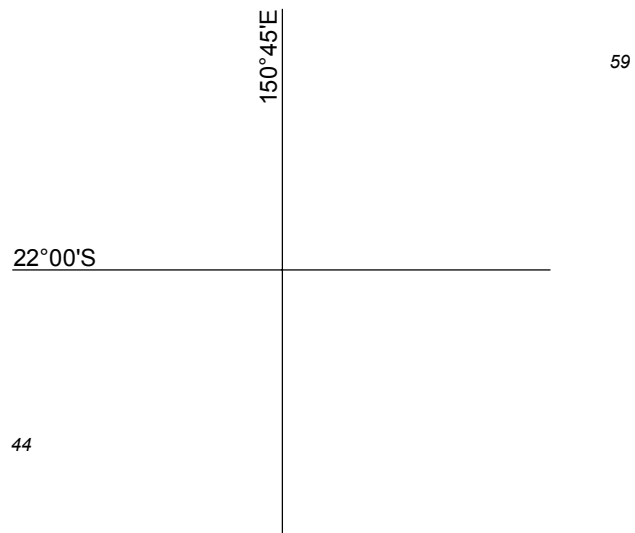

*of*        *of*  
           *of*

23

*of*        *of*  
           *of*  
*of*        *of*  
           *of*

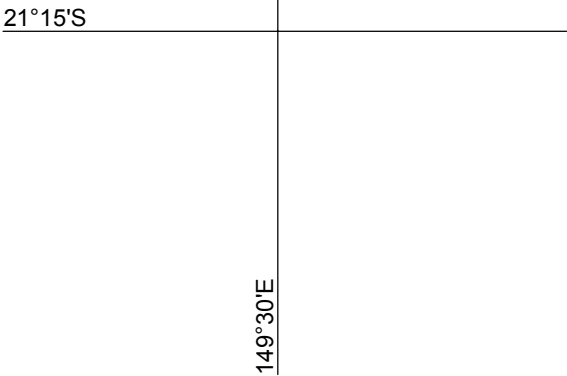

13





20°09'40"S

148°45'E

26

of  
of  
of

20°30'S

149°00'E

6

44

of  
of  
of

6

of  
of  
of  
149°15'E

61

20°15'S

54

Previous Notice 810/2018

NTM 951/2018



AUS 824

© Commonwealth of Australia 2018

*of*  
*of*

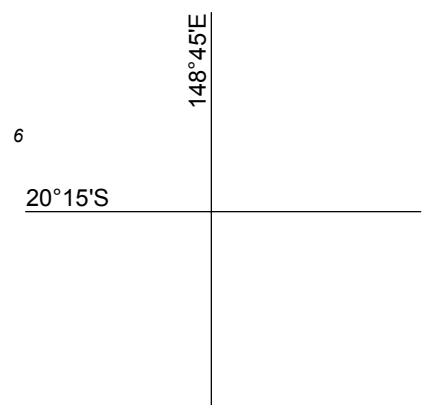

42



61

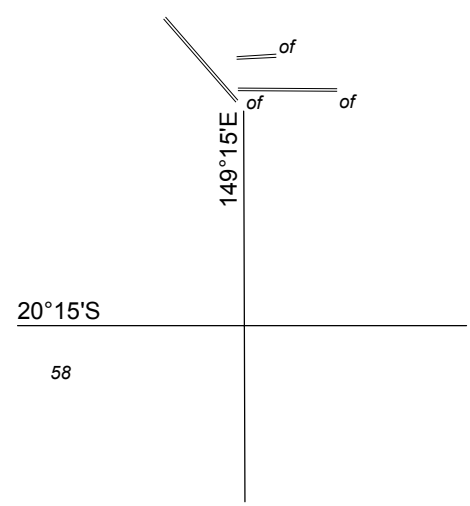

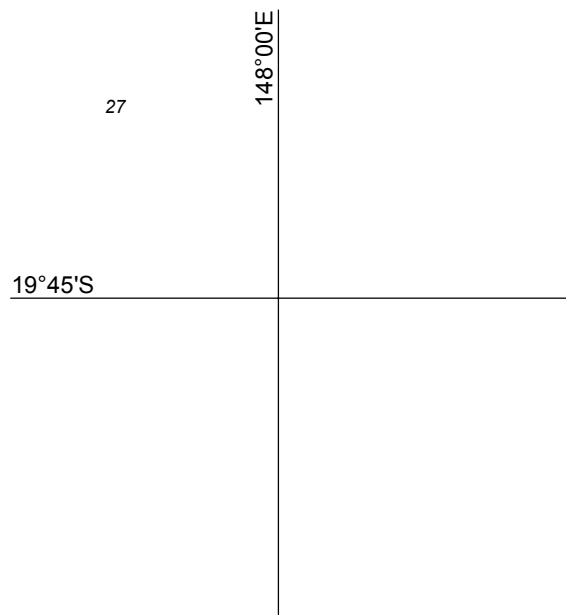

of

of

of

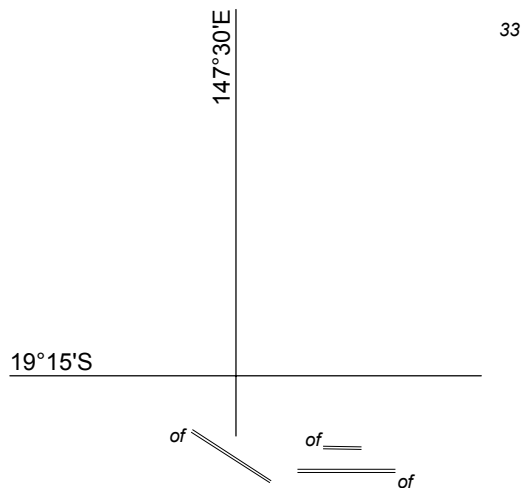

17

Previous Notice 390/2018

NTM 951/2018



AUS 826

© Commonwealth of Australia 2018

of  
of

of of  
of

4

147°00'E

14

19°15'S

of of  
of

147°30'E

31

19°15'S

of of  
of

22





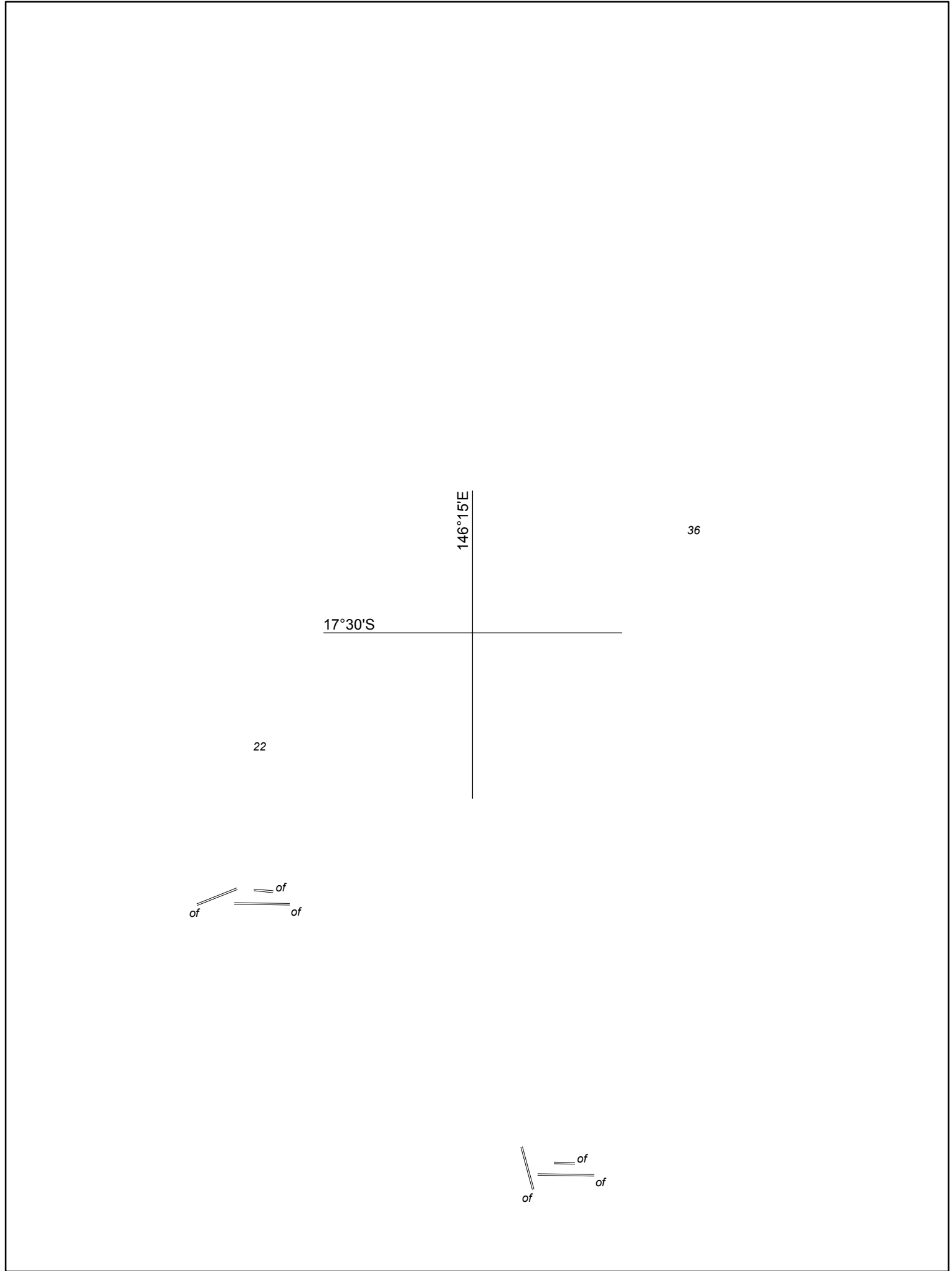

In magenta  
X → Grafton Passage  
VHF 11 //  
of

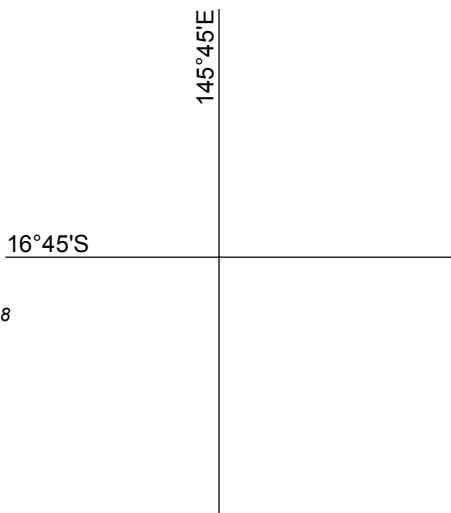
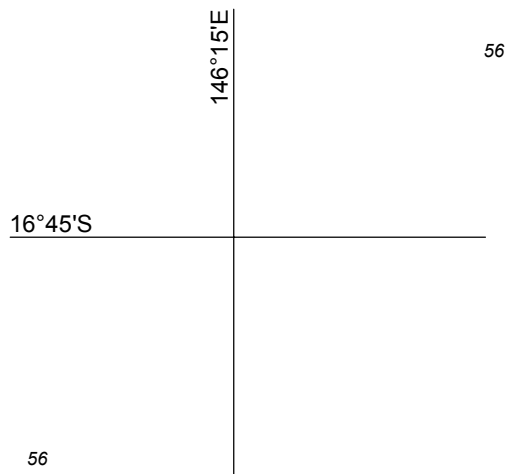

of  
of  
of

Previous Notice 1066/2017

NTM 951/2018



AUS 830

© Commonwealth of Australia 2018

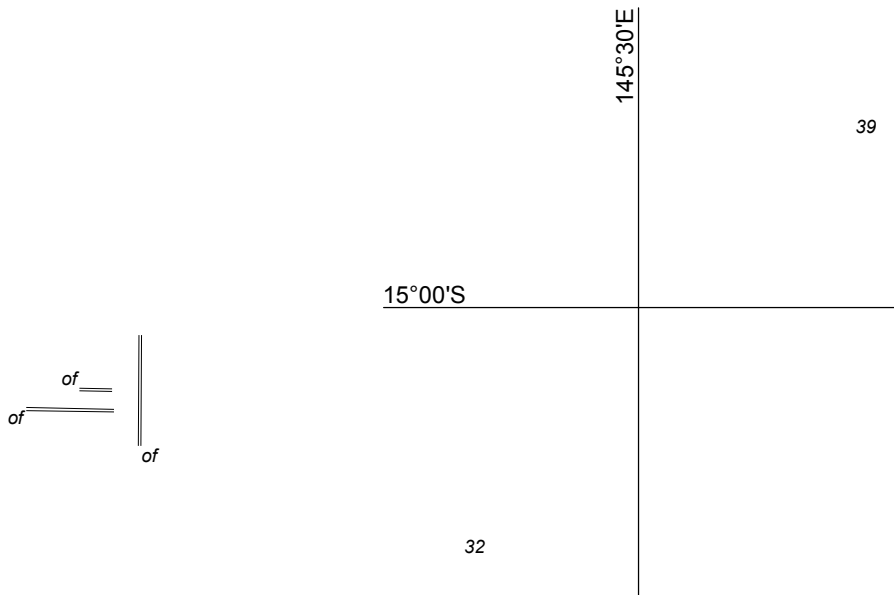
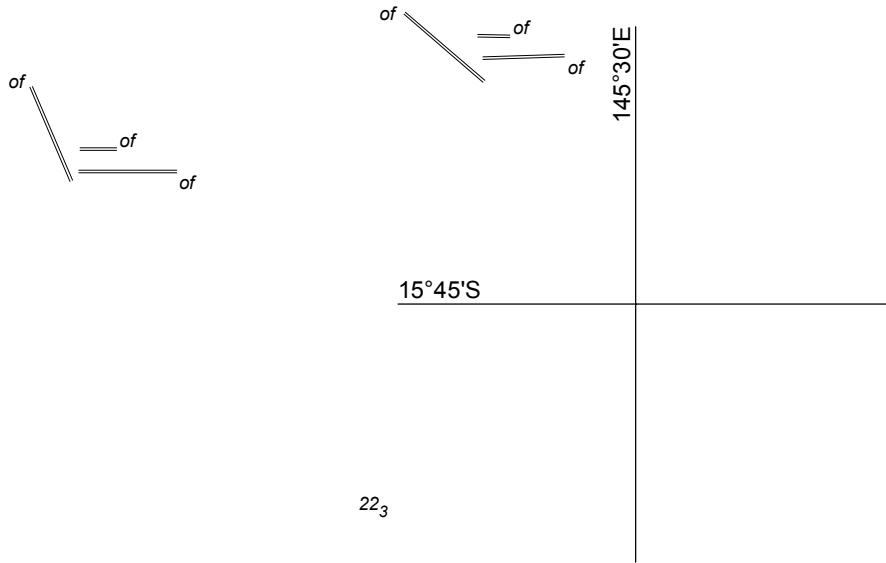



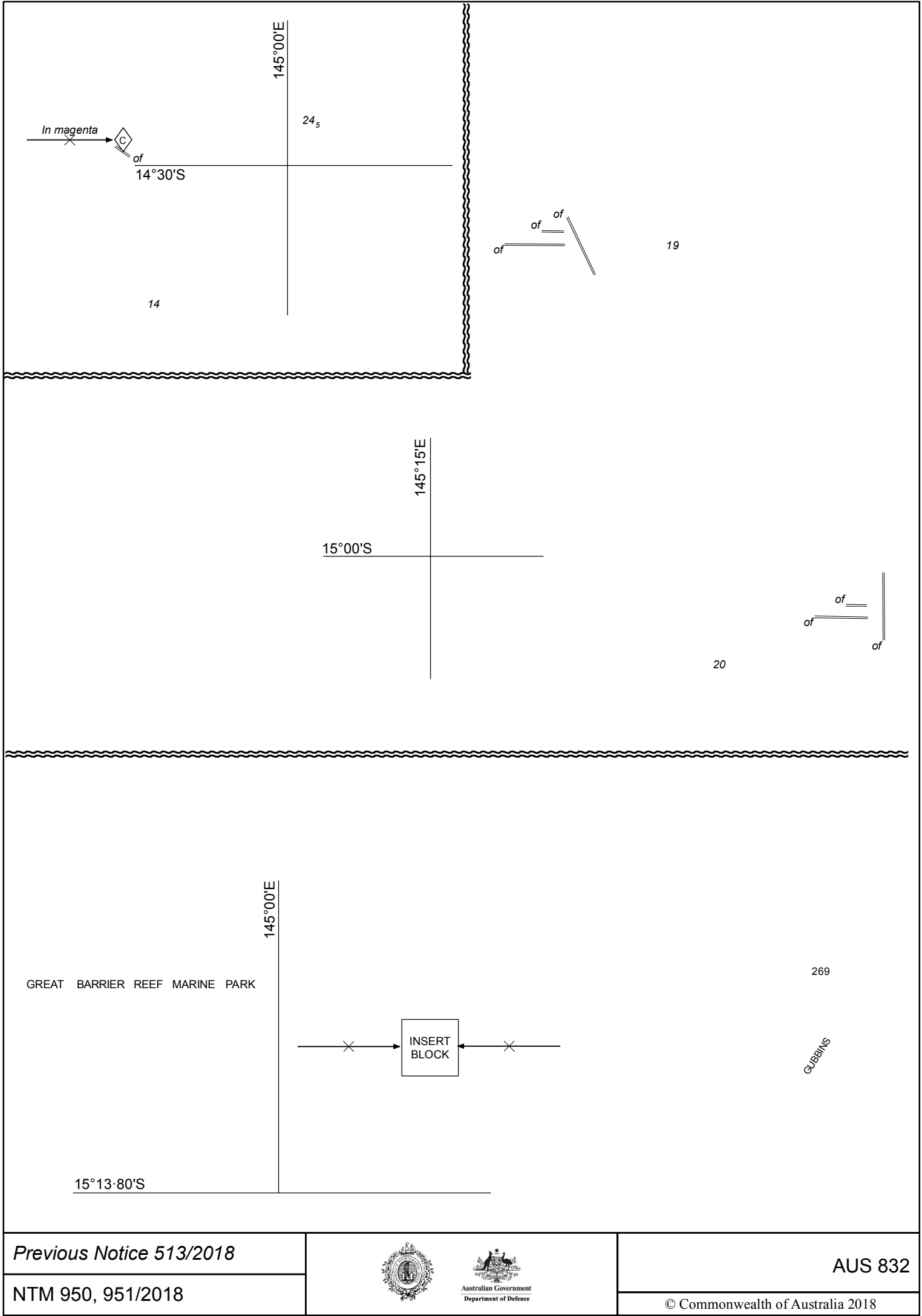

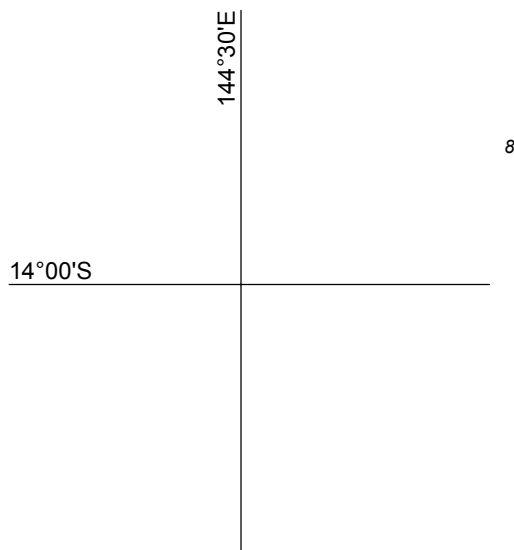



8

25

*of*  *of*  
 *of*



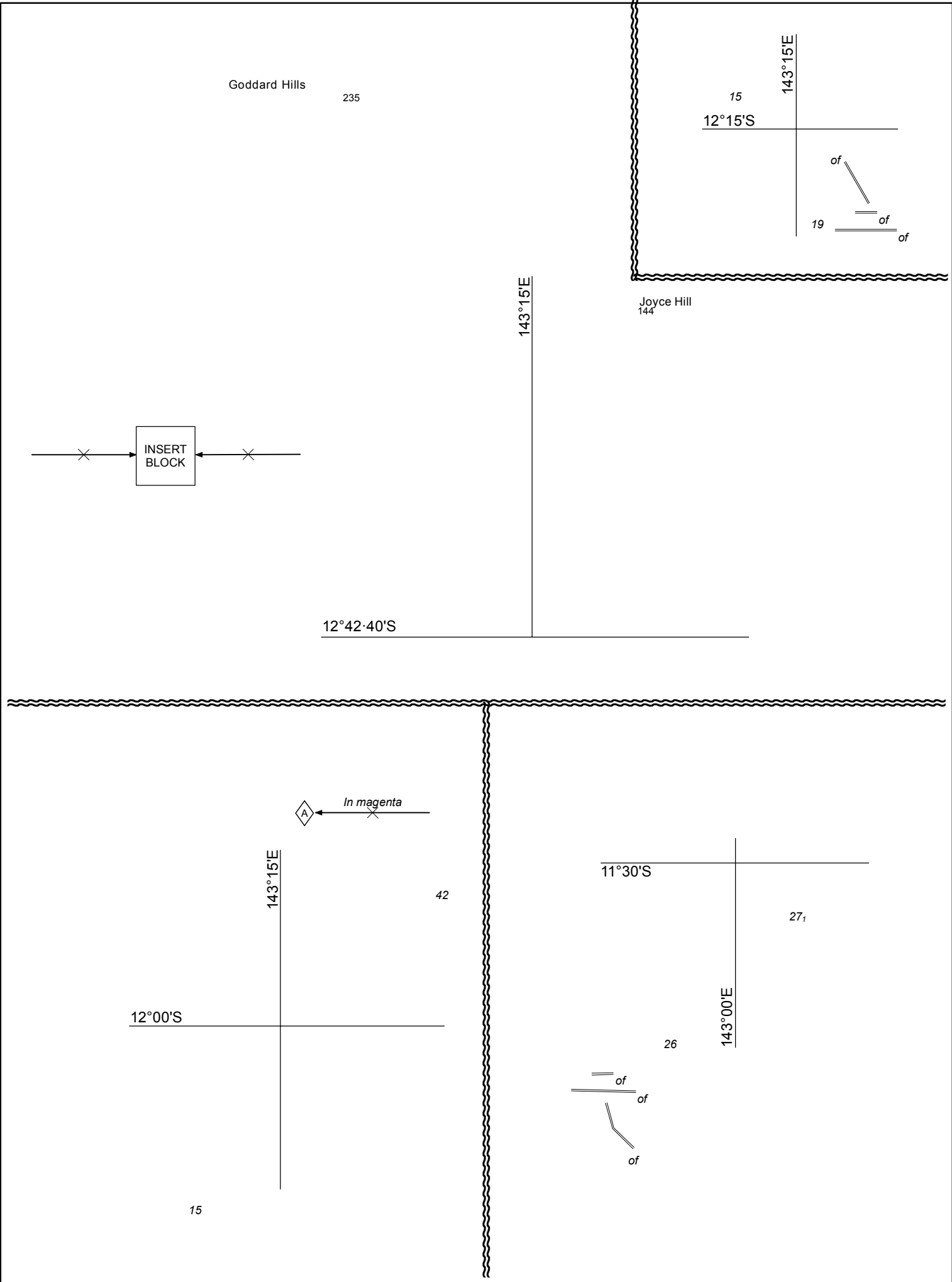

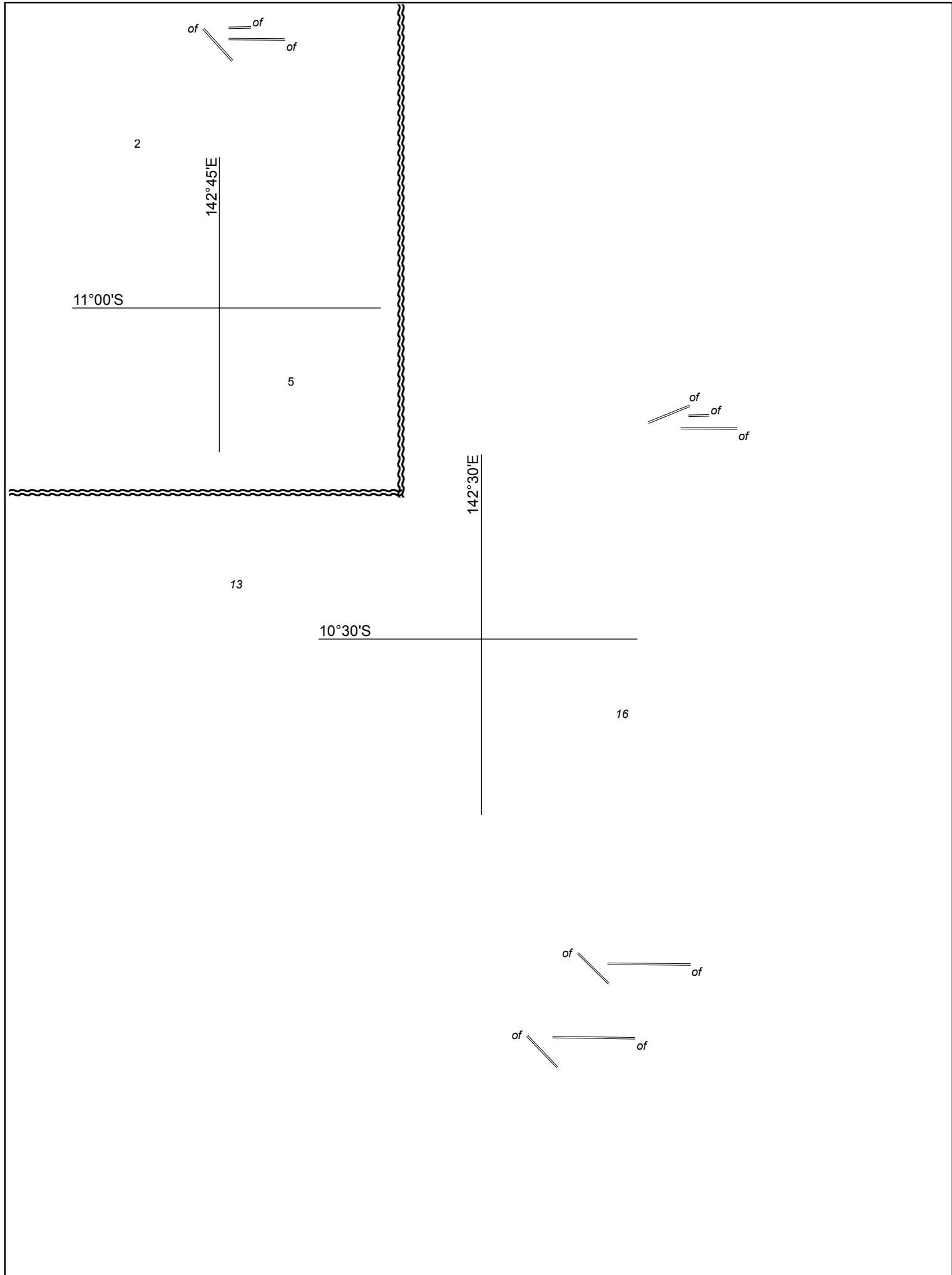

36

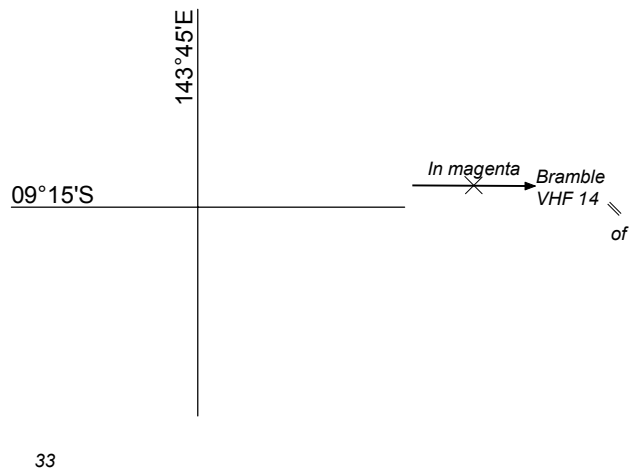

of of

31

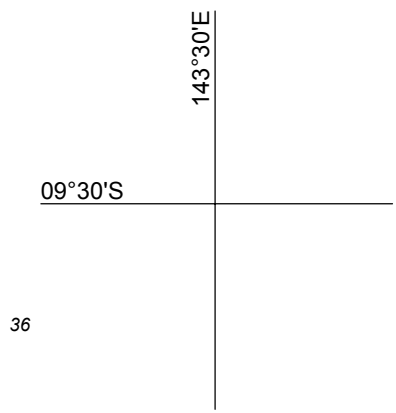

14

of  
of  
of

13

10°30'S

142°30'E

16



153°05'E

18

25°45'S

7

of  
Fl. 3s 9M  
of

of

of

of  
of of

Previous Notice 670/2018

NTM 954/2018



AUS 240

© Commonwealth of Australia 2018

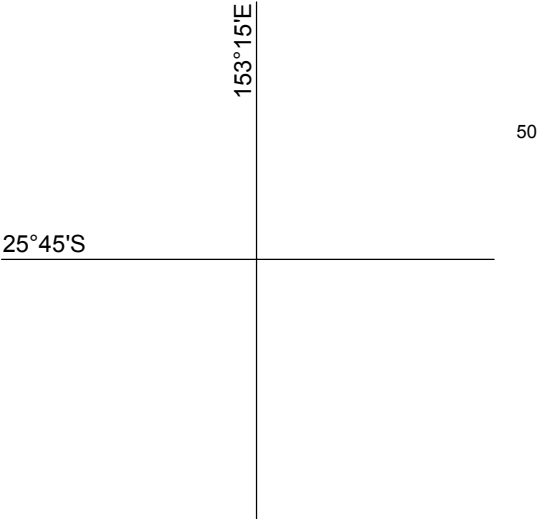
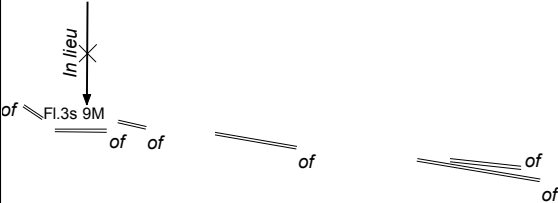



6

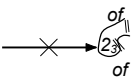

142°27'E

03°09'S

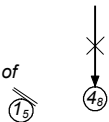
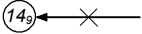
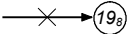

11

PLAN: AITAPE ROADS

Previous Notice 1064/2016

NTM 955/2018



AUS 652

© Commonwealth of Australia 2018

47

*In lieu* → 6<sub>4</sub>

143°30'E

03°30'S

18

*Previous Notice 912/2018*

NTM 956/2018



AUS 389

© Commonwealth of Australia 2018

95

→ × → (16)

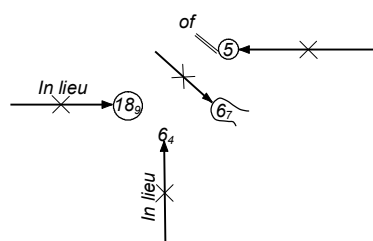

143°30'E

03°25'S

7

Previous Notice 315/2018

NTM 956/2018



AUS 651

© Commonwealth of Australia 2018

1160

145°30'E

1246

10°52'65"S

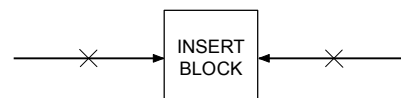

4

144°30'E

09°30'S

90

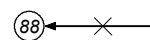
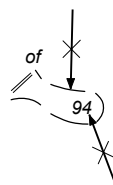

Previous Notice 906/2018

NTM 957, 958/2018



AUS 377

© Commonwealth of Australia 2018

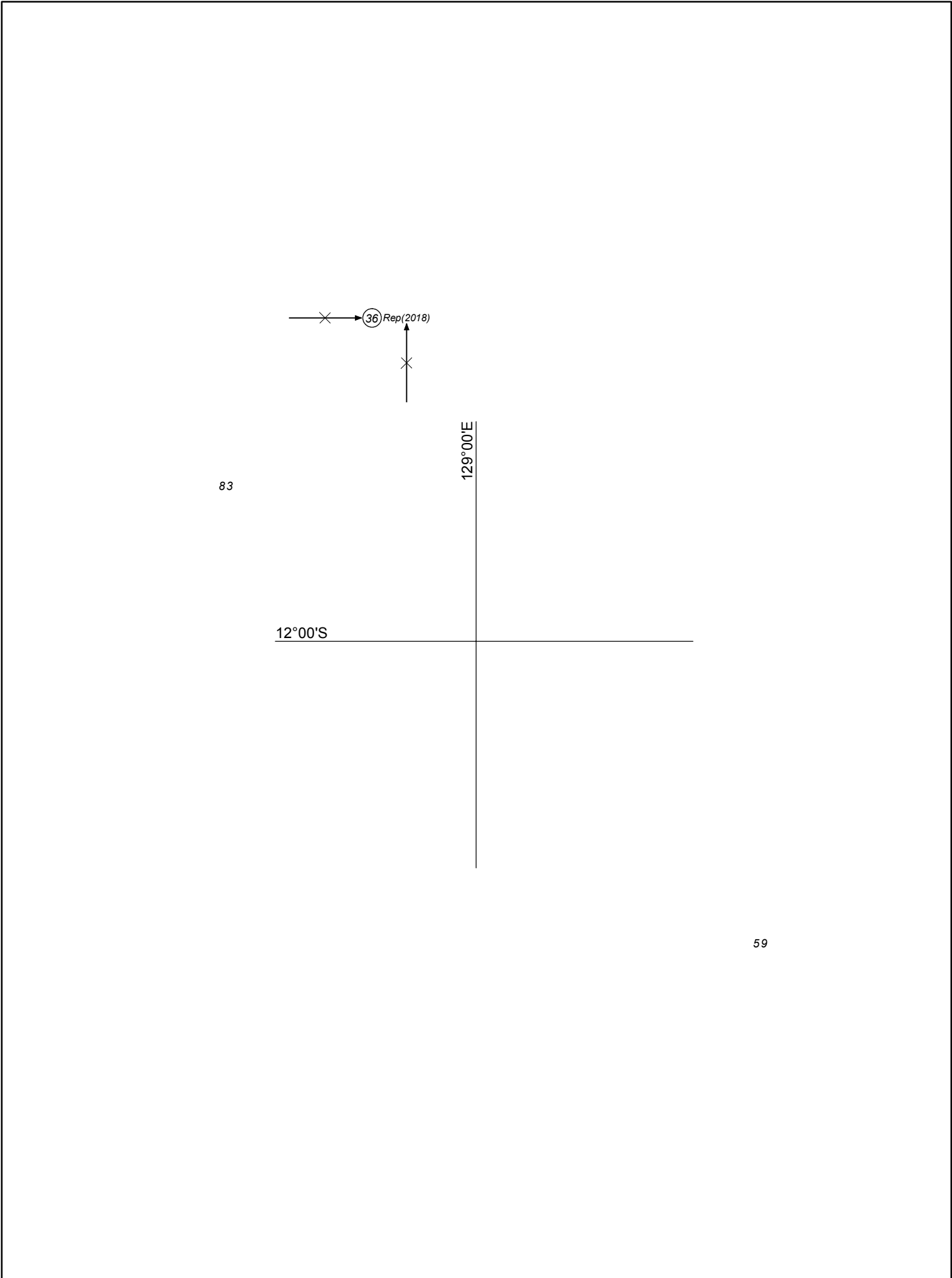

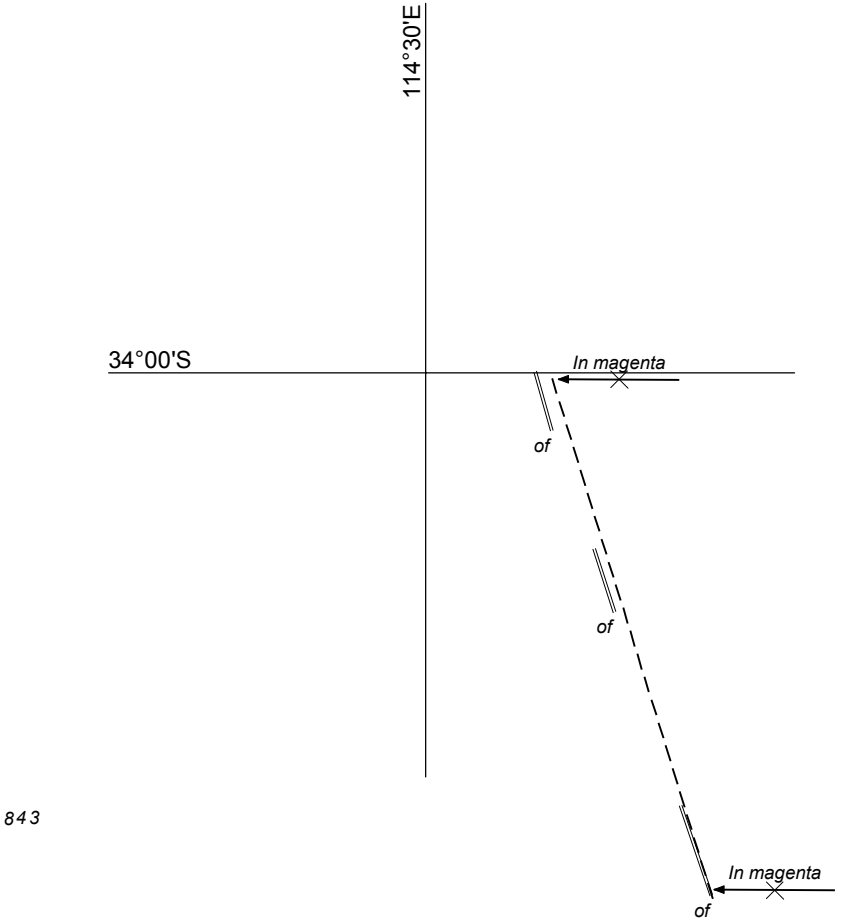

140

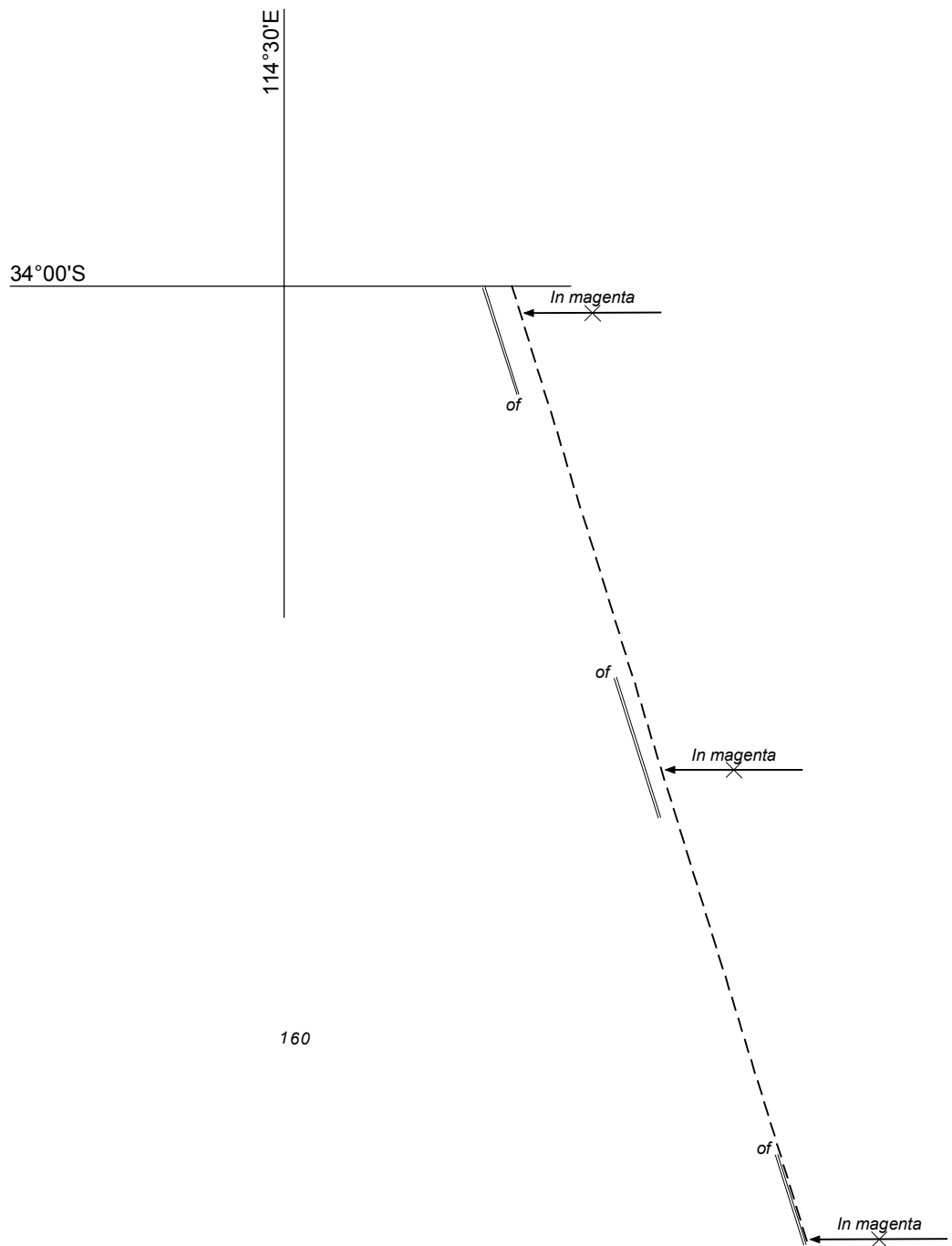

Previous Notice 149/2018

NTM 960/2018



AUS 756

© Commonwealth of Australia 2018

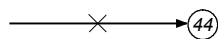

57

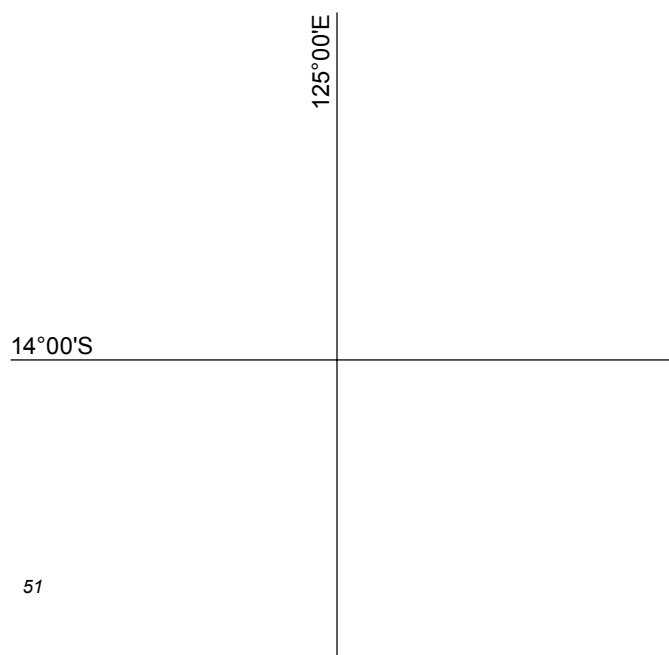



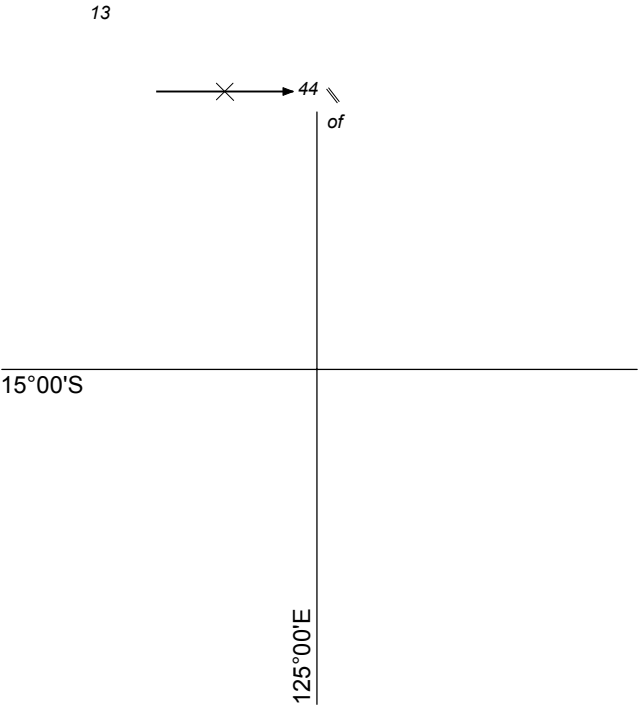

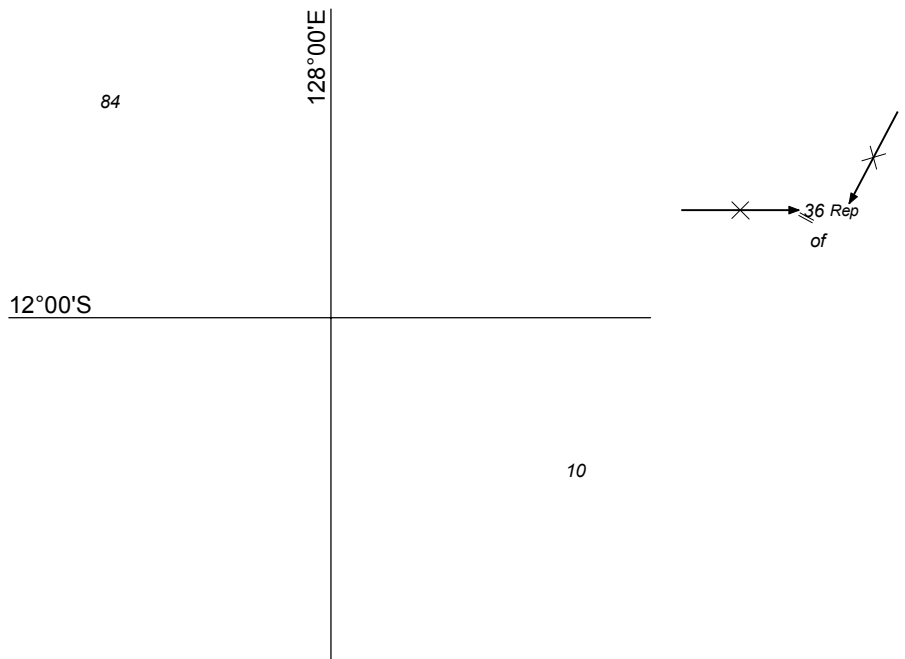

55

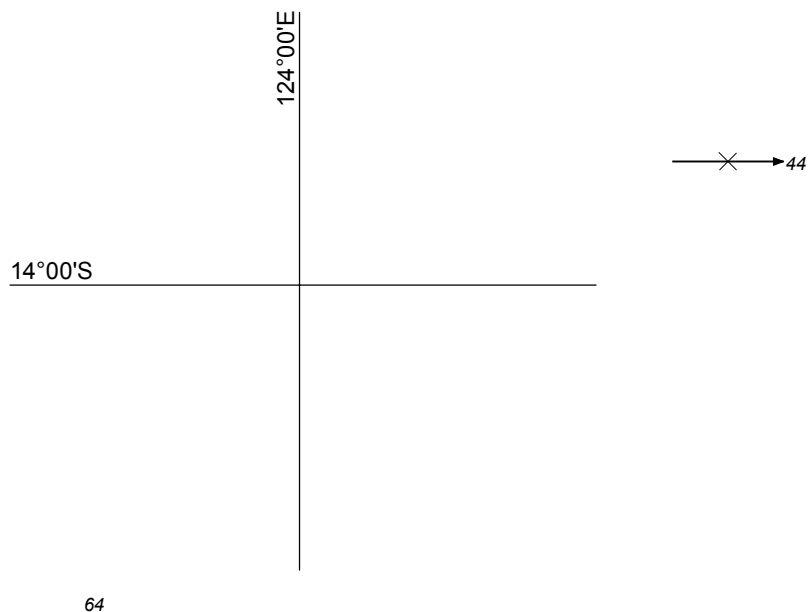

Previous Notice 99/2018

NTM 959, 961/2018



Australian Government  
Department of Defence

AUS 4721  
(INT 721)

© Commonwealth of Australia 2018

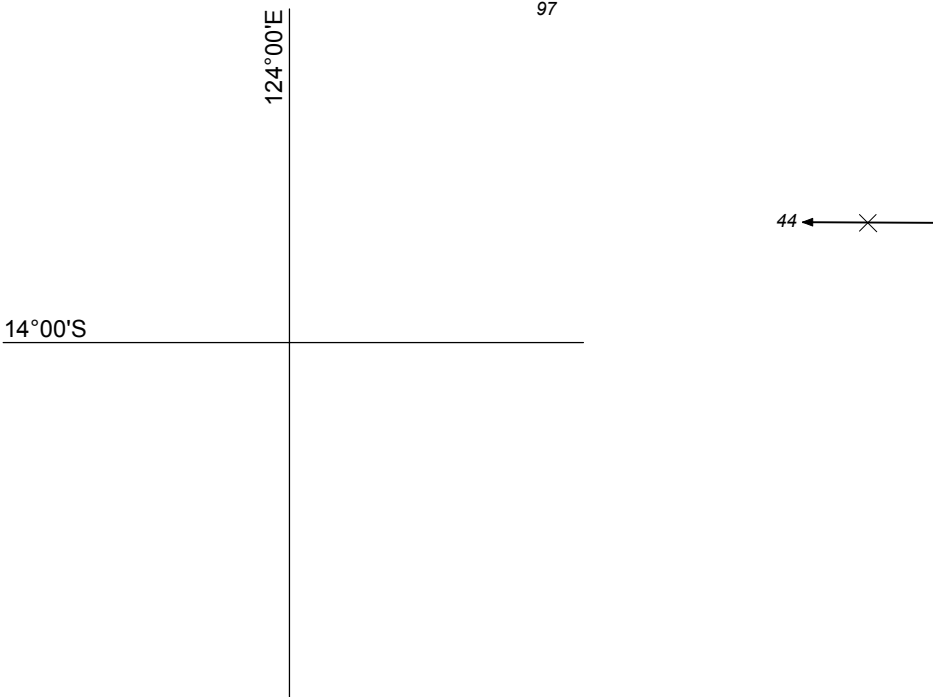
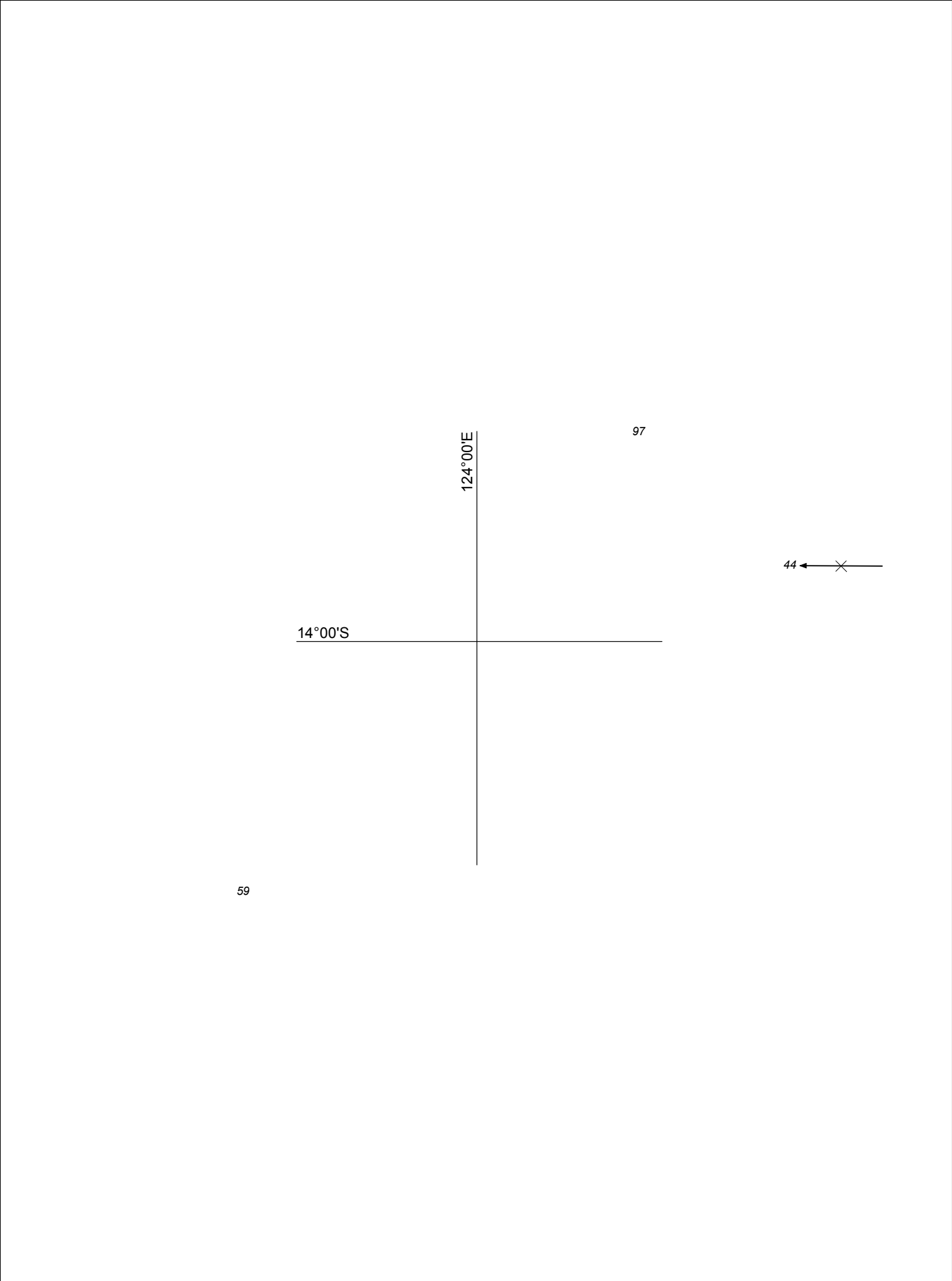

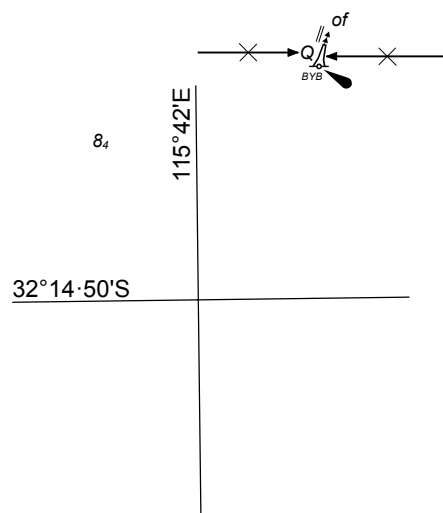

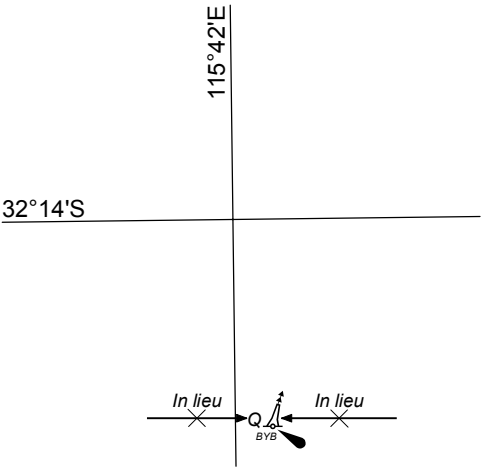

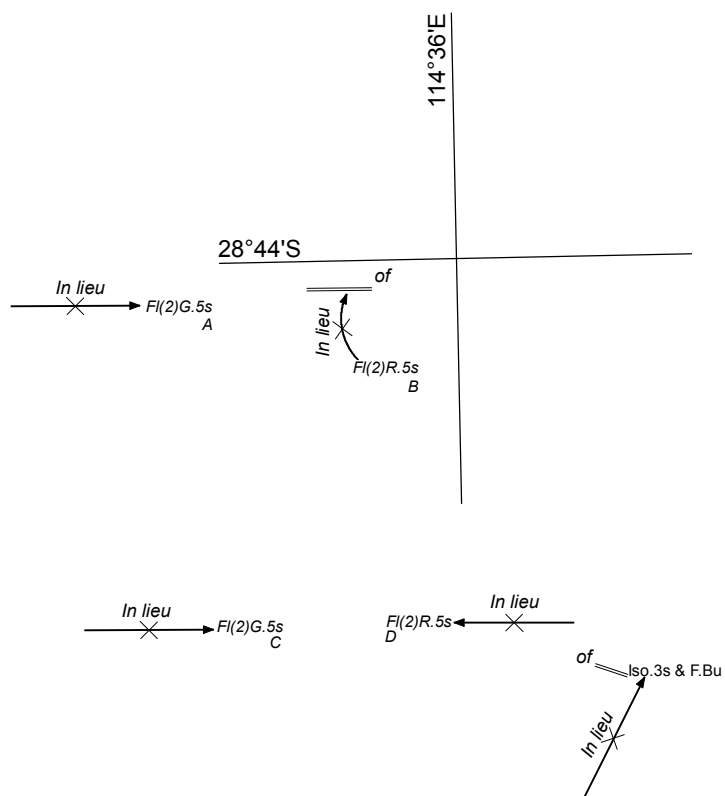

of Iso. 3s & F.Bu In lieu

4

114°30'E

29°00'S

35

Previous Notice 319/2018

NTM 963/2018



AUS 332

© Commonwealth of Australia 2018

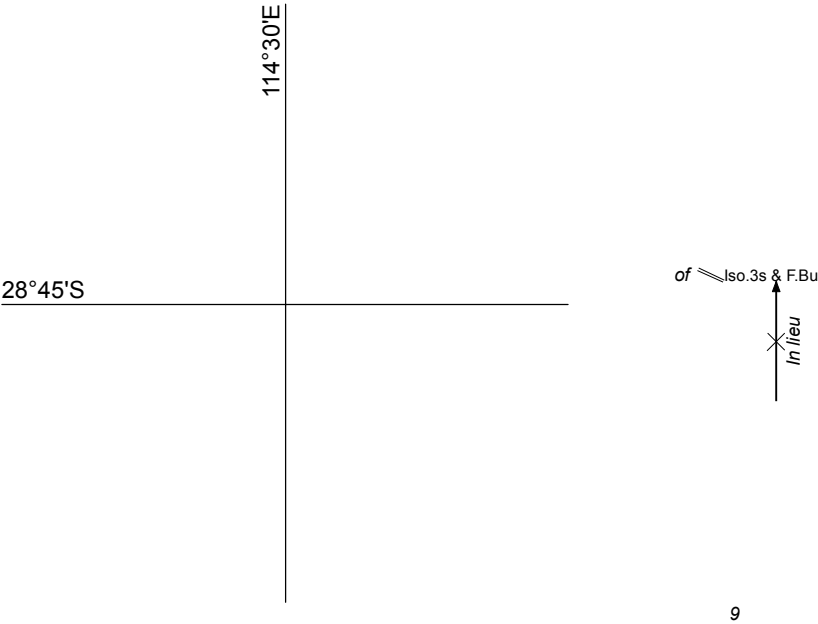



5

116°30'E

Mount Prinsep

21°00'S

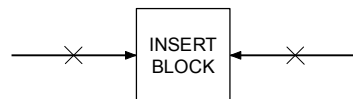

280



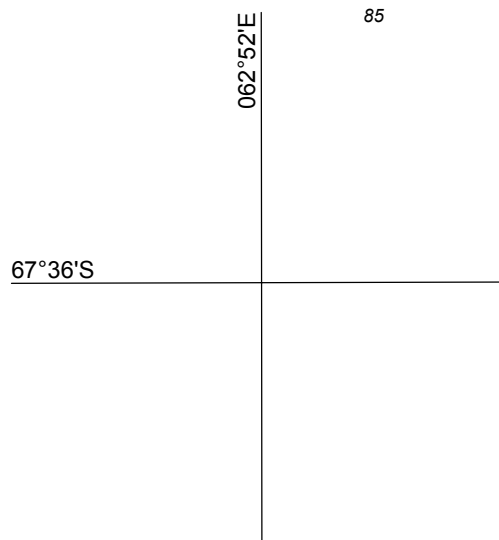
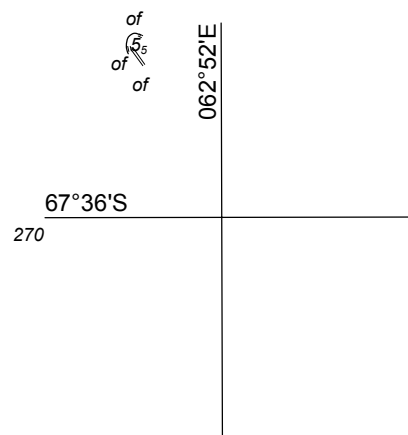
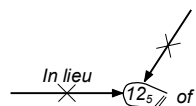
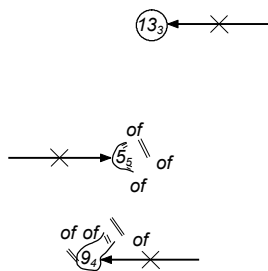

3

PLAN: HORSESHOE HARBOUR

Previous Notice 905/2017

NTM 965/2018



AUS 600  
(INT 9036)

© Commonwealth of Australia 2018

20

43°30'S

146°10'E

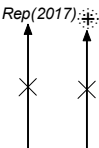

13



43°30'S

7

Rep(2017)



13

146°10'E

63

Previous Notice 413/2017

NTM 966/2018



AUS 794

© Commonwealth of Australia 2018

HIGHWAY

of  
of

146°25'E

Latrobe

41°15'S



4

// of

145° 18'E

42° 20'S

12<sub>5</sub>



✕ → INSERT BLOCK ← ✕

2791

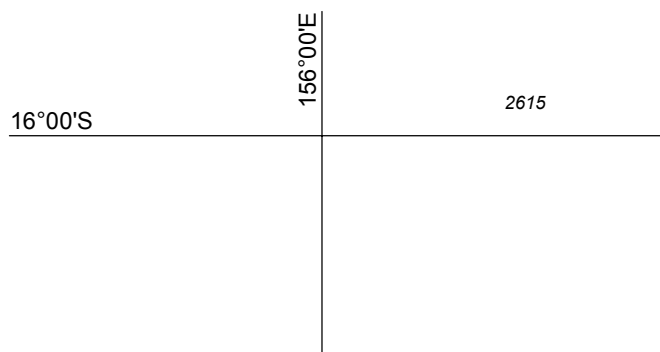

07°04·00'S

8/6M ← *In lieu* ✕

1605

208  
157°30·00'E

Previous Notice 906/2018

NTM 952, 969/2018



AUS 4621  
(INT 621)

© Commonwealth of Australia 2018

1591

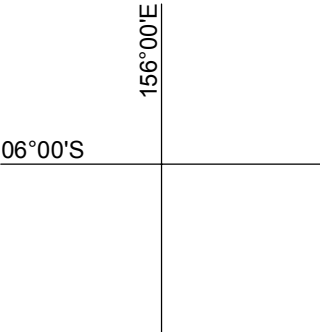

870

8/6M ← *In lieu* X





8/6M ← *In lieu*

208

158°00'E

08°00'S

623

*Previous Notice NC 11/8/2017*

NTM 969/2018



AUS 4623  
(INT 623)

© Commonwealth of Australia 2018

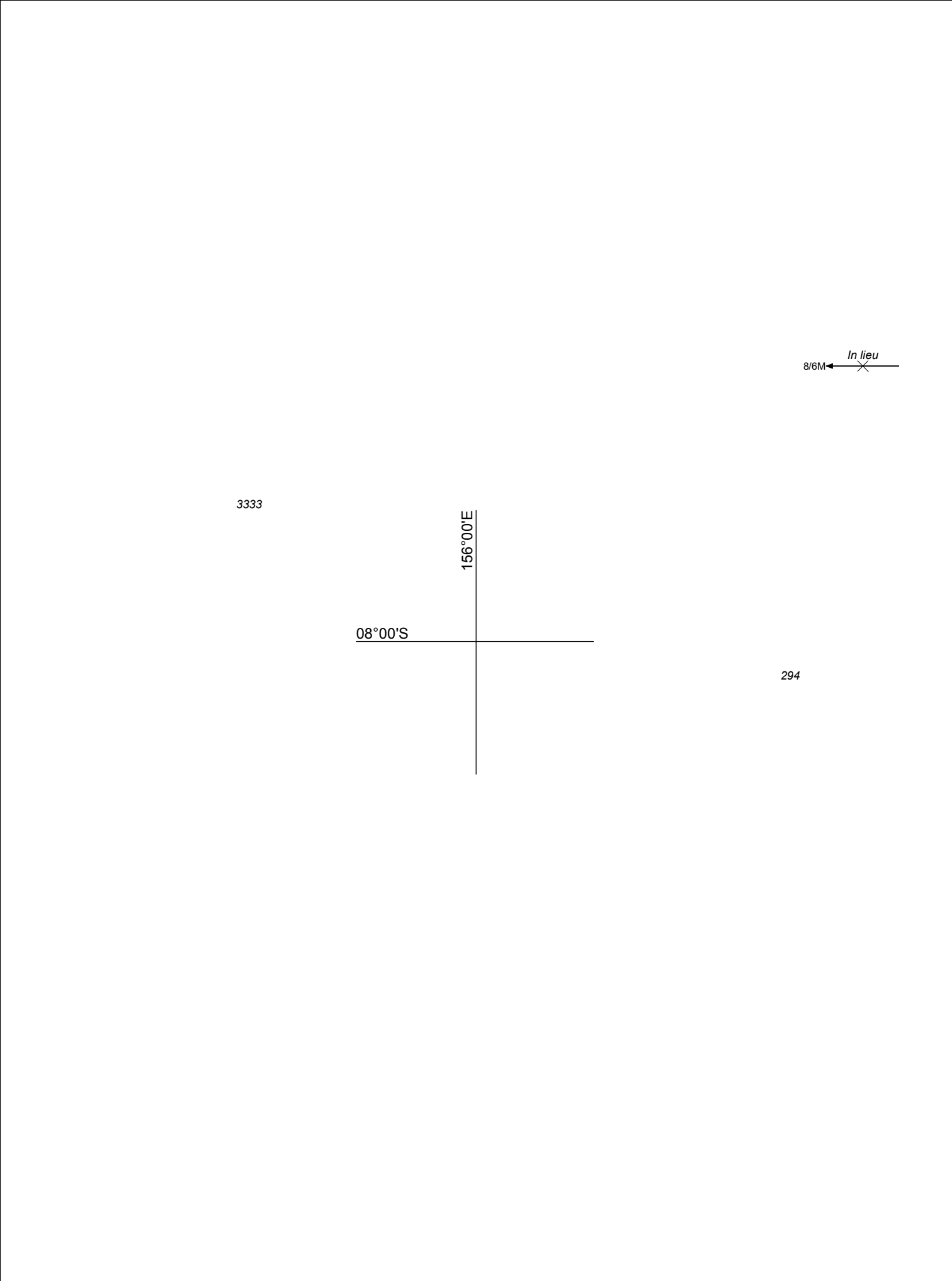

6

07°00S

156°58.82E

8/6M ← *In lieu* X →

80



157°00'E

07°00S

33

42

8/6M ← *In lieu* X

80

Previous Notice 920/2018

NTM 969/2018



SLB 302

© Commonwealth of Australia 2018