

30° 15'S

153° 15'E

77

31

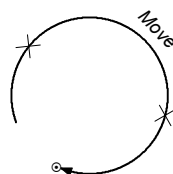

Previous Notice 773/2017

NTM 187/2018



AUS 812

© Commonwealth of Australia 2018

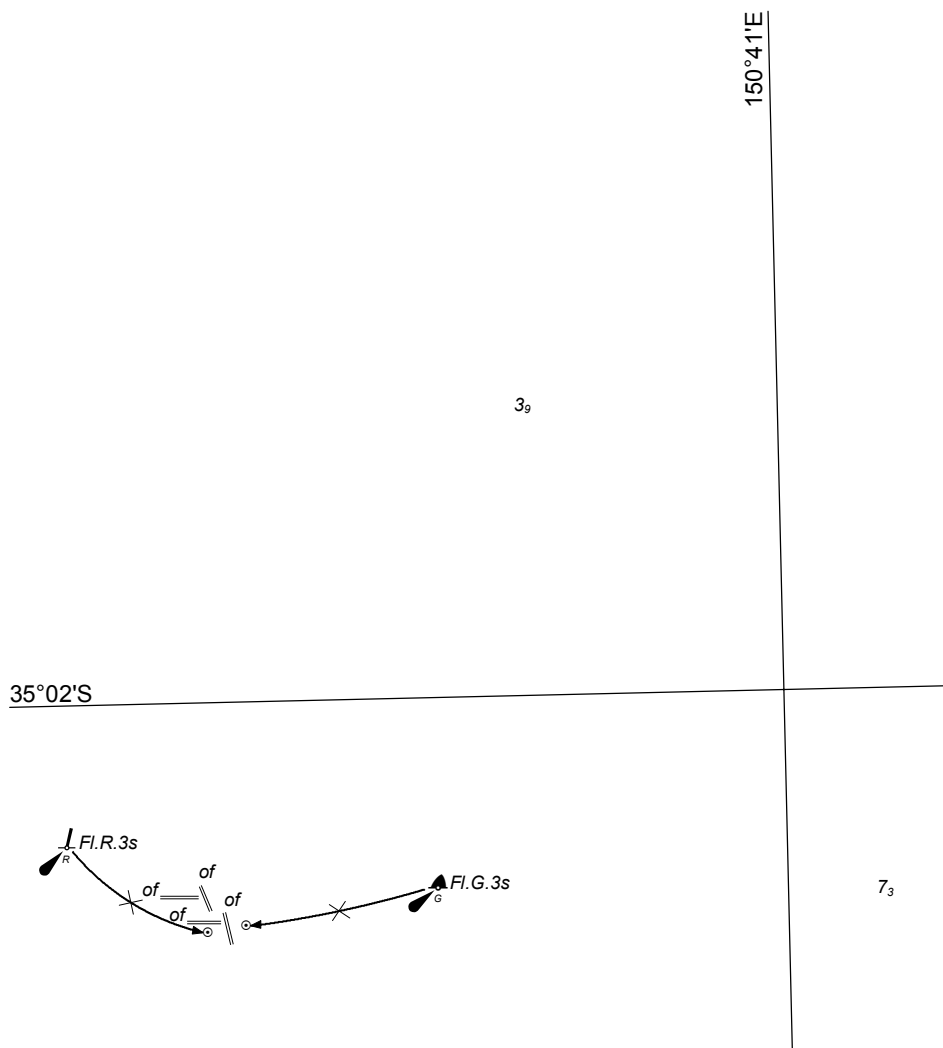

PLAN: HUSKISSON

Previous Notice 493/2017

NTM 188/2018



AUS 193

© Commonwealth of Australia 2018

33°50'S

6<sub>8</sub>

151°16'E

5<sub>8</sub>

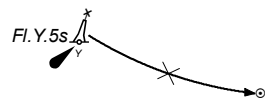

151°16'E

1<sub>8</sub>

33°49'S

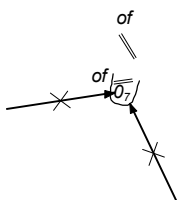

13<sub>4</sub>

Previous Notice 49/2018

NTM 189, 190/2018



AUS 201

© Commonwealth of Australia 2018

153°15'E

 $10_3$ 

27°00'S

*of*

 $7_3$ 

27°23'S

153°09'E

1<sub>2</sub>

of  
In lieu  
14.3m

2

Previous Notice 1062/2017

NTM 192/2018



AUS 237

© Commonwealth of Australia 2018

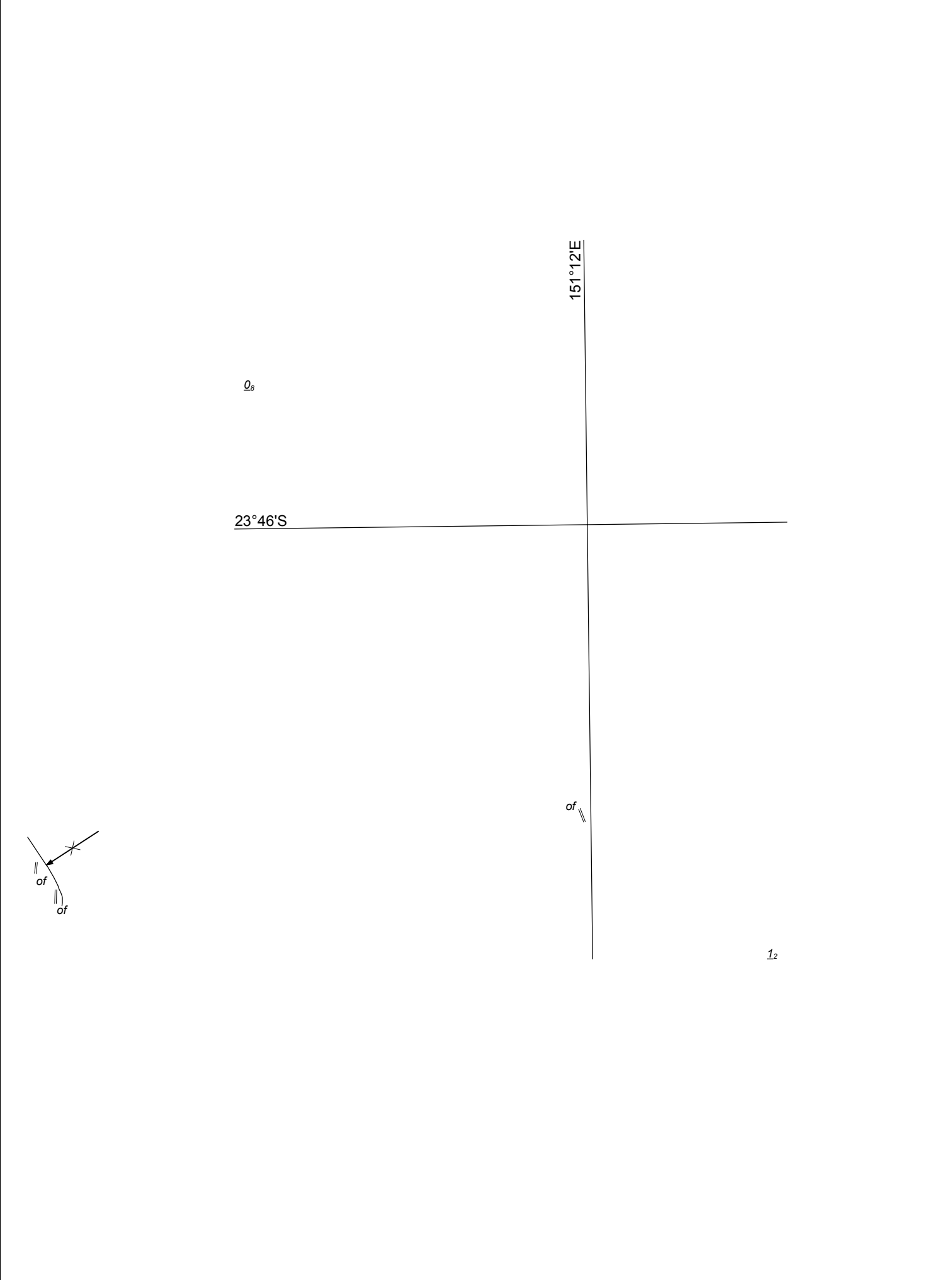

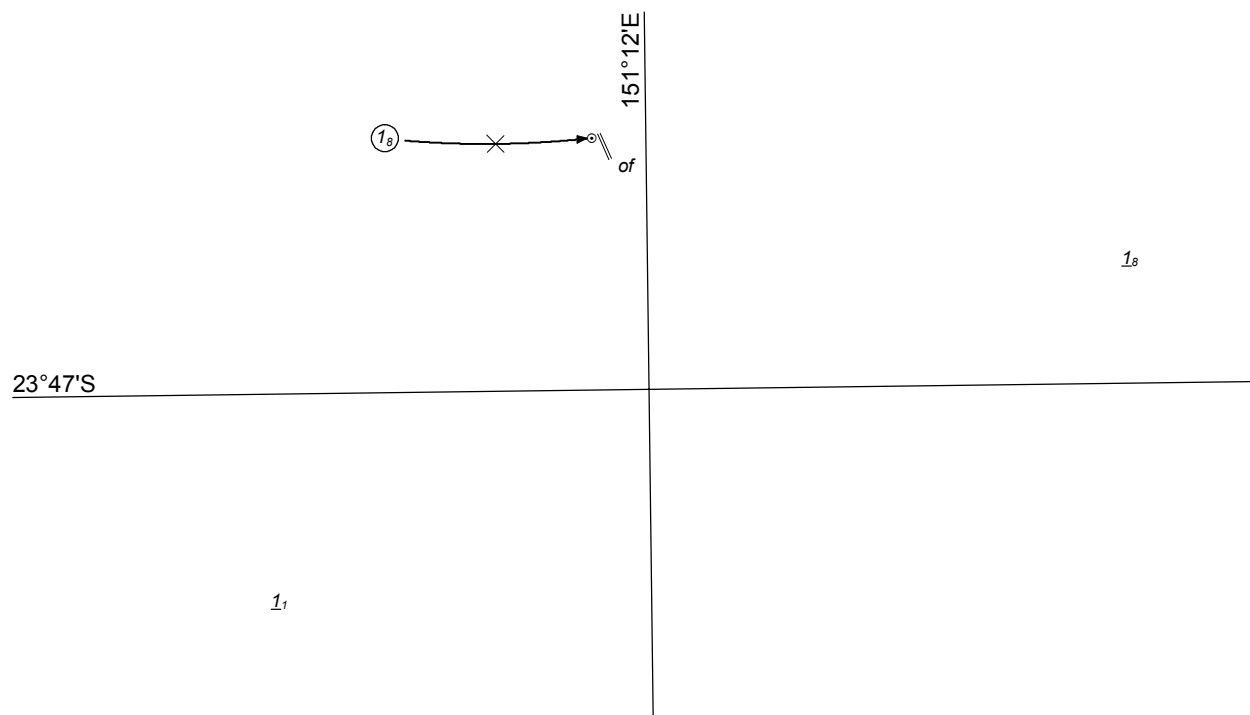
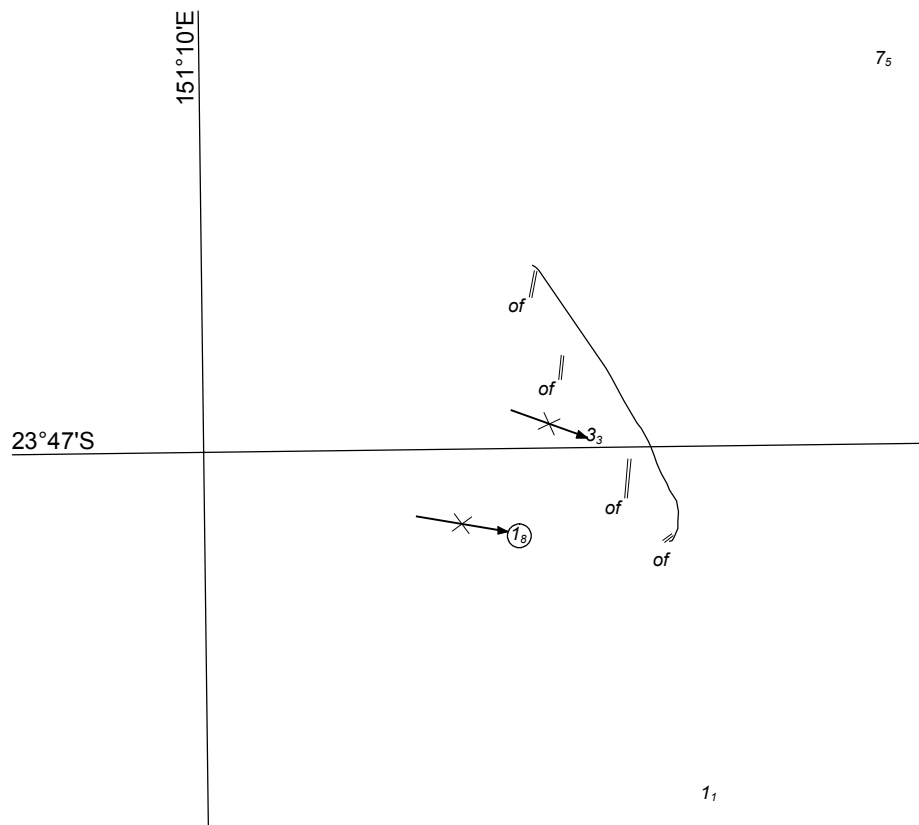

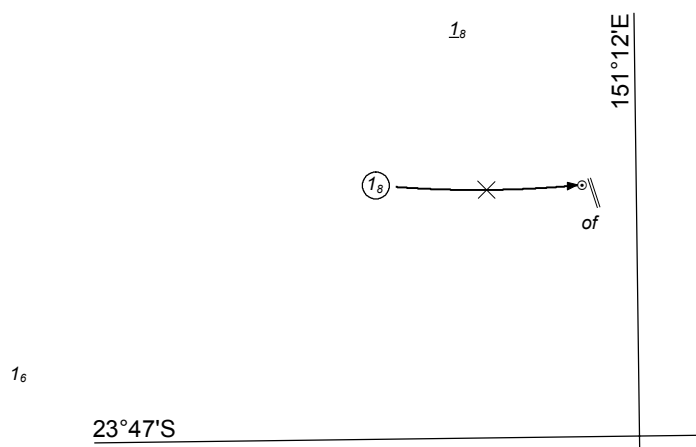
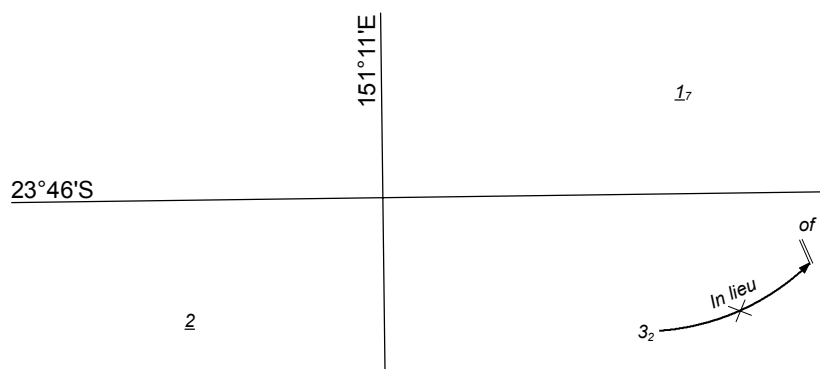
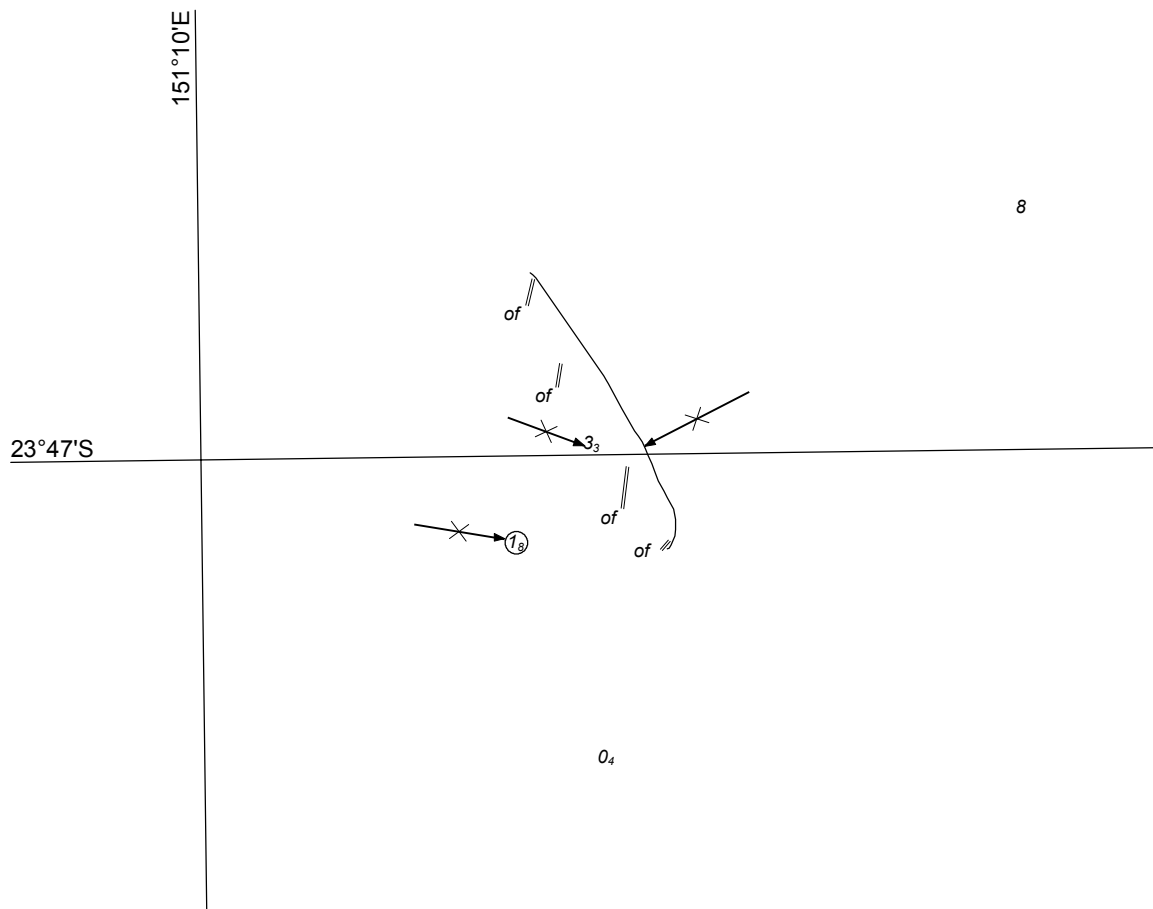

1<sub>7</sub>

153°25'E

27°58'S

R

*In lieu*

*of*

X  
Y

3

*Previous Notice 52/2018*

NTM 194/2018



AUS 230

© Commonwealth of Australia 2018

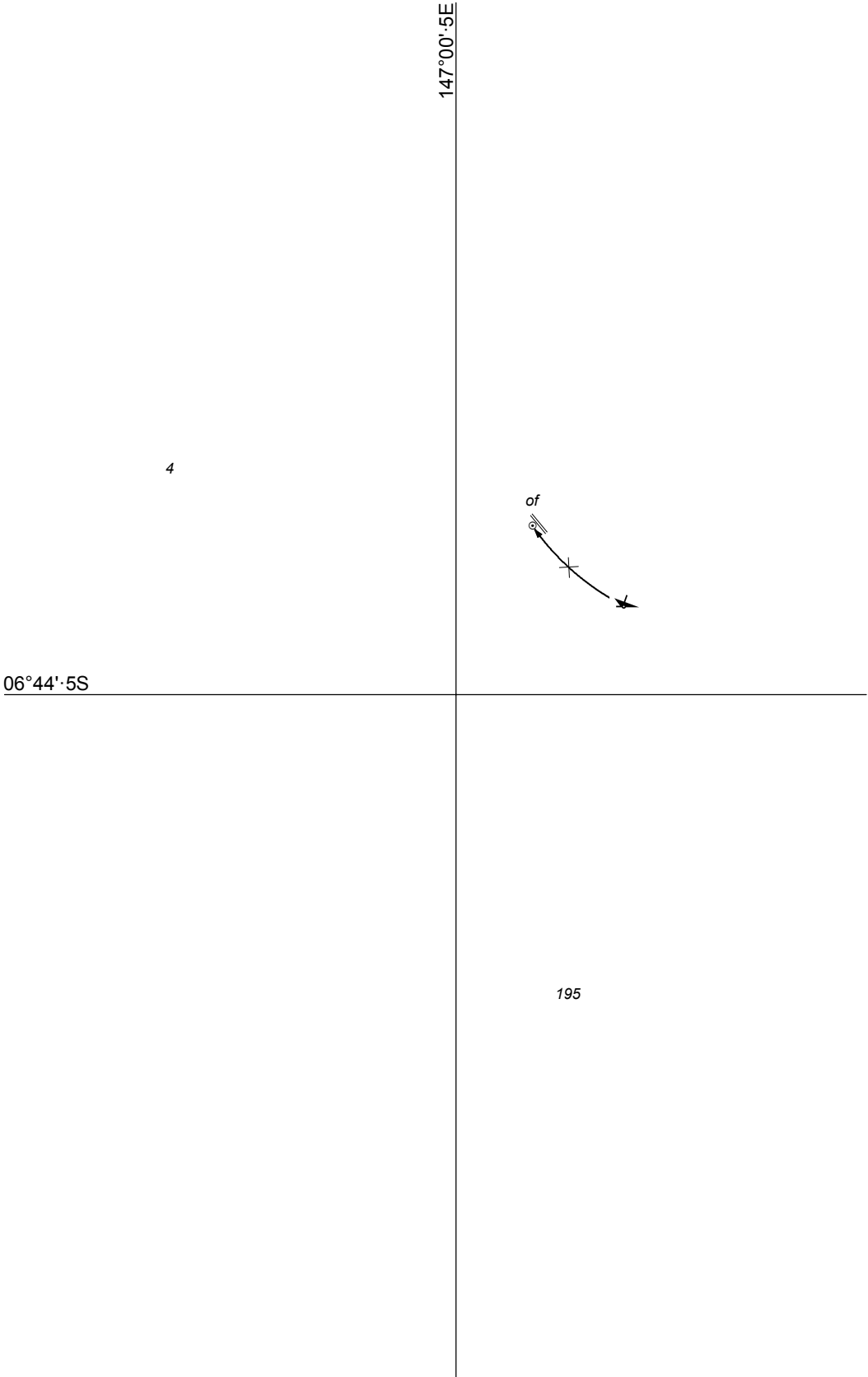

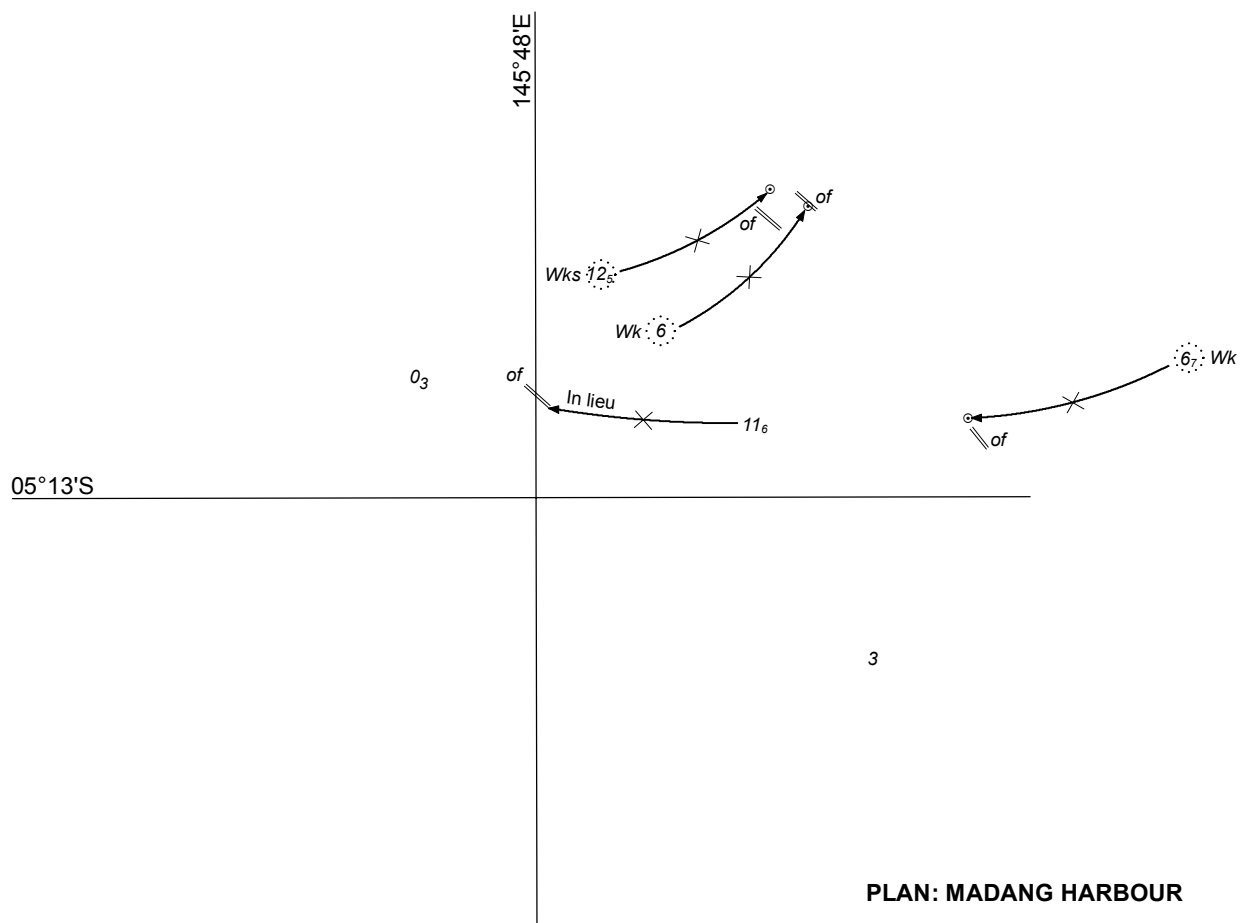
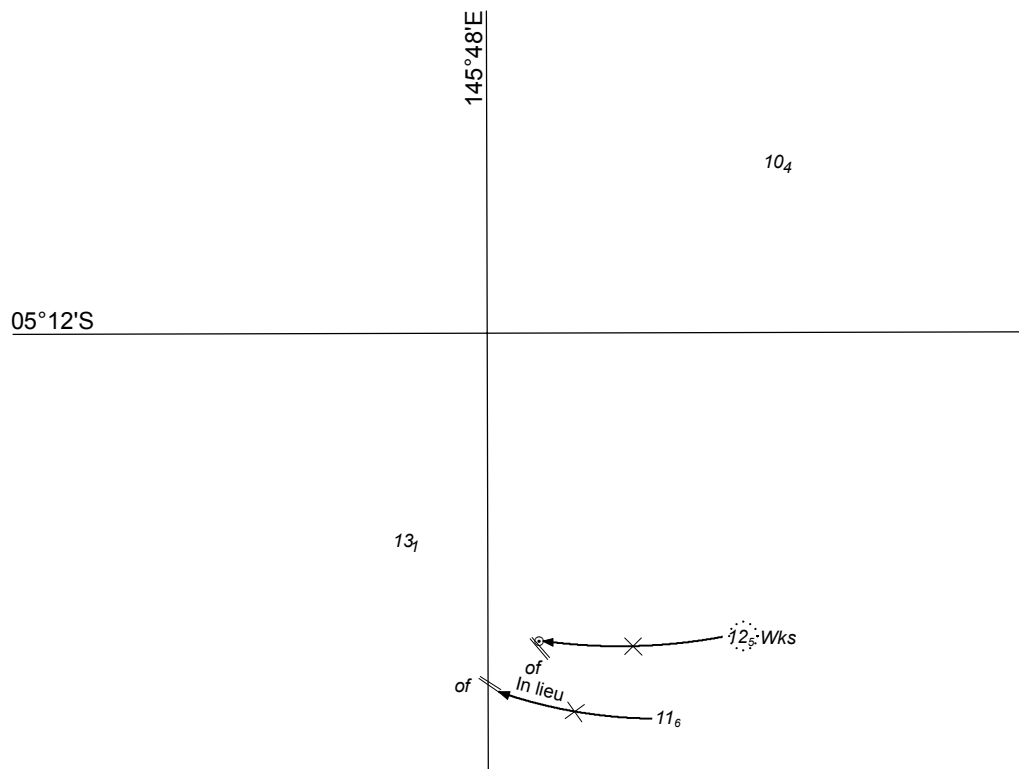

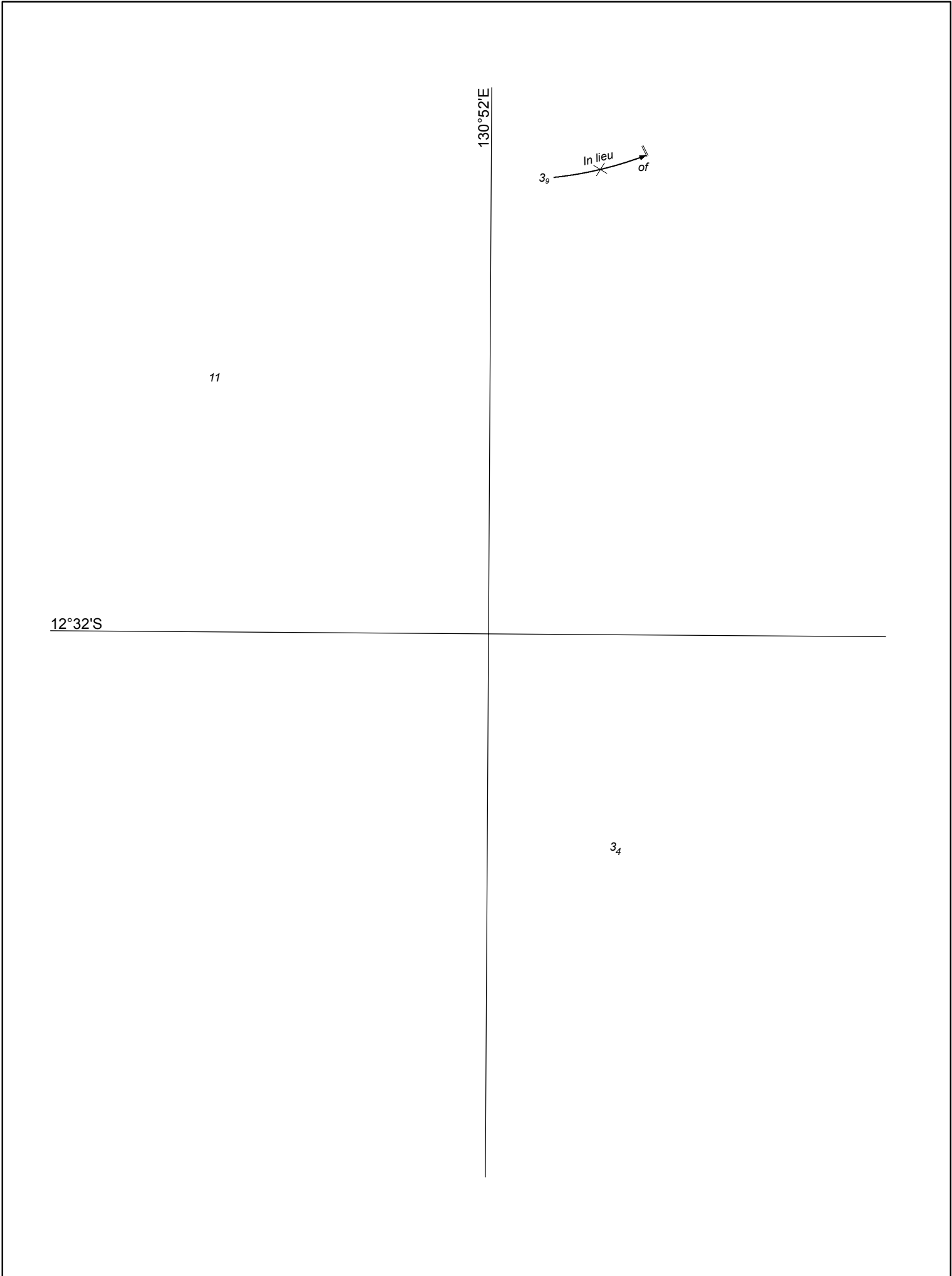

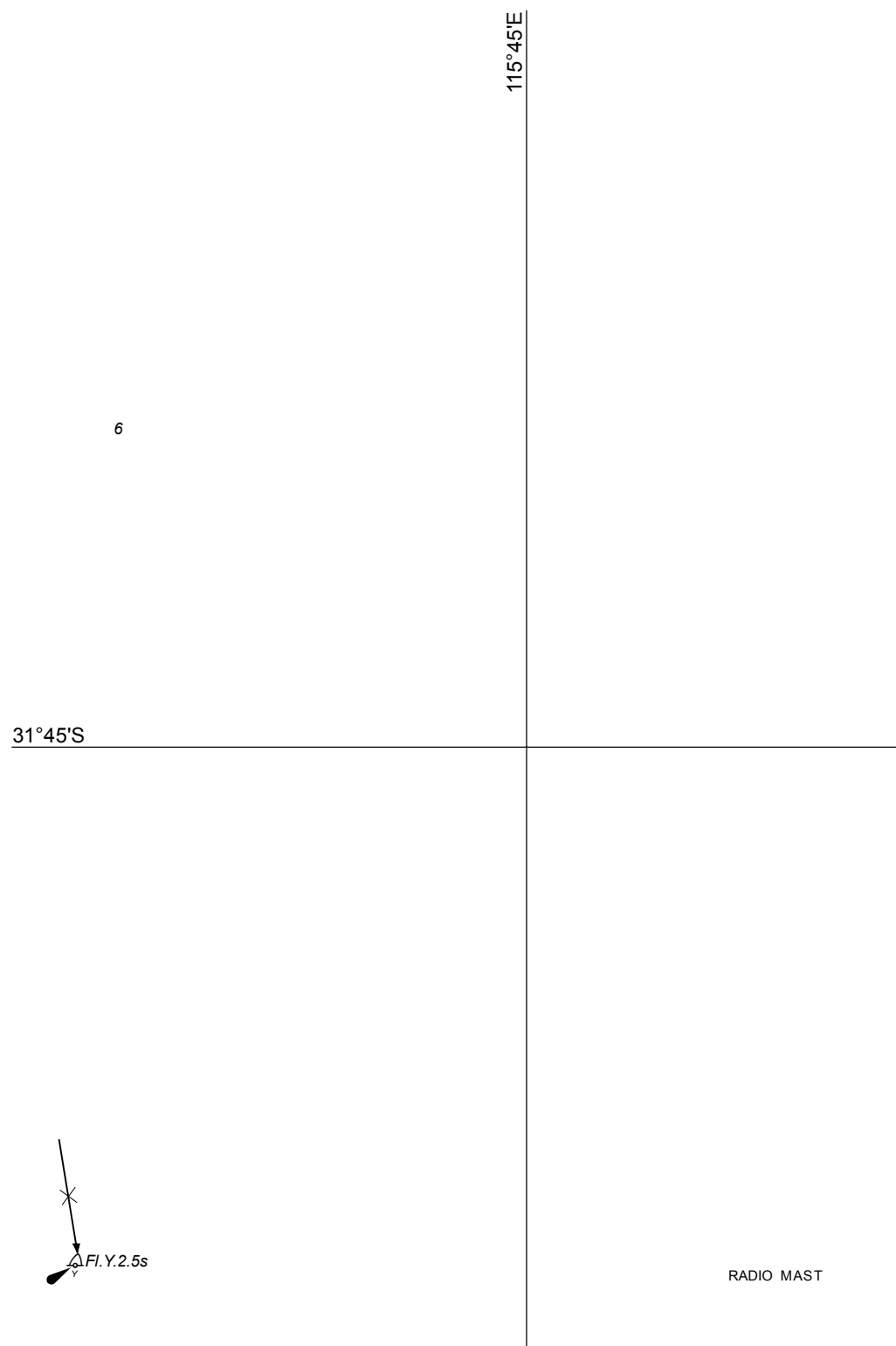

118°29·07'E

Tidal

20°19·90'S

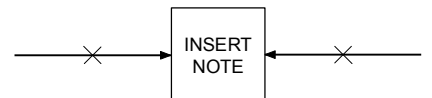

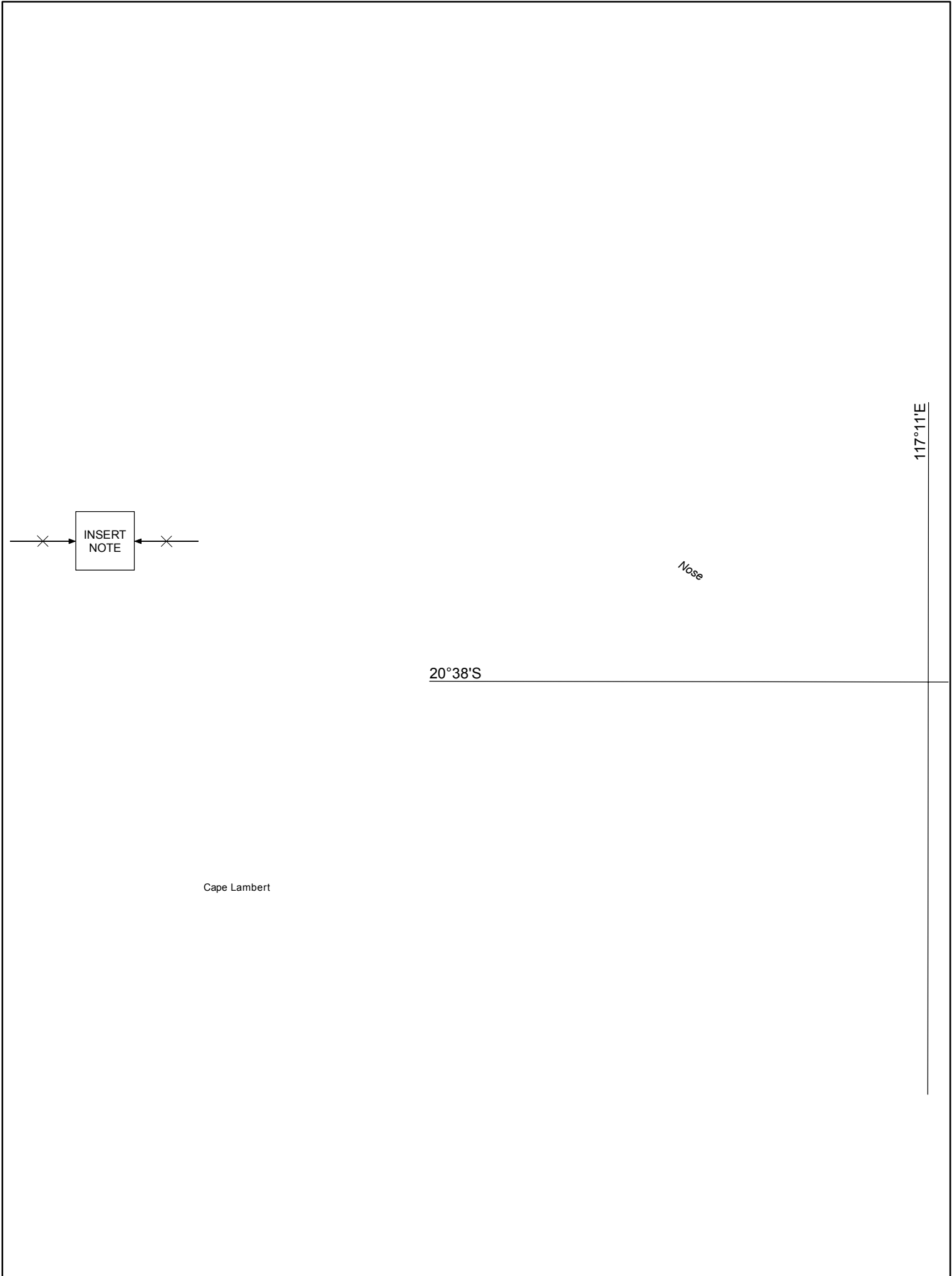

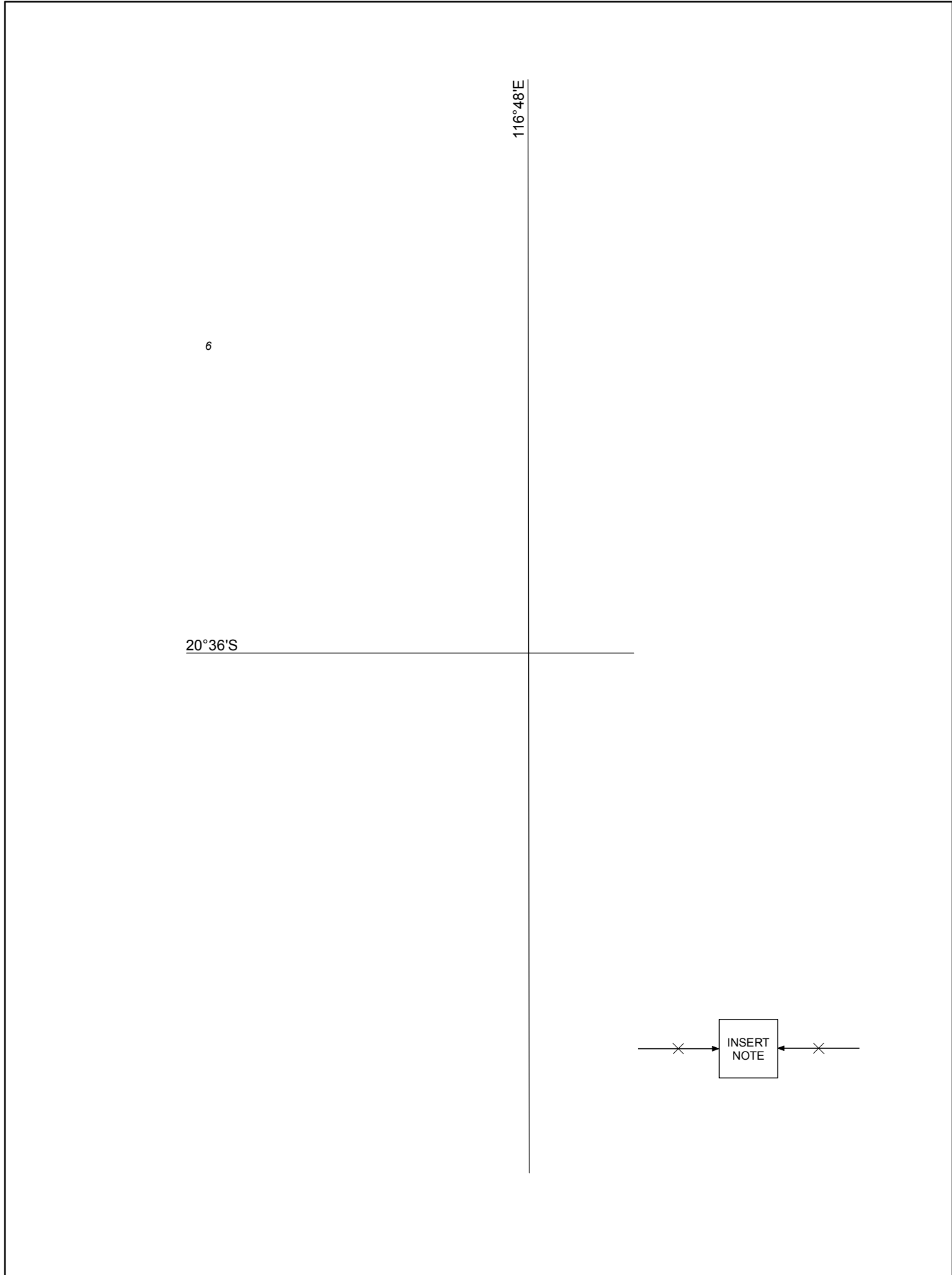

115°28'E

$Q_6$

20°48'S

INSERT  
NOTE

$1_1$



— × —→ INSERT NOTE ← × —

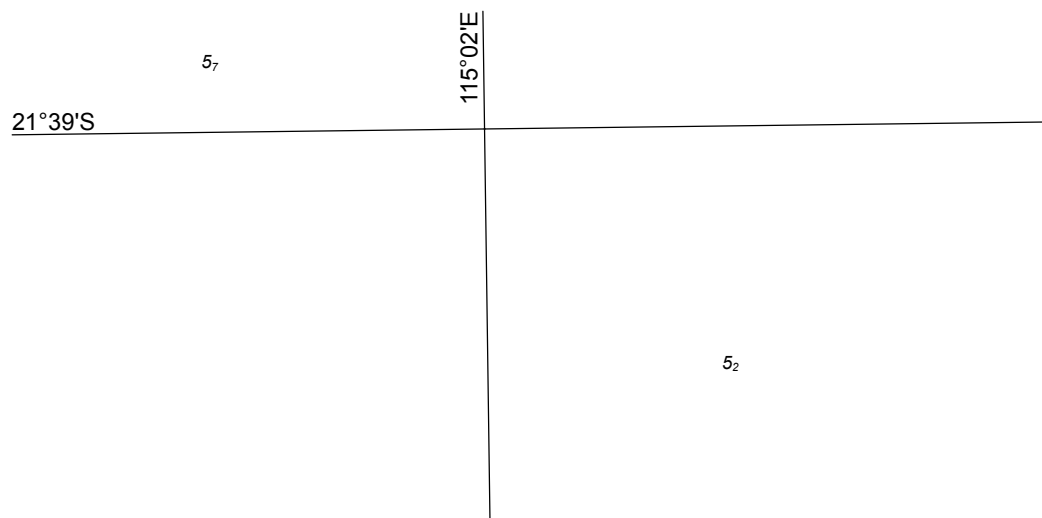

PLAN: PORT OF ASHBURTON

Previous Notice 862/2017

NTM 200/2018



AUS 69

© Commonwealth of Australia 2018

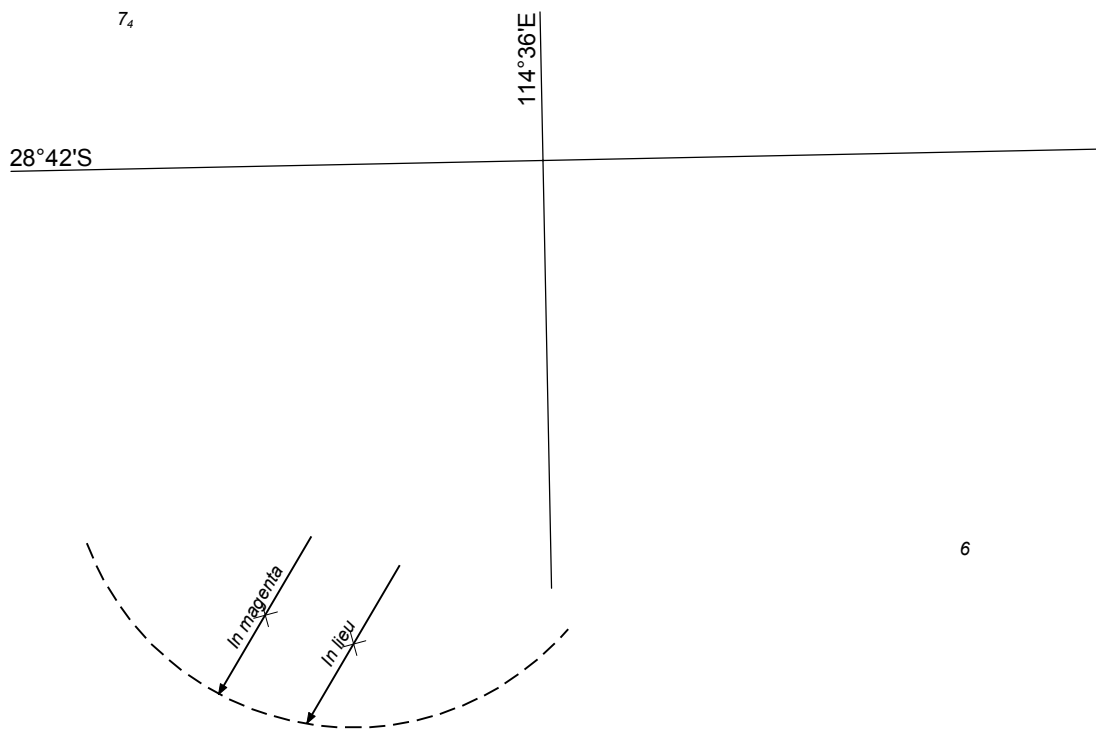

✕ → INSERT NOTE ← ✕

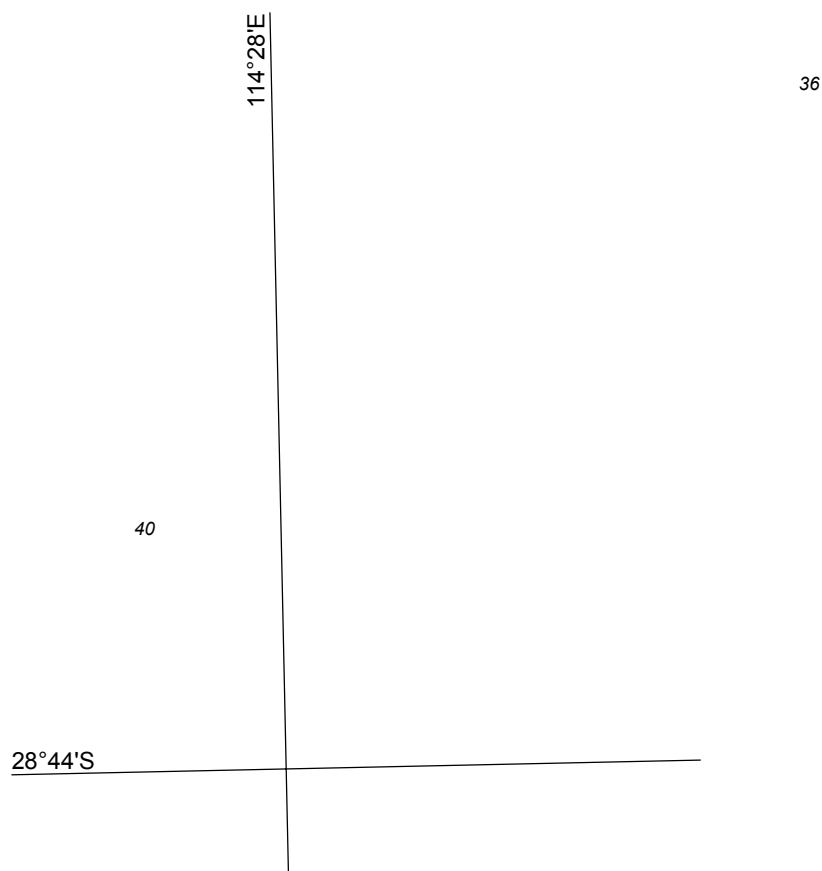

TIDAL

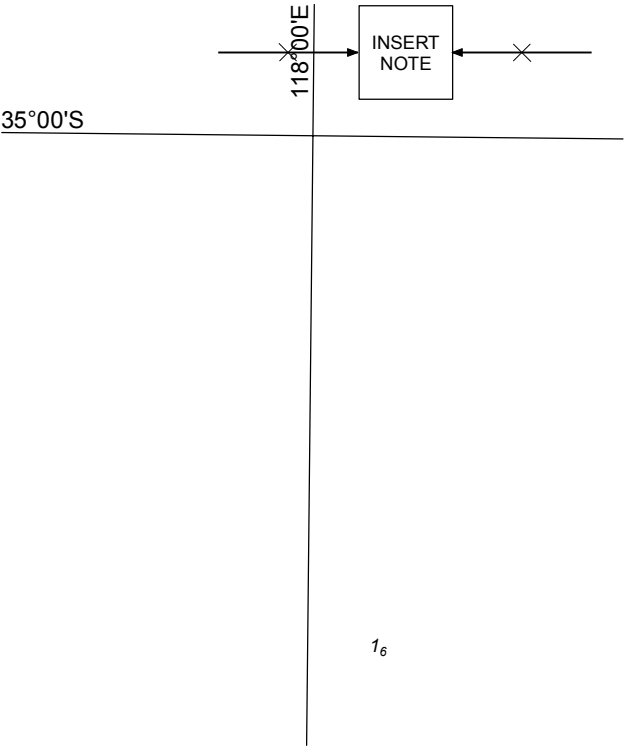

1<sub>6</sub>

H A R B O U R

115°45'E

32°03'S

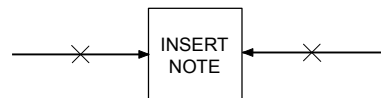

Previous Notice 9/2018

NTM 200/2018



AUS 113

© Commonwealth of Australia 2018

33°19'S

115°40'E

3<sub>2</sub>

5<sub>4</sub>

— × —→ INSERT NOTE ←— × —

PLAN: PORT OF BUNBURY

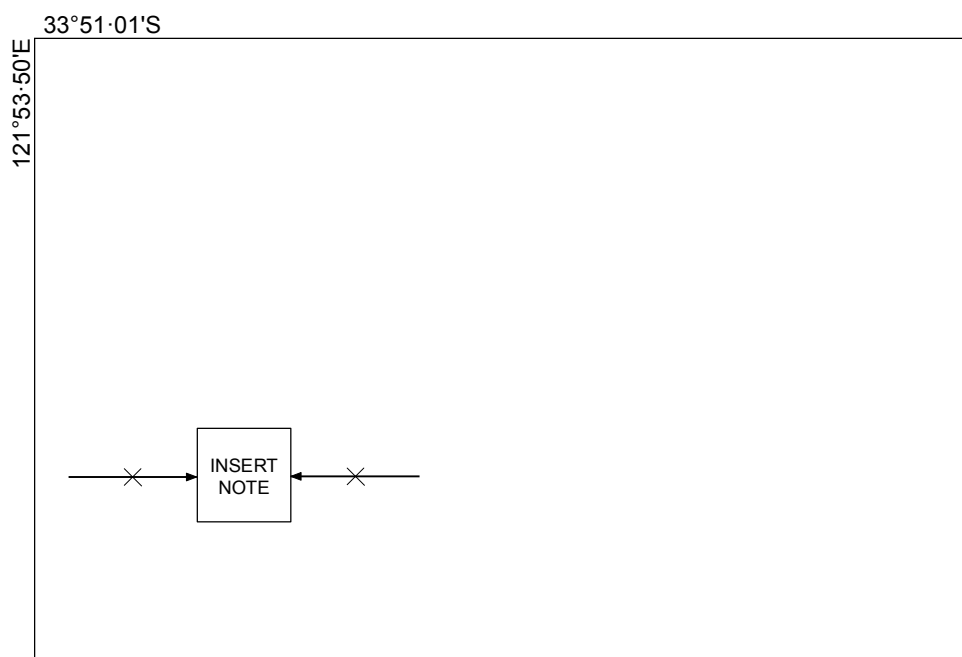

**PLAN: ESPERANCE**

*Previous Notice 551/2017*

NTM 200/2018



AUS 119

© Commonwealth of Australia 2018

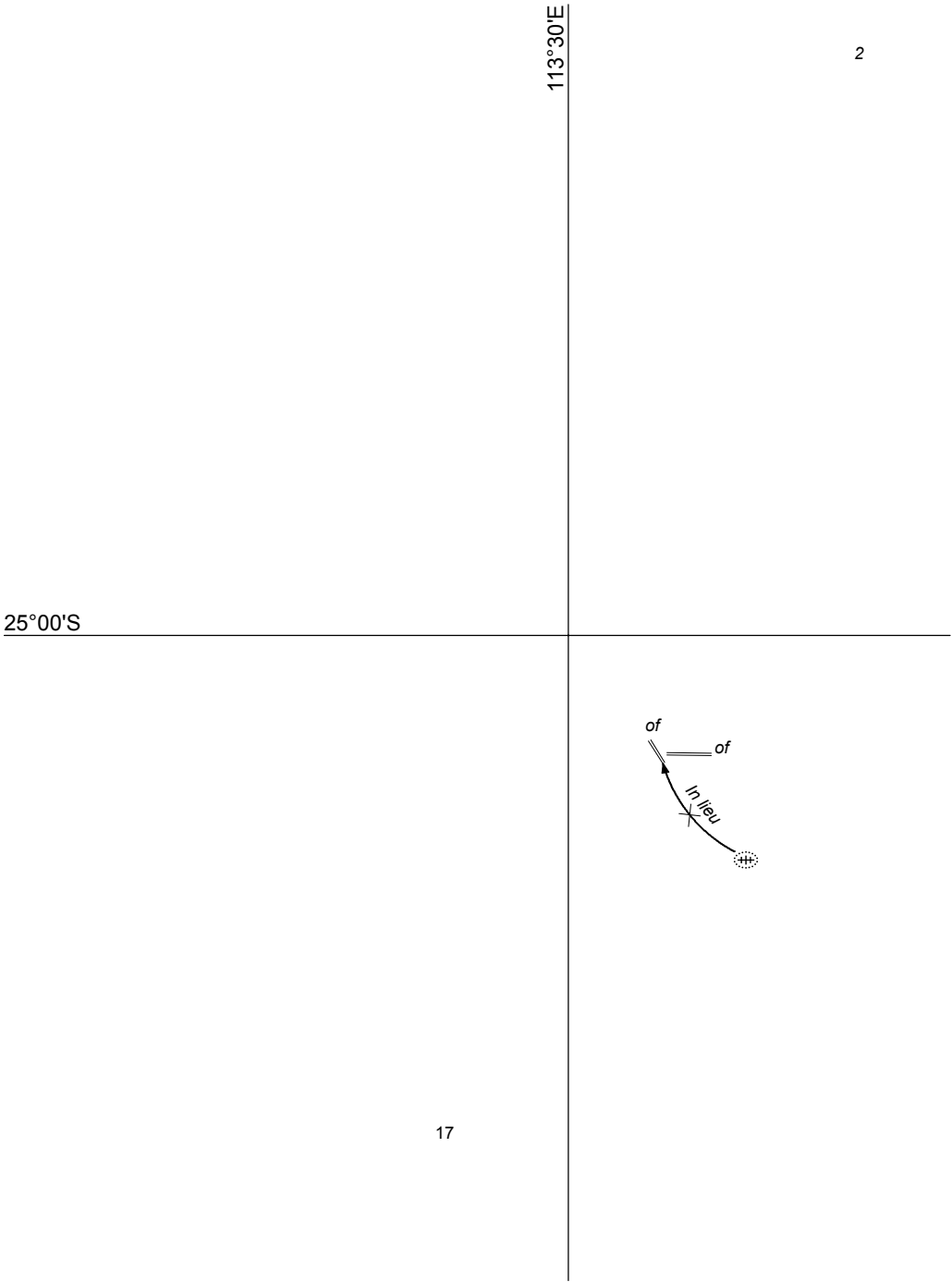

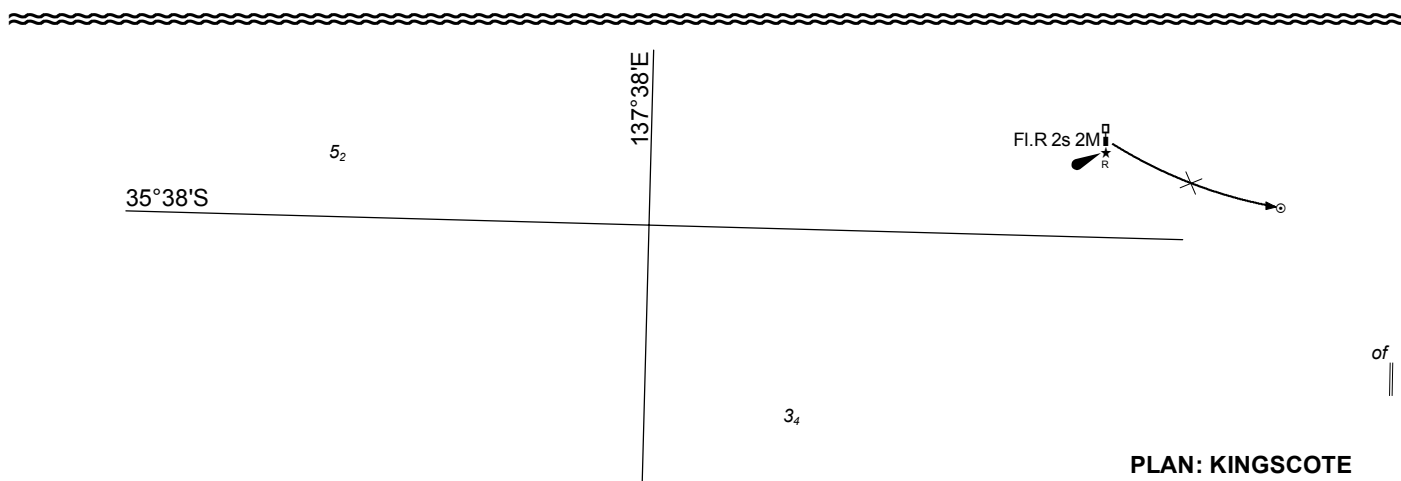
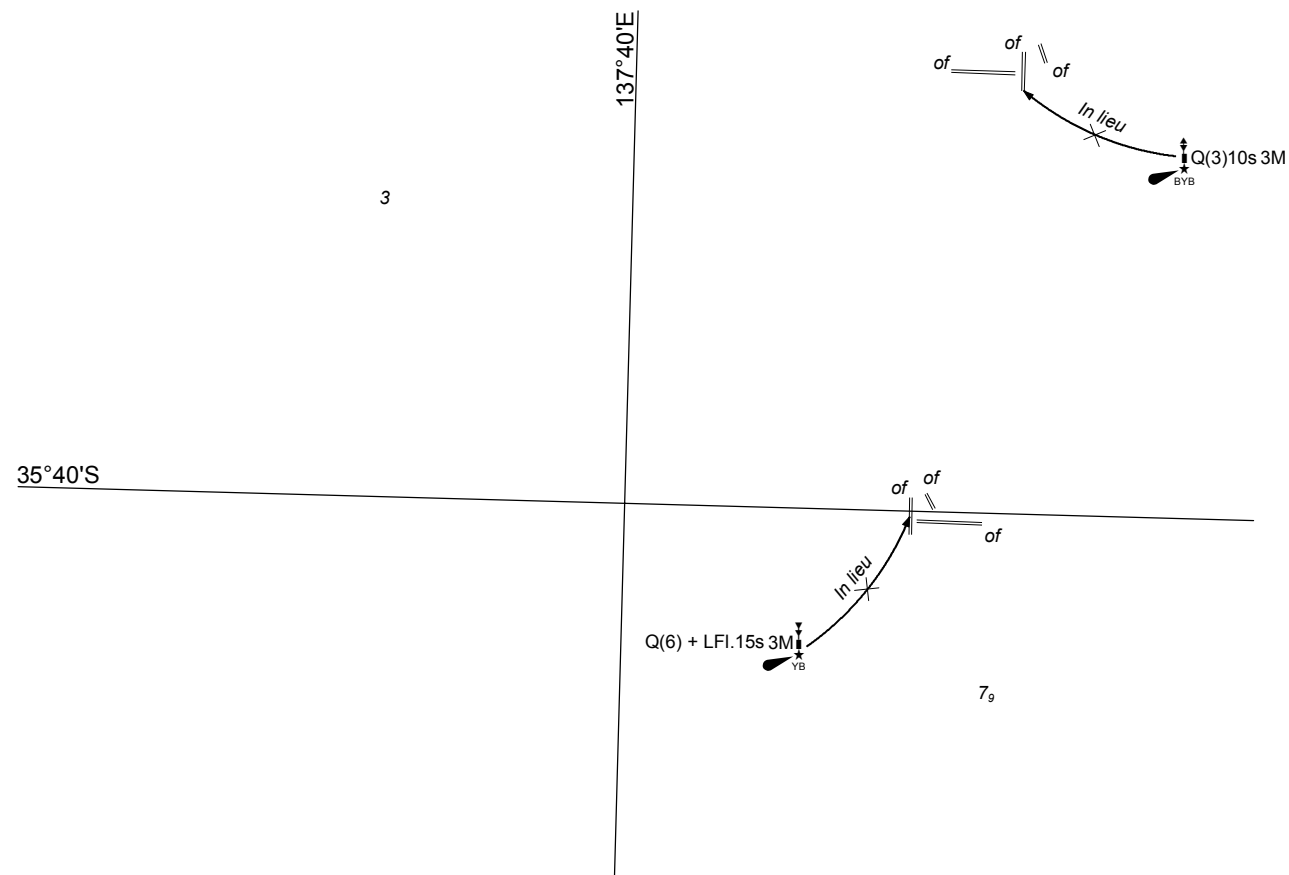

PLAN: KINGSCOTE

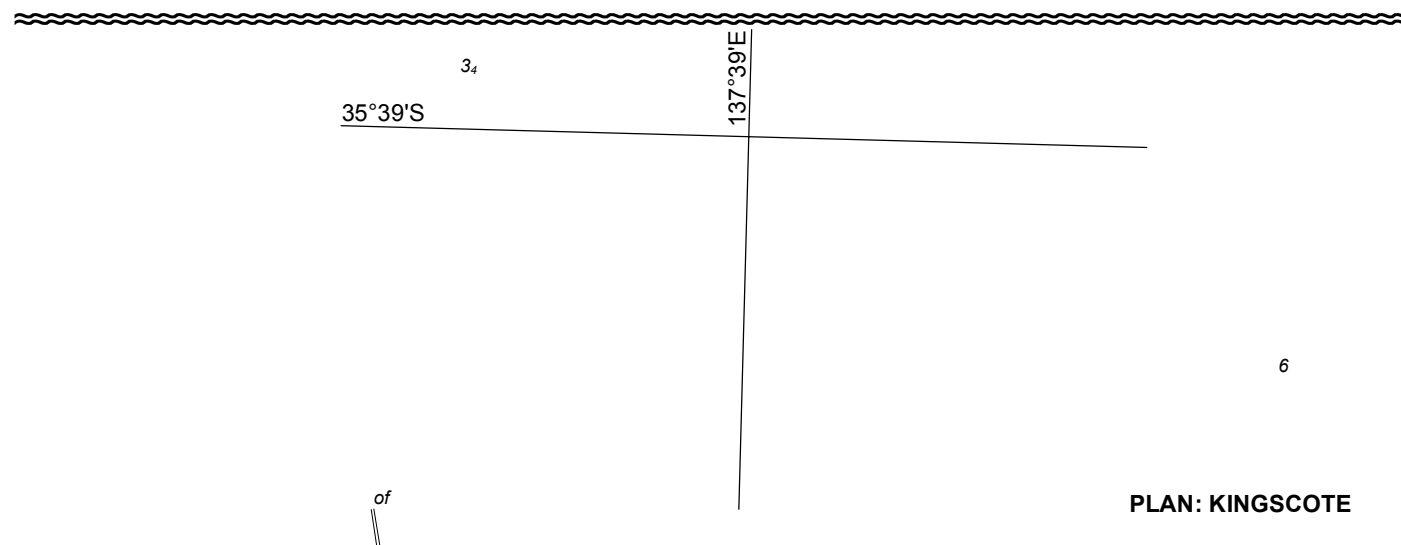

PLAN: KINGSCOTE

of of  
of of  
of of

138°00'E

31

36°00'S

69

Previous Notice 155/2018

NTM 202/2018



AUS 485

© Commonwealth of Australia 2018

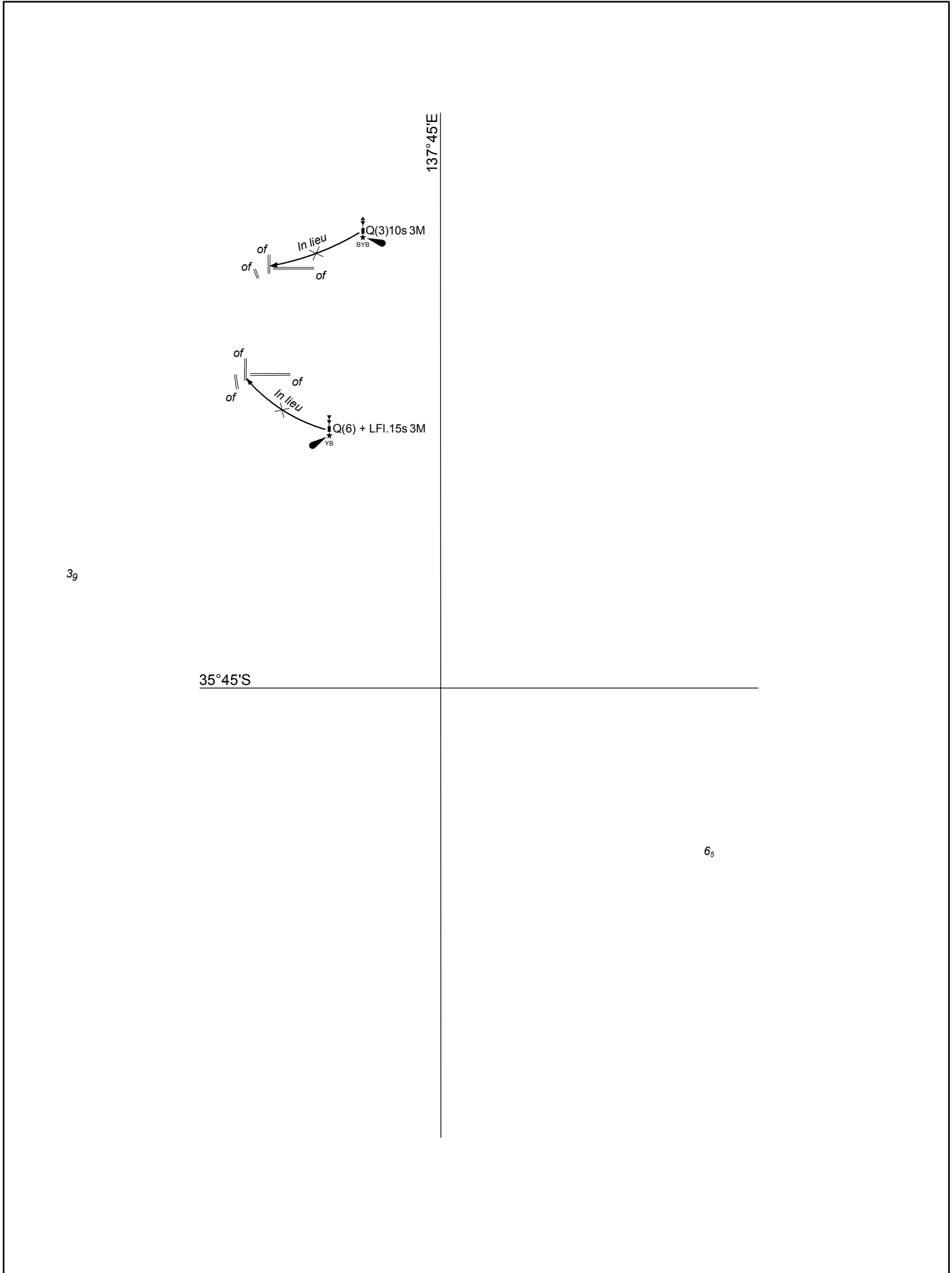

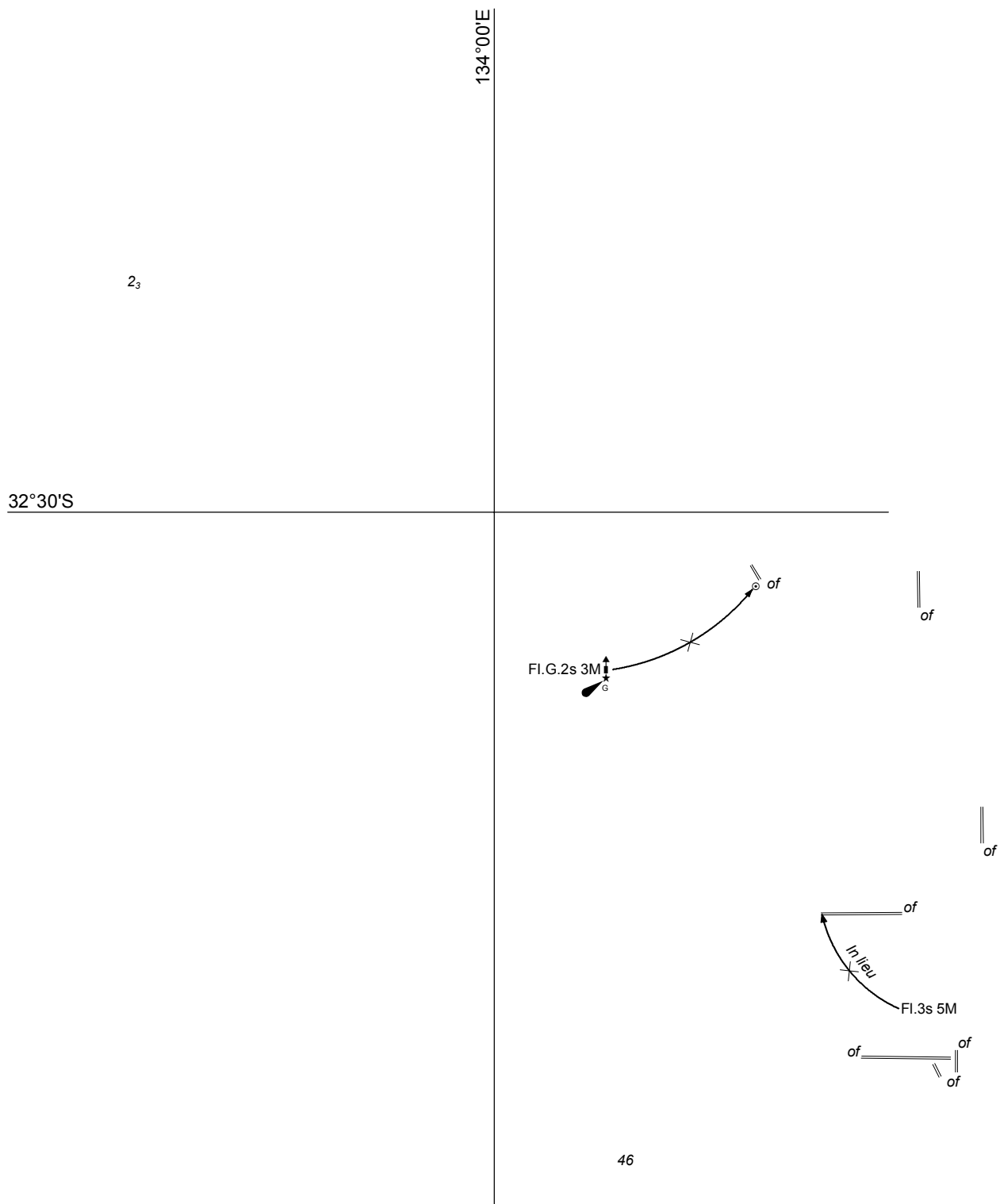

32°30'S

134°00'E

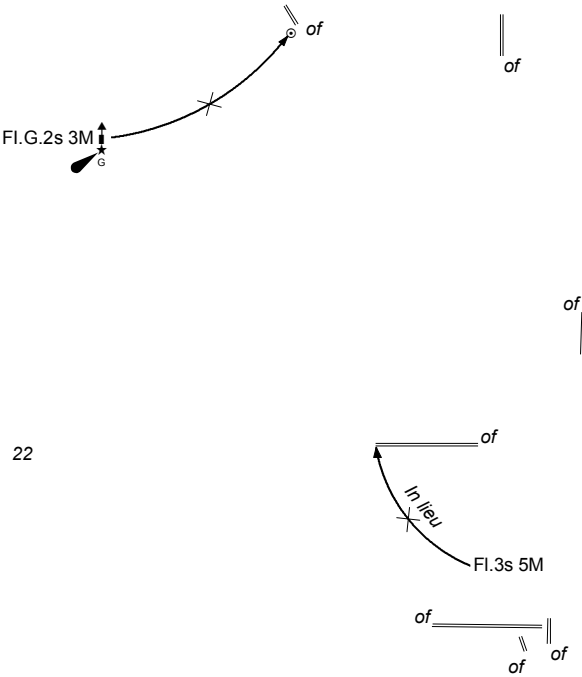

22



135°00'E

77

34°30'S

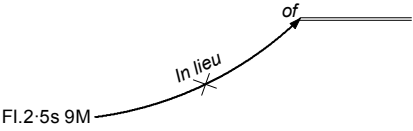

33



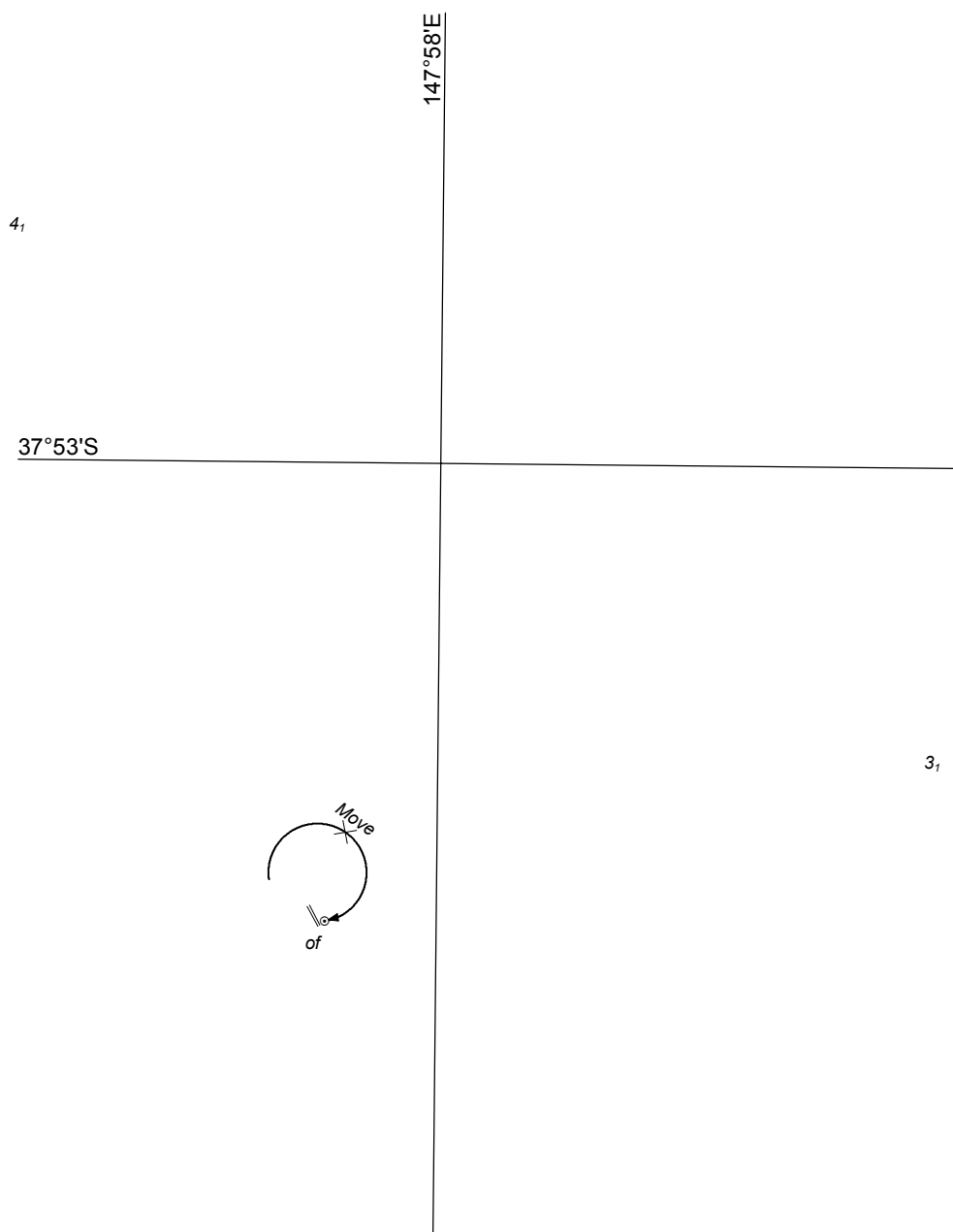

PLAN: LAKES ENTRANCE

Previous Notice 104/2018

NTM 204/2018



AUS 182

© Commonwealth of Australia 2018

38°30'S

145°20'E

3<sub>4</sub>

37

Rep (2018) 9<sub>R</sub> of

0<sub>6</sub>

145°22'E

38°34'S

28<sub>4</sub>

9<sub>R</sub> Rep (2018)

PLAN: EASTERN ENTRANCE TO WESTERN PORT

Previous Notice 105/2018

NTM 205/2018



AUS 150

© Commonwealth of Australia 2018

38°30'S

144°30'E

58

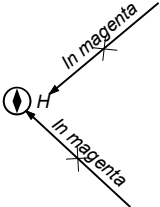

78



63

144°30'E

38°30'S

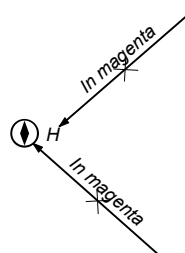

77



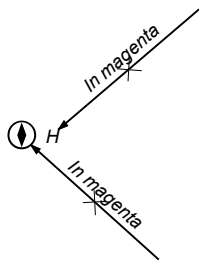

144°45'E

38

38°30'S

75



145°15'E

*Loelia Shoal*

38°30'S

53

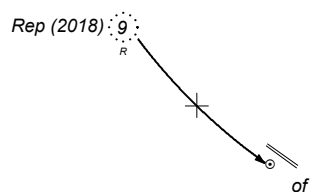

*Previous Notice 512/2017*

NTM 205, 206/2018



AUS 801

© Commonwealth of Australia 2018

