

09°28'S

147°04'E

9



10g

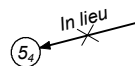
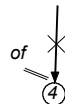
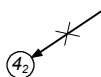
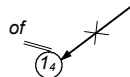

147°16'E

71

09°36'S

760



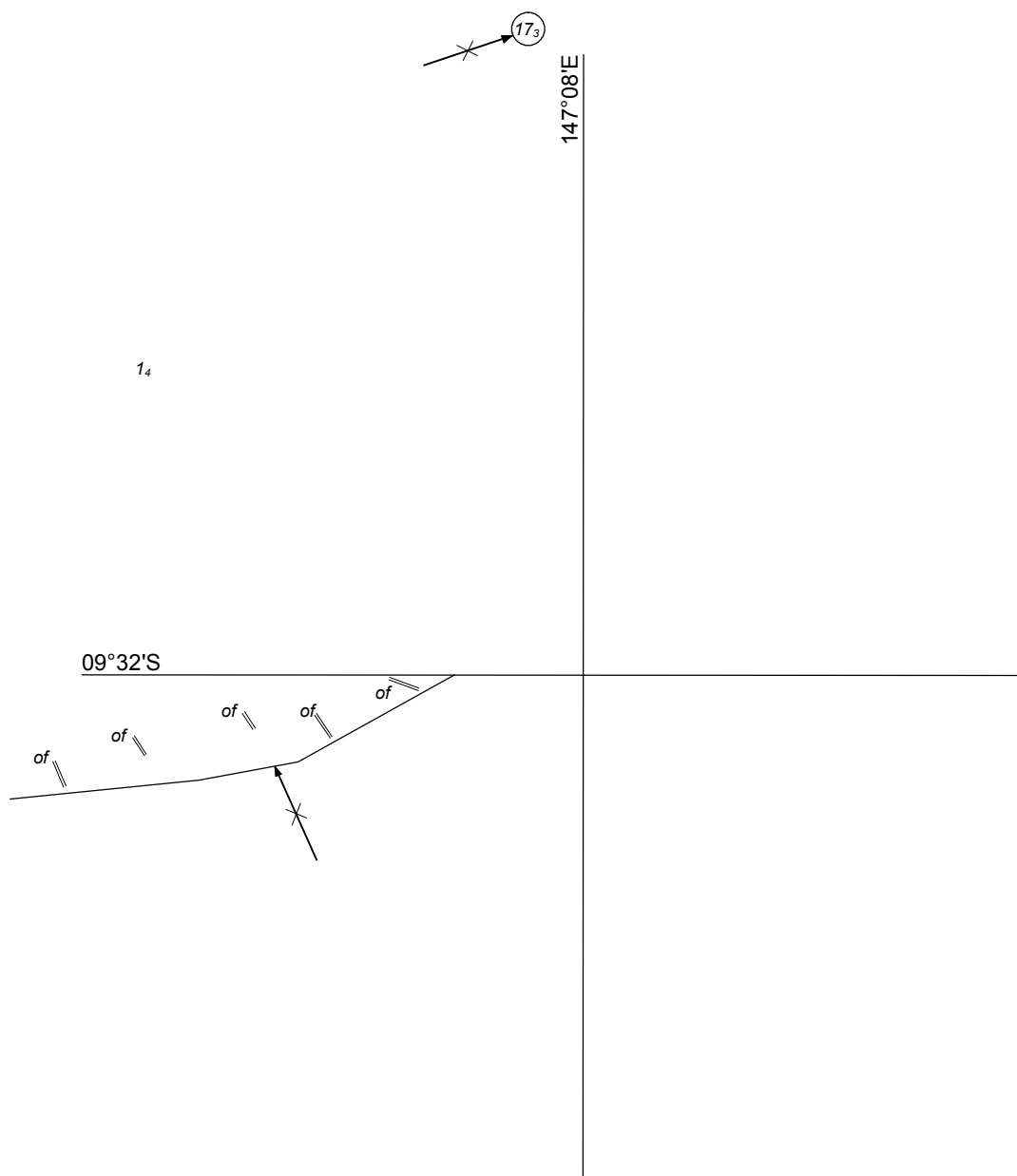

259



In lieu 10₈

In lieu 14₄

147°12'E

24

09°32'S

31

2₃





147°08'E

2

09°28'S

22

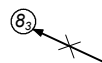

6

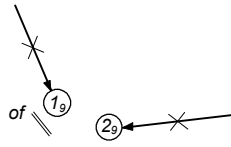

147°06'E

09°26'S

6₃



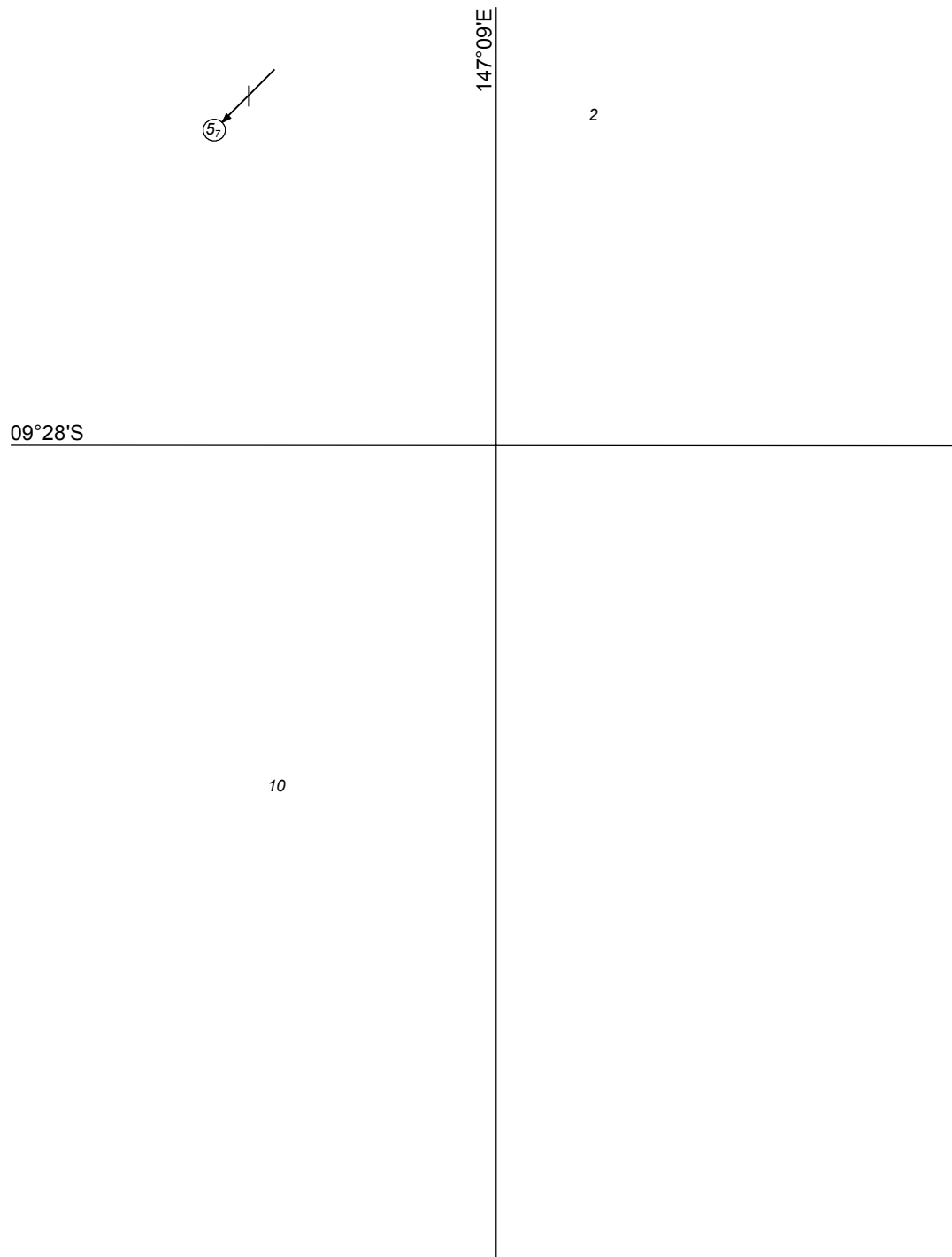

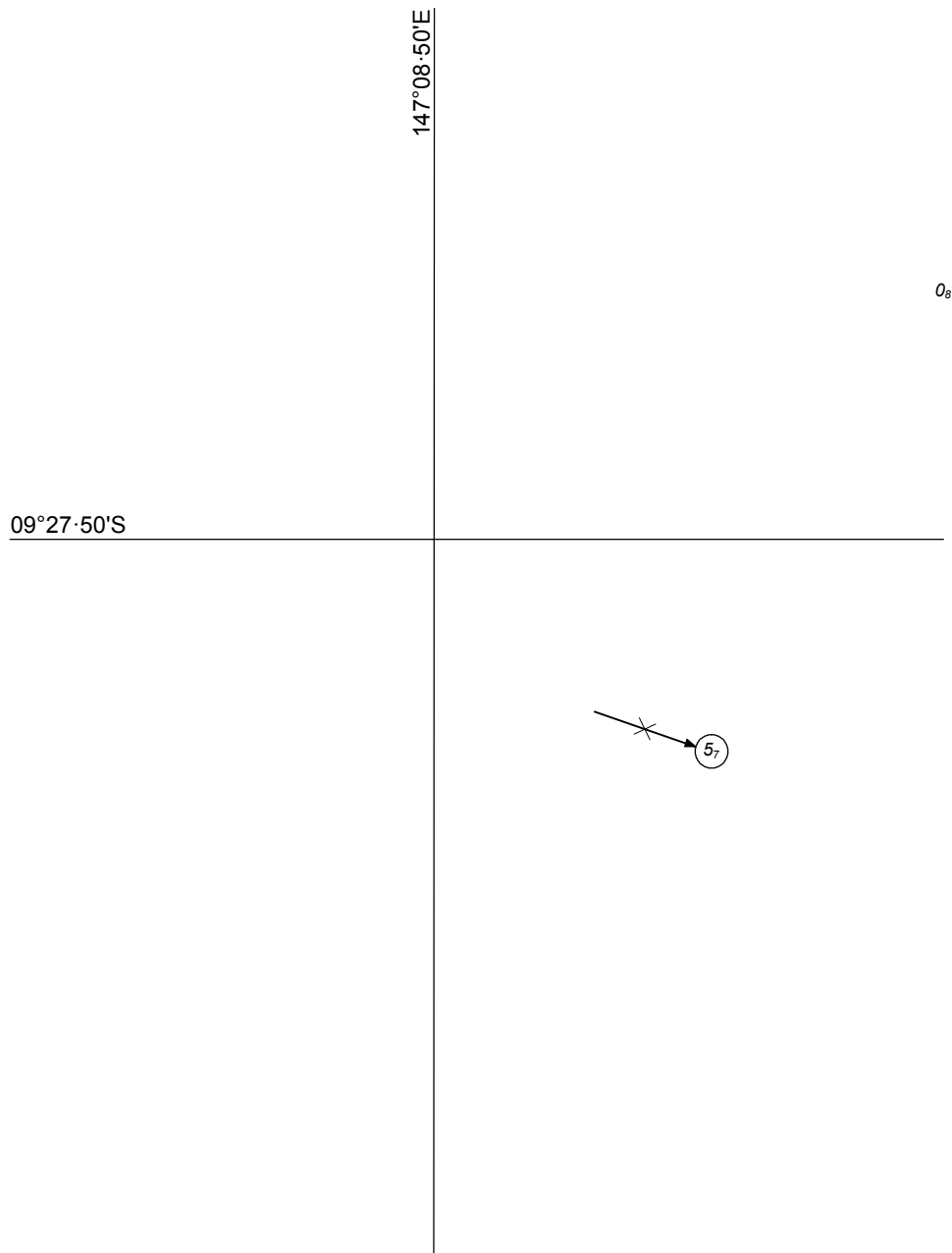

PLAN: PORT MORESBY AND NAPA NAPA WHARVES
Page 3 of 3

Previous Notice 779/2017

NTM 346/2018



AUS 622

© Commonwealth of Australia 2018

1₃

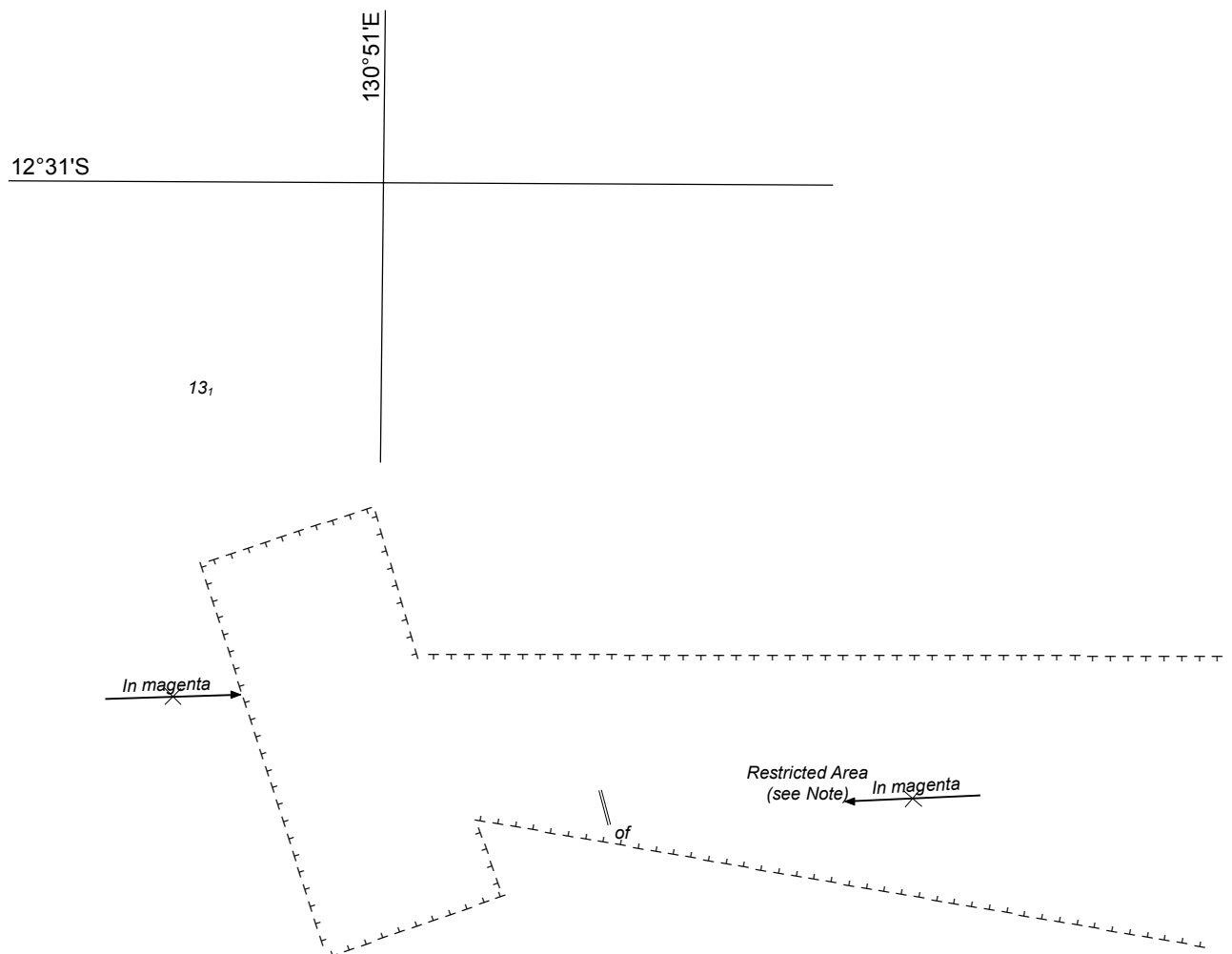

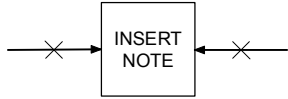

130°51'E

1₁

12°28'S

4₆



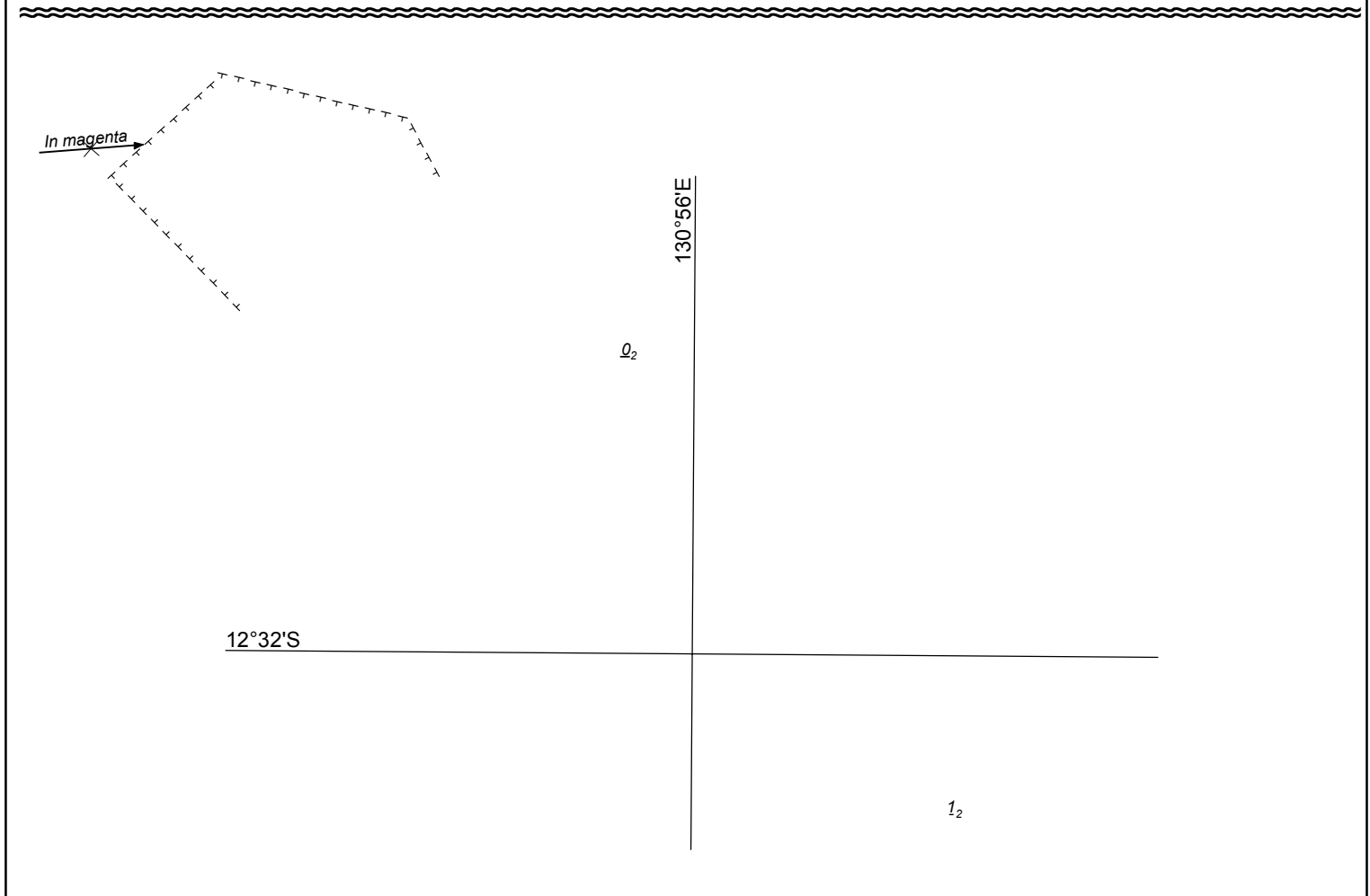
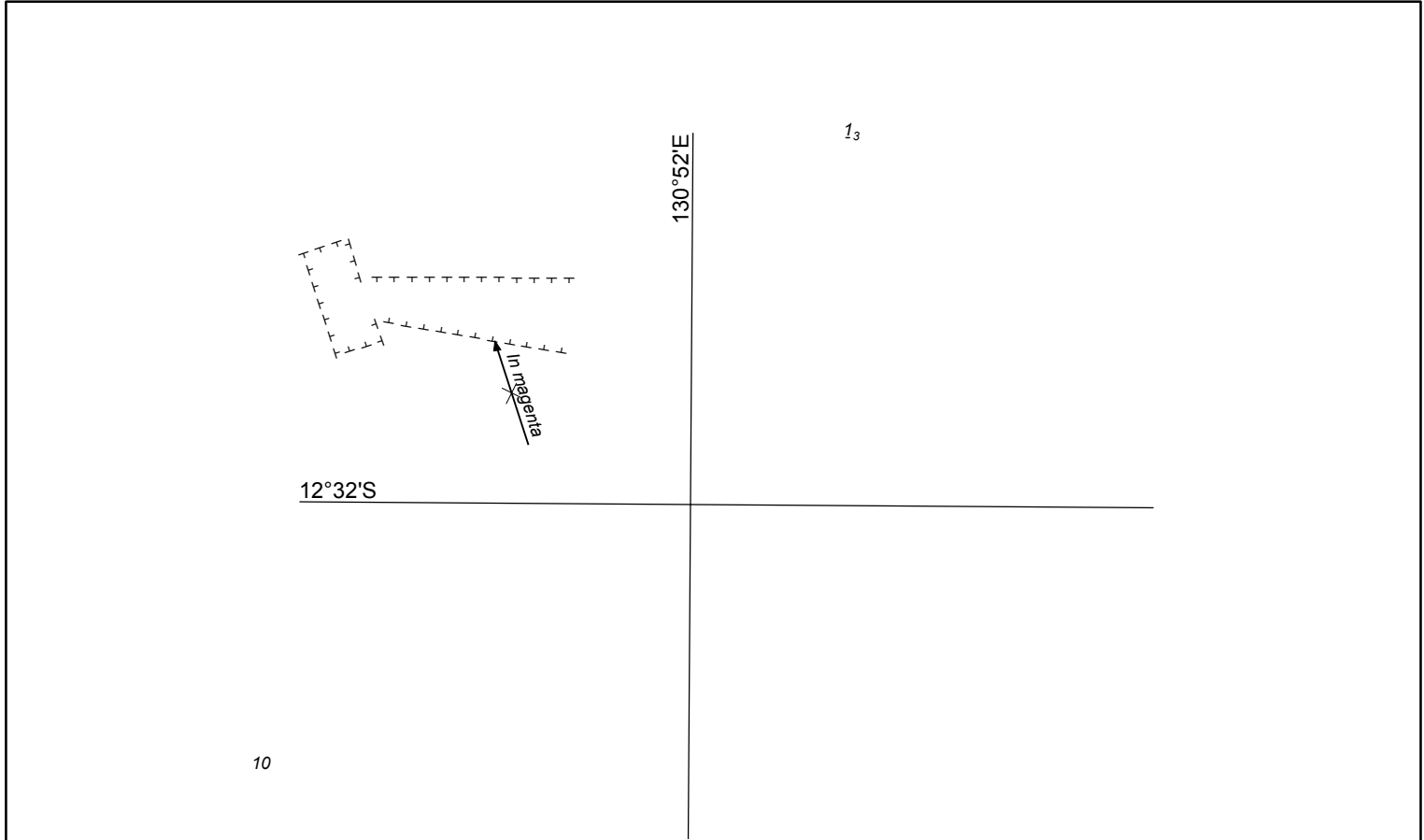

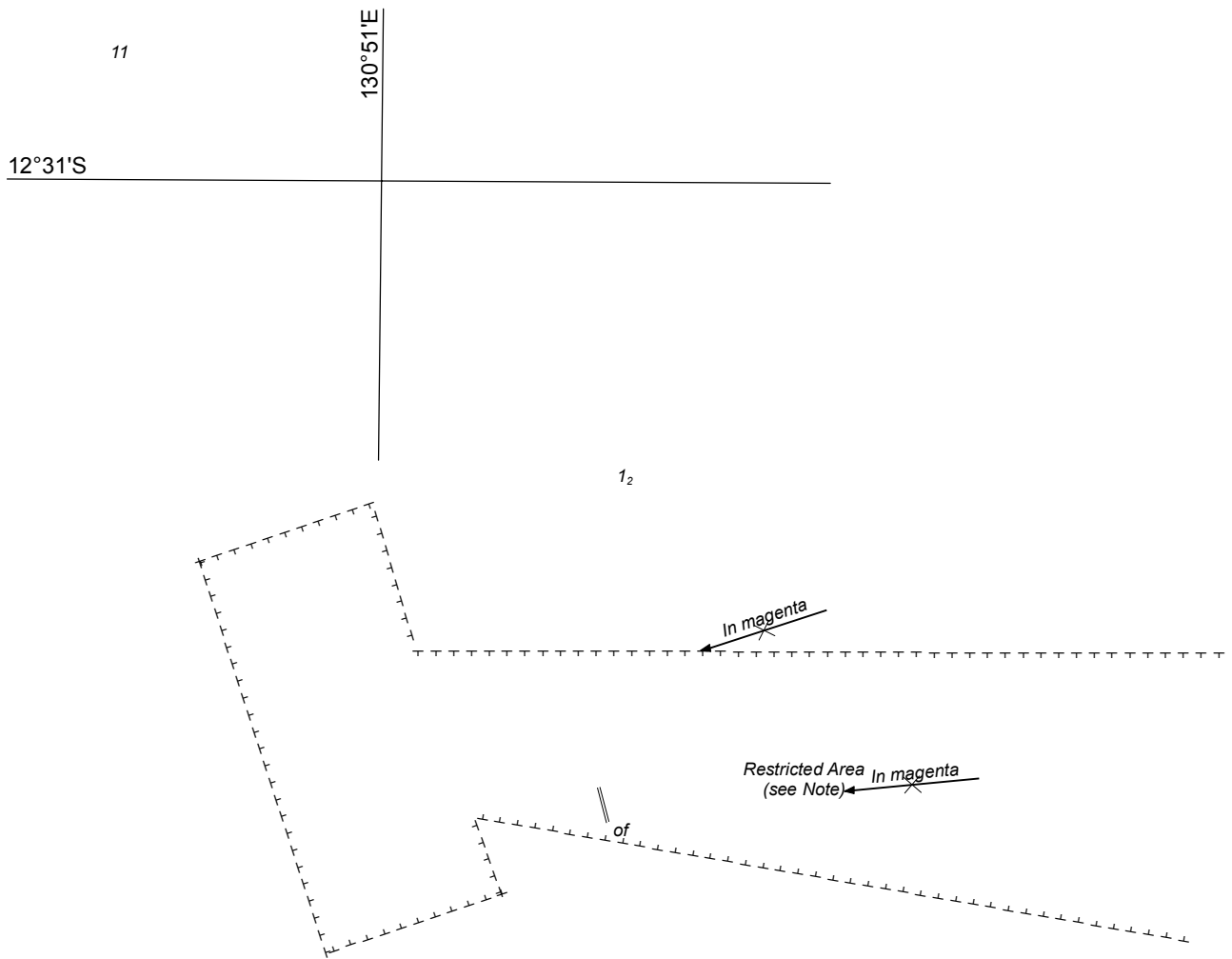

INSERT
NOTE

130°50'E

Channel
Island

12°35'S

Previous Notice 317/2018

NTM 347, 348/2018



AUS 27

© Commonwealth of Australia 2018

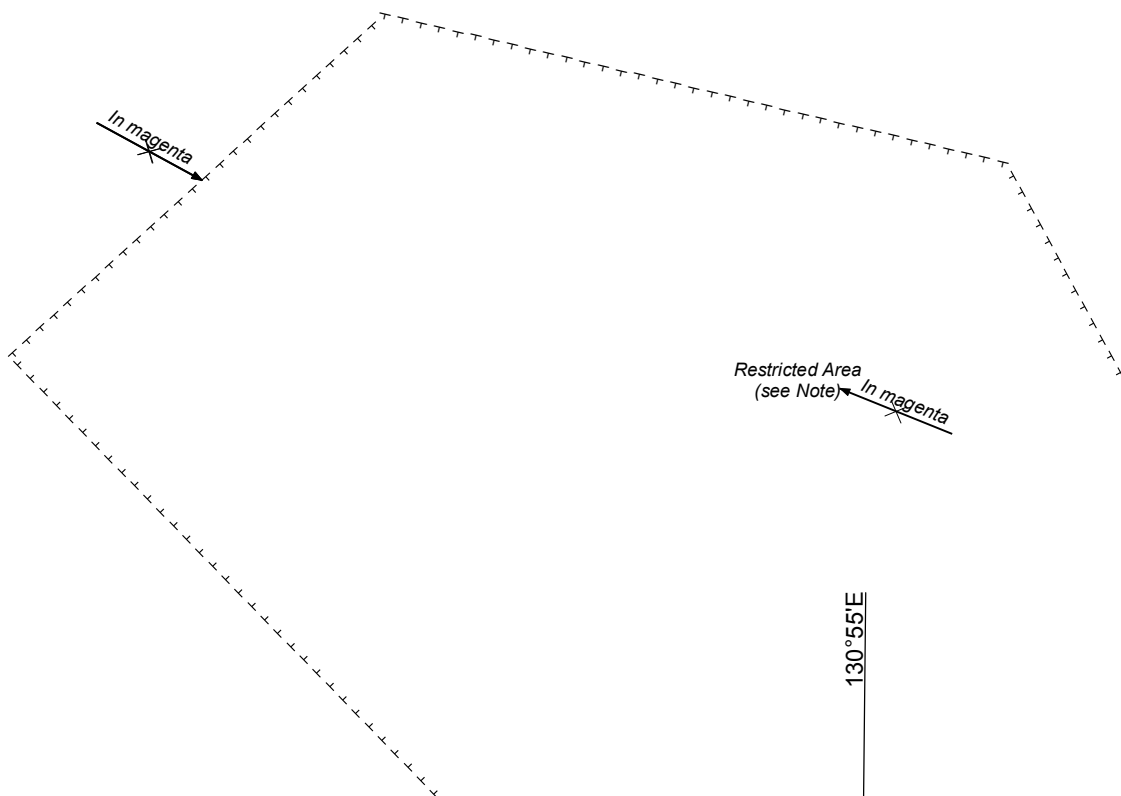
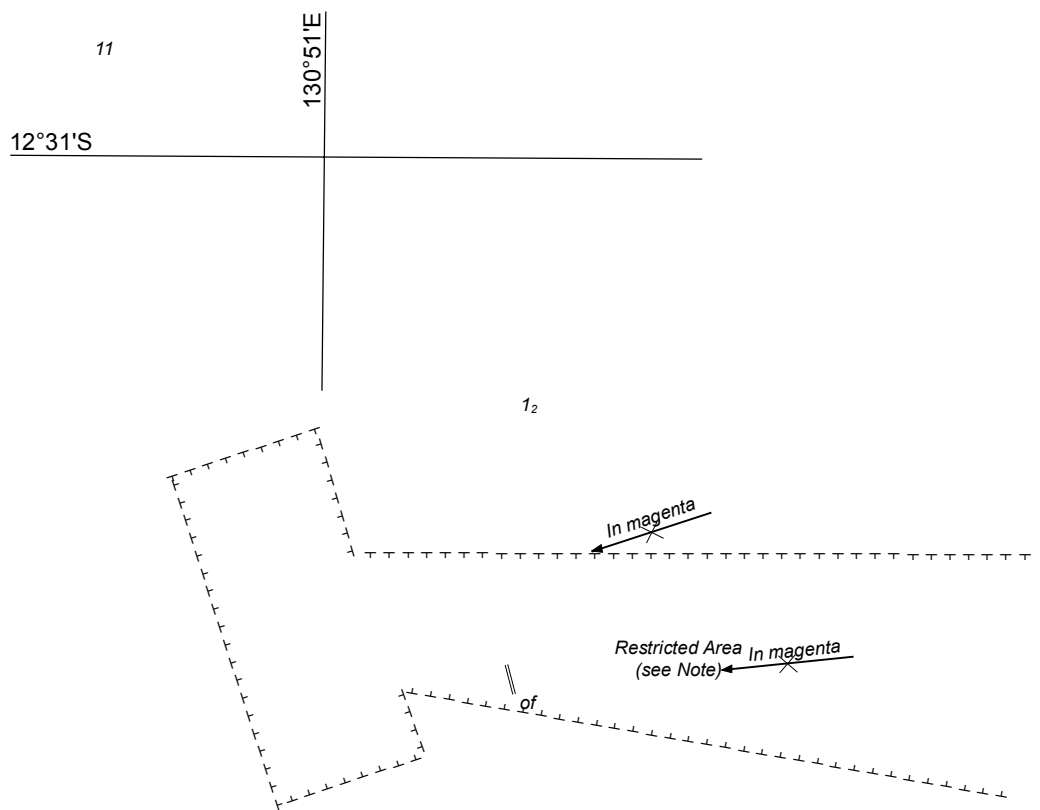

21



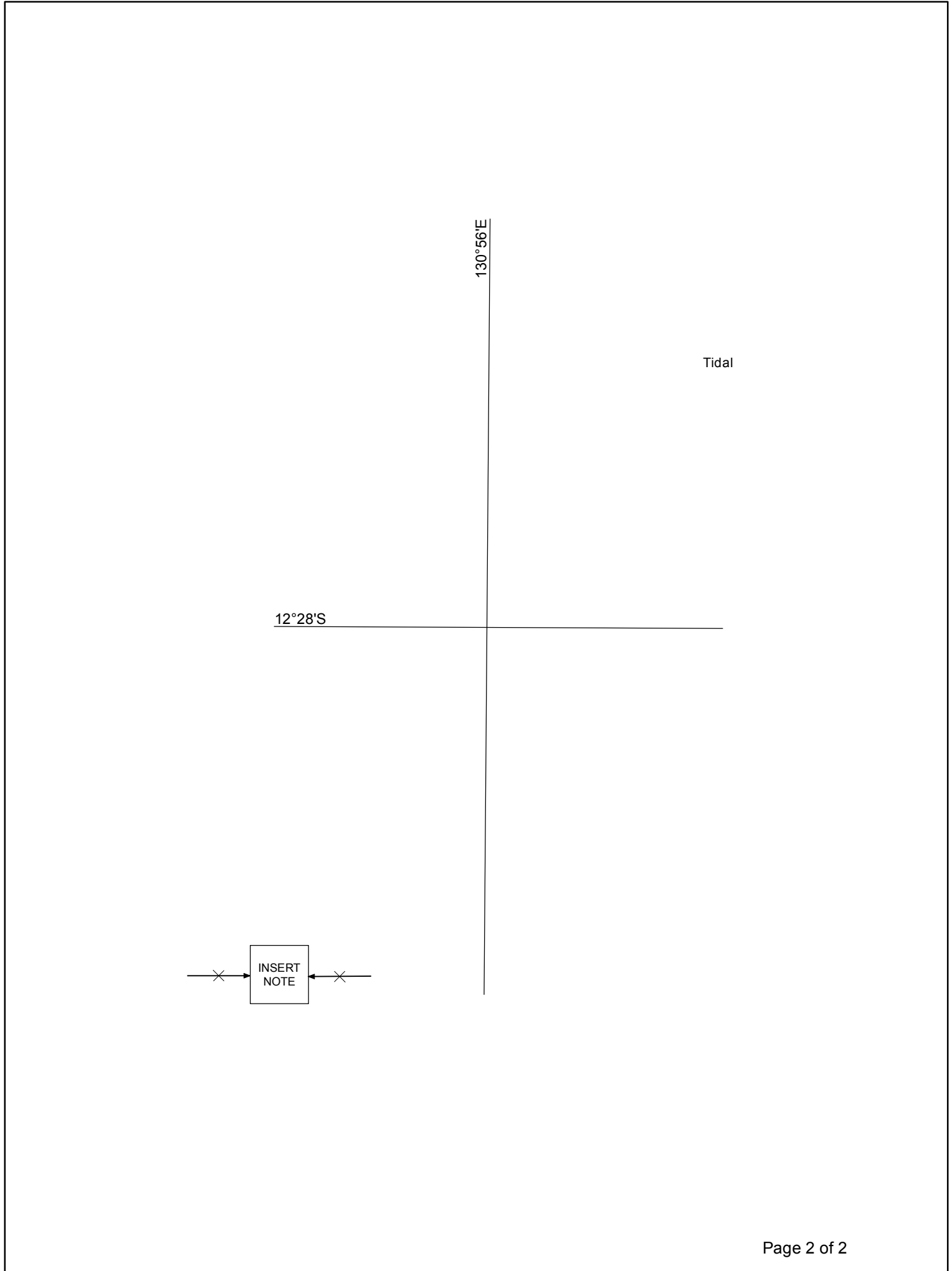

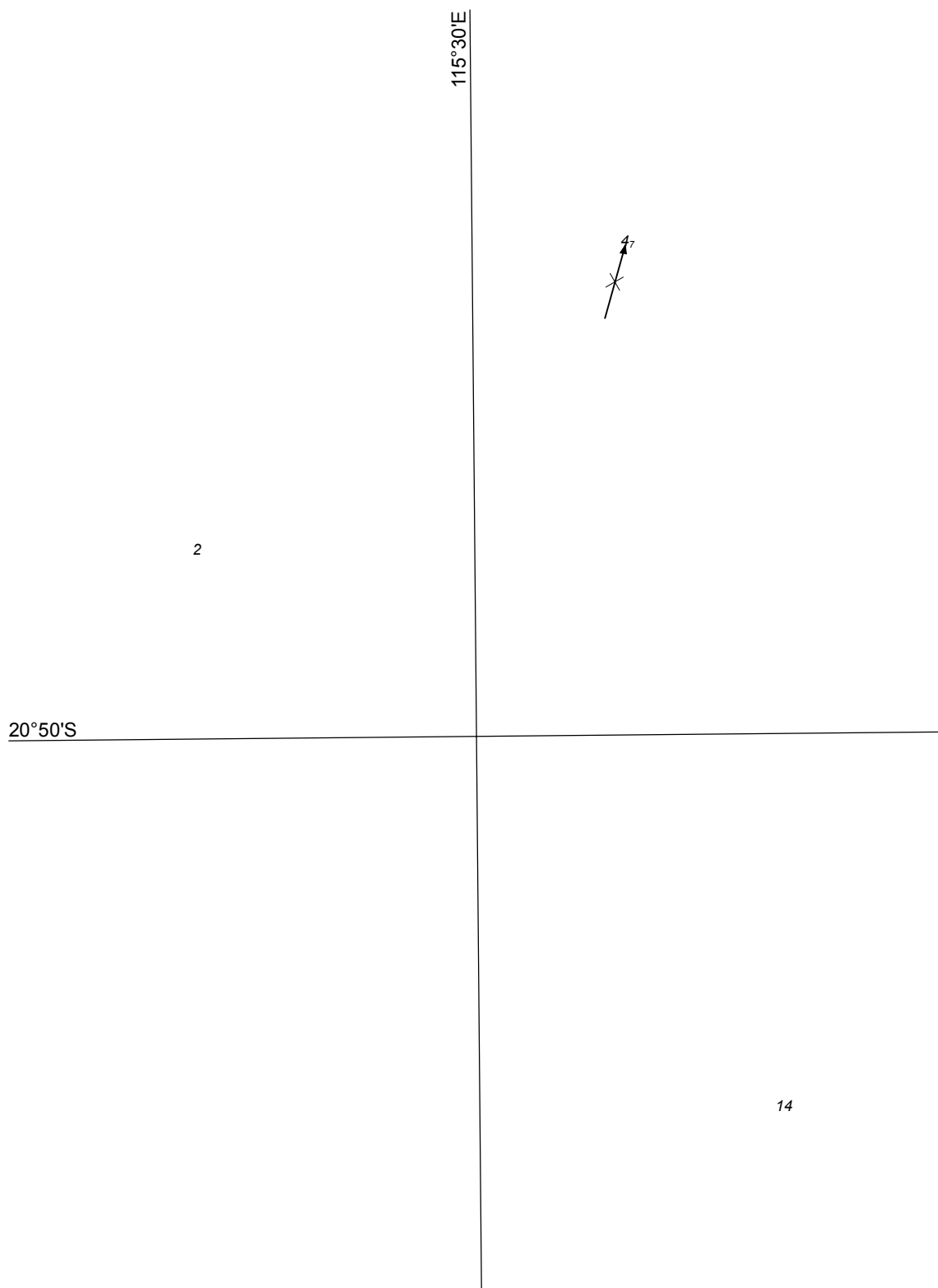

20°48'S

115°31'E

10₈



7₉

Previous Notice 318/2018

NTM 349/2018



AUS 66

© Commonwealth of Australia 2018

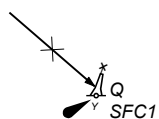
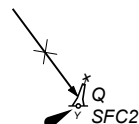

115°43'E

16₄

32°04'S

11₈



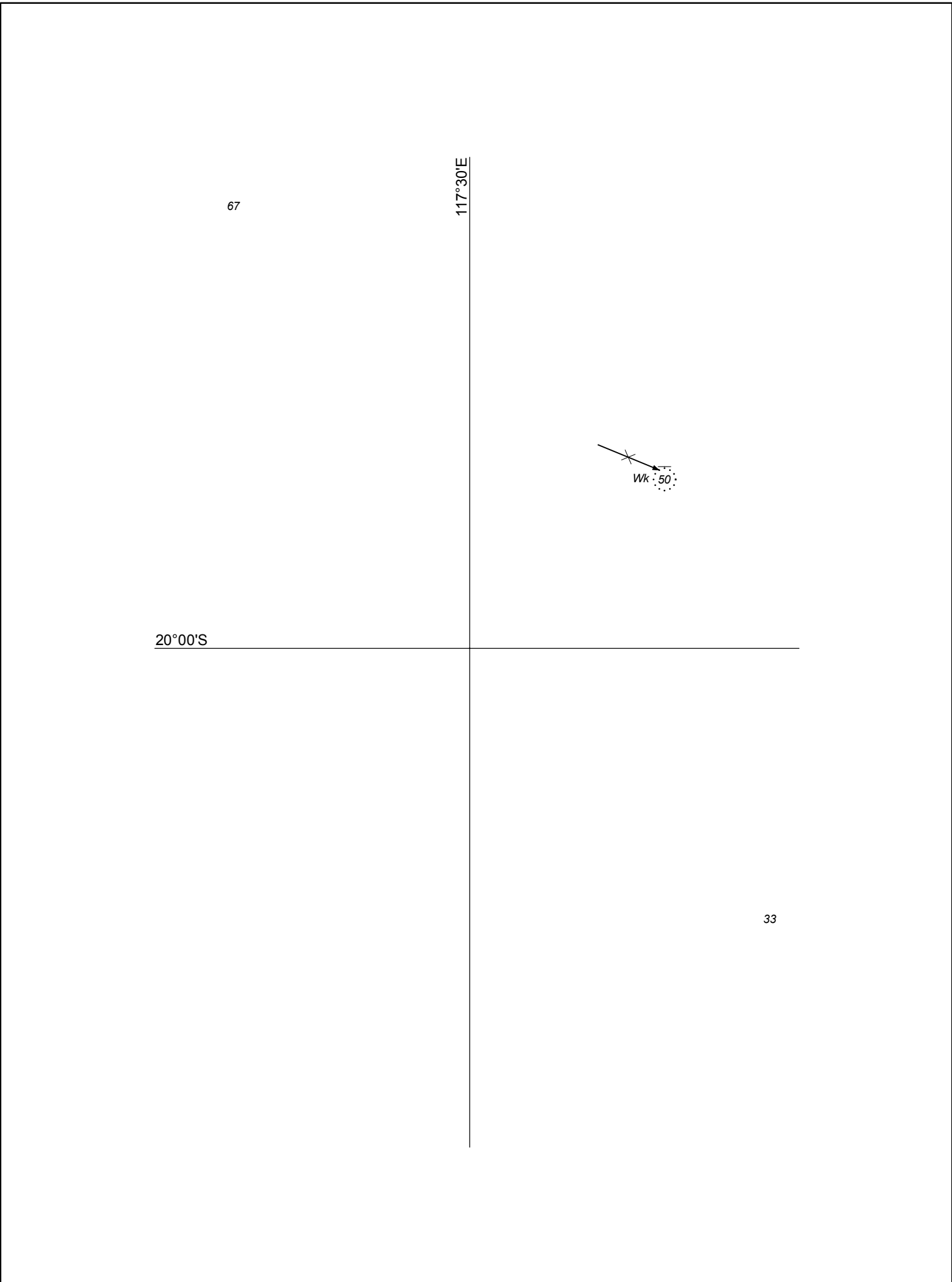

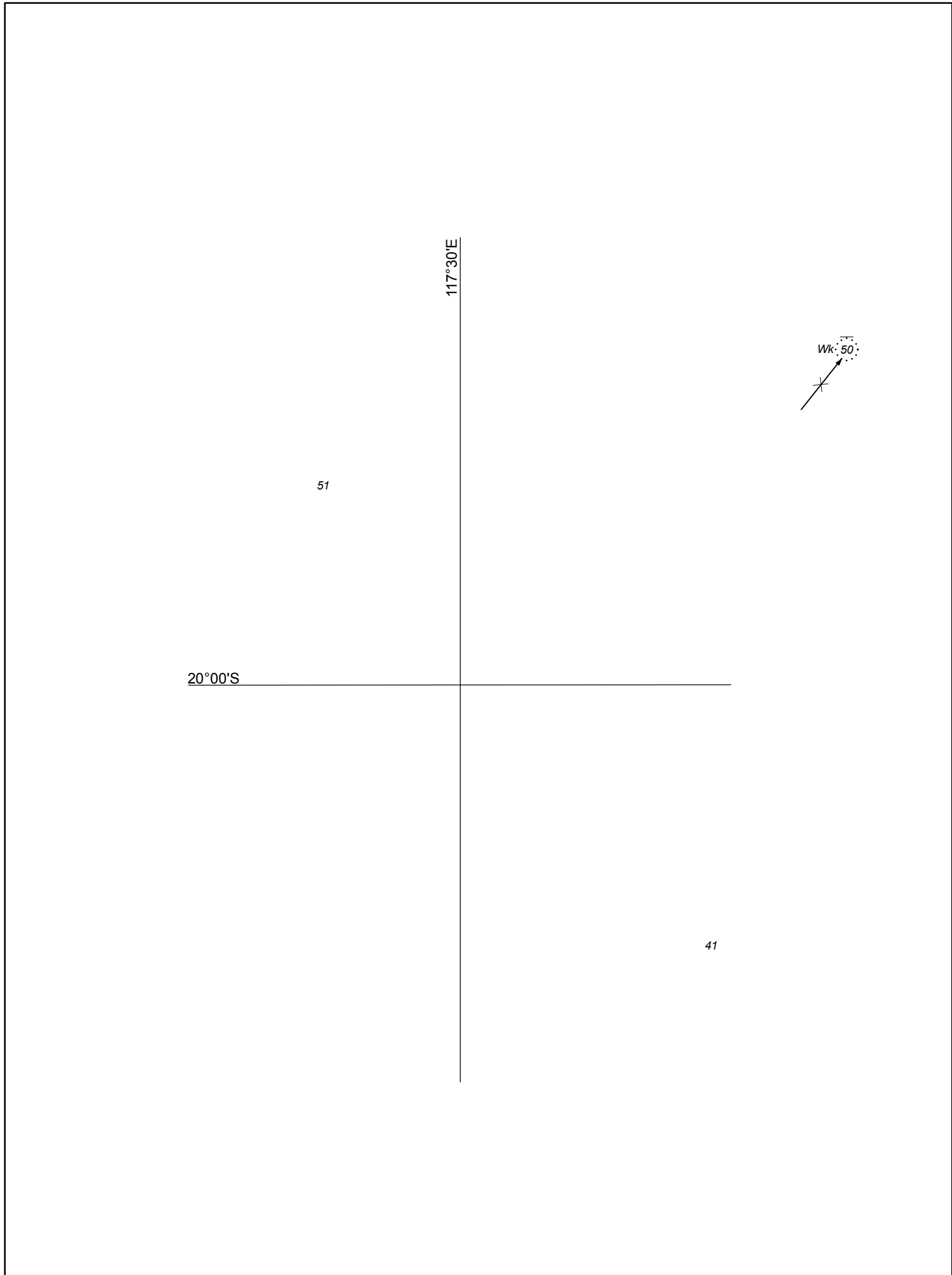

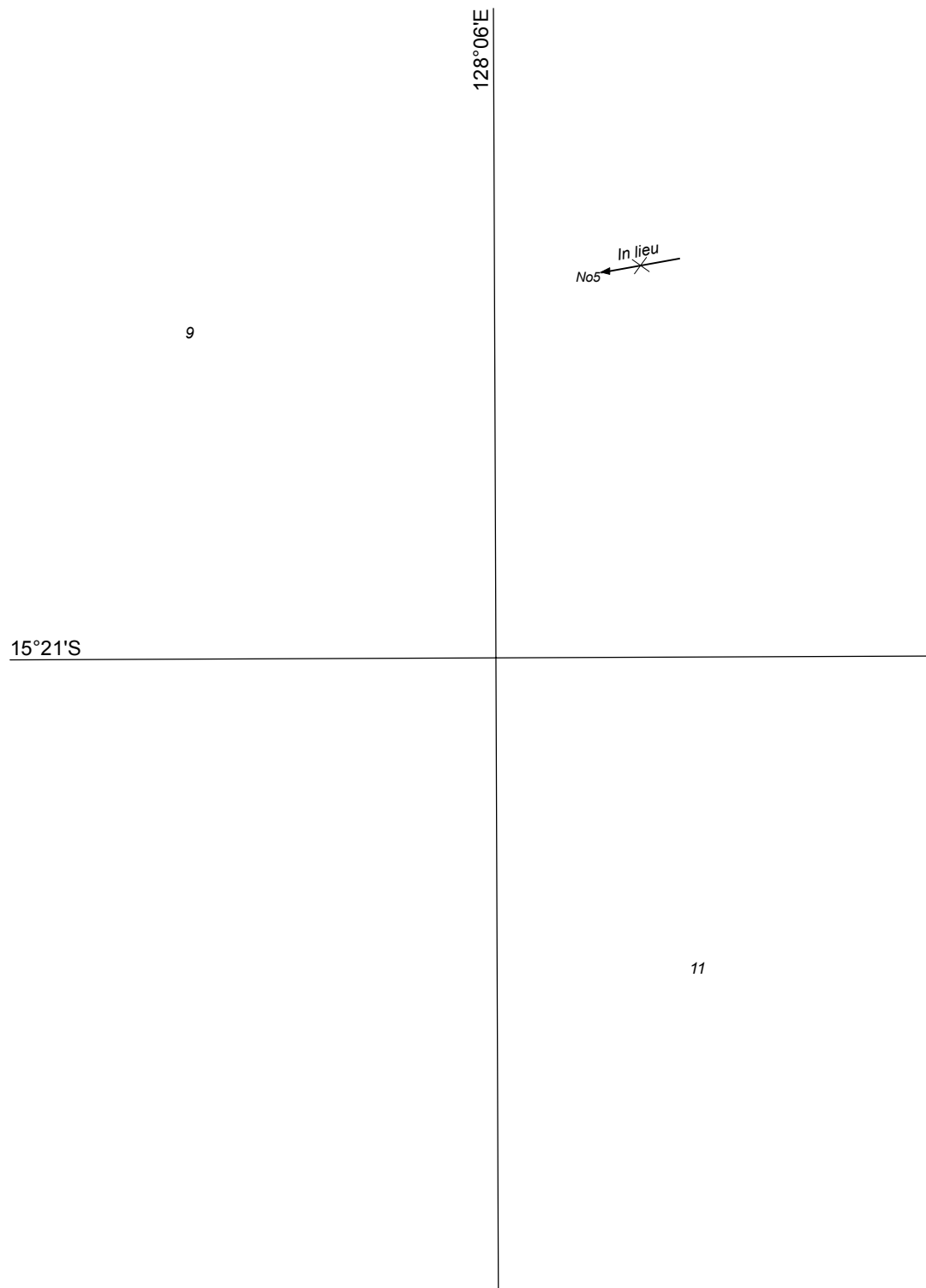

PLAN: APPROACHES TO WYNDHAM WHARF

Previous Notice 245/2018

NTM 352/2018



AUS 32

© Commonwealth of Australia 2018

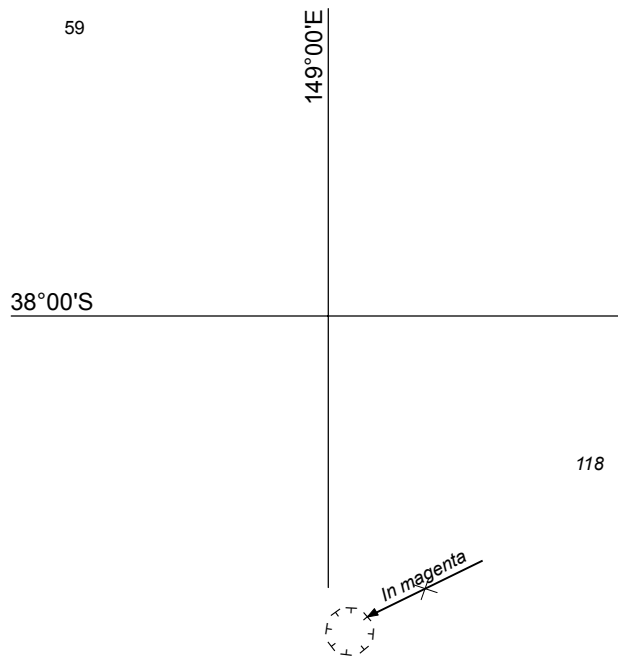

In ijeu
FI(2) 10s
BRB

144° 45'E

1

38° 20'S

2₄

PLAN: SORRENTO

Previous Notice 105/2018

NTM 354/2018



Australian Government
Department of Defence

AUS 143

© Commonwealth of Australia 2018

